

FILED

GOVERNMENT CORNER RESTORATION FORM

Date: 7-26-2005 By: JC

This survey consists of:

Township 26 S Range 7 W Sec. 17 County DOUGLAS Map: _____

State OR Date JULY 18, 2005 No. 240400 Narrative: _____
Corner Rpt: 67/10-36

Corner Designation

S $\frac{1}{4}$ SEC 17
SEC 20

DOUGLAS COUNTY SURVEYOR

- Condition Report Only
- Not Found
- Renewed
- Unrecorded
- Surveyed In
- Referenced Out

MONUMENT DETAIL

Previous Renewals V.R. TRACY 1966

Monument(s) Found: (Condition and Source)

2 1/2" DIA. DC50 BRASS CAP
1 1/4" IRON PIPE, PROJECTS 8"
OUT OF GROUND. B.C. DATED
1966

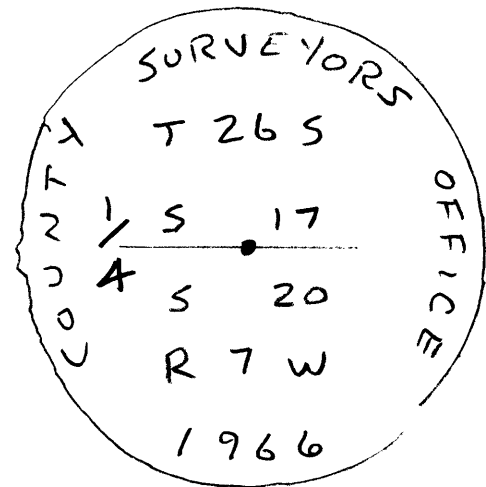

Accessories Found:

57" DIA X 5 FT. TALL ROTTING STUMP, CHOPPED OUT FACE
VISIBLE BARK HAS FALLEN OFF. BEARS S 23° W, 11 1/2 FT.
(REC. S 20° W 11 1/2 FT) REC. BRG. POINTS TO CHOPPED OUT FACE.
ORIG. BT

8" Now 13" x 3 1/2" TALL W. FIR STUMP. EVIDENCE OF
DOUBLE BLAZE IS VISIBLE. ALUM. SHEET METAL IS
NAILED TO TOP OF STUMP. BEARS N 33° W, 29 1/2 FT.
(AGREES W/REC.) 1966 BT.

15" Now 22" D. FIR, FULLY HEALED DOUBLE BLAZE VISIBLE
BEARS S 67° W, 27 1/2 FT. (AGREES W/REC.) 1966 BT

