

FILED

GOVERNMENT CORNER RESTORATION FORM

Date: 5/17/2005 By: zc

Township 325 Range 6W Sec. 35

County DOUGLAS

This survey consists of:

State OR

Date 4-20-05

No. 038040

Corner for 67/10-21

Corner Designation

SE COR. REDFIELD  
DLC 38

DOUGLAS COUNTY  
SURVEYOR

- Condition Report Only
- Not Found
- Renewed
- Unrecorded
- Surveyed In
- Referenced Out

Previous Renewals BBI, DEC. 1953

Monument(s) Found: (Condition and Source)

1" PIPE CALLED FOR IN  
1953 RENEWAL NOT FOUND  
POSITION FALLS IN WIDE MEDIAN  
OF INTERSTATE 5 NEAR GLENDALE  
INTERCHANGE

Accessories Found:

- 5/8" I. ROD W/ 4x4 POST ALONGSIDE. POST IS MARKED  
" SHRW POC 455+97.75. IRON ROD IS SMOOTH  
AND PROJECTS ABOVE GROUND 4".
- THE OTHER R/W MONUMENT (POC 452+64.36) CALLED  
OUT IN THE 1953 RENEWAL WAS SEARCHED FOR  
AND NOT FOUND. POSITION FALLS IN LARGE FILL BANK  
FOR I-5 SOUTHBOUND LANES.

C.S. File No 67/10-21

RENEWAL

Monument Detail

Monument Set (Procedure and Description)

FOUND 5/8" I. ROD WILL NOW  
 BECOME THE REFERENCE MONUMENT  
 TO SE COR. DLC 38

DLC CORNER PLR 1953 BBI RENEWAL  
 BEARS S 89° 14' 30" E 263.0 FT  
 FROM FOUND 5/8" I.R.

DIA  
New Accessories

- 9" MADRONE, DOUBLE BLAZED & SCRIBED "RMCSBT"  
BEARS S 1 1/2° E, 11.2 FT.
- 8" DIA. GRAND FIR, DOUBLE BLAZED & SCRIBED "RMCSBT"  
BEARS S 65° E, 22.4 FT.
- 23" DIA. D. FIR, DOUBLE BLAZED & SCRIBED "RMCSBT"  
BEARS N 81° E, 9.6 FT.
- 11" DIA. MADRONE, DOUBLE BLAZED & SCRIBED "RMCSBT" BEARS S 83 3/4° W, 28.5 FT.

Sketch of Monument, Accessories, and General Area

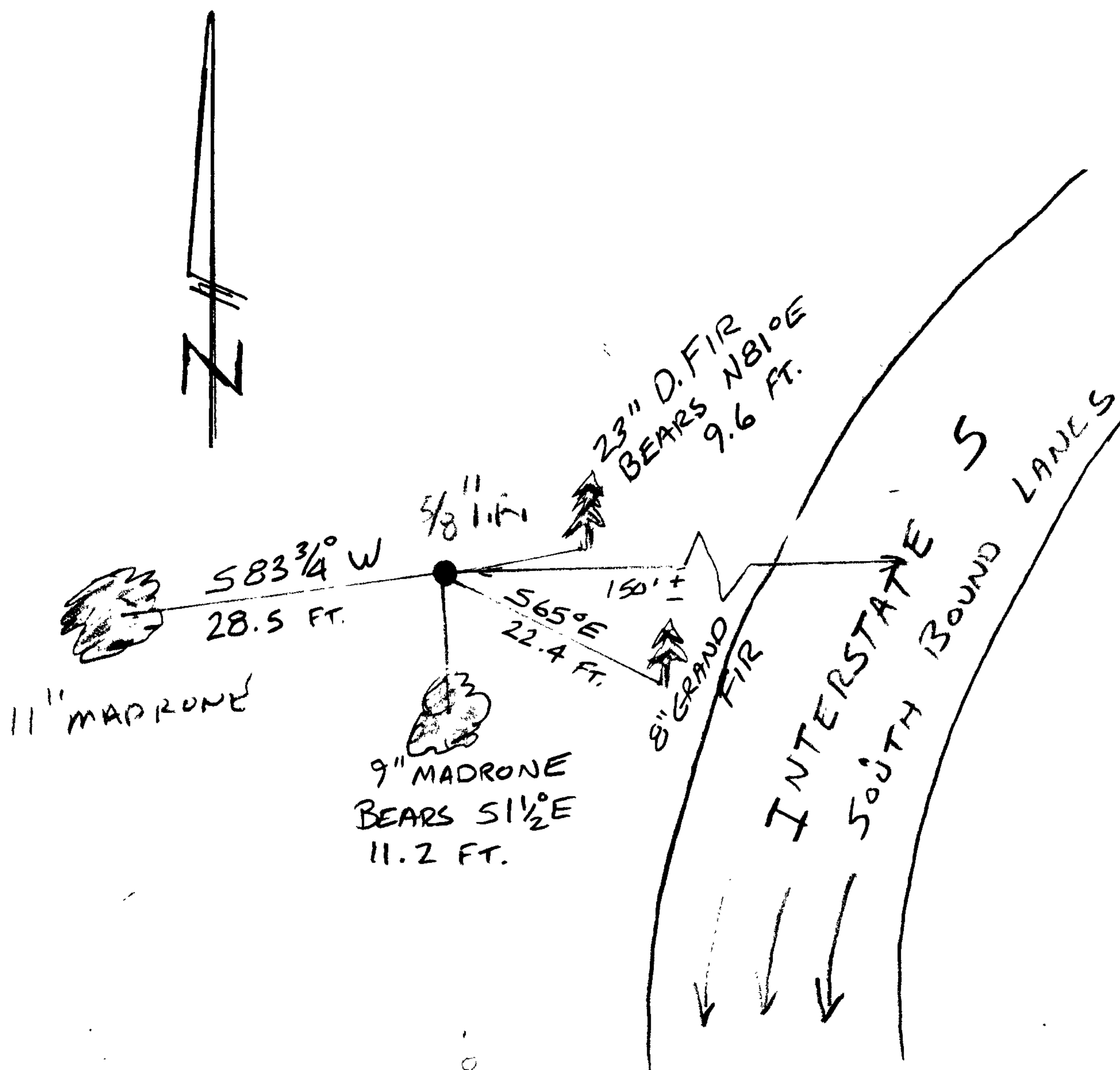

Location & Comments

CORNER LIES ON NORTH FACING  
 SLOPE, ON WEST SIDE OF  
 INTERSTATE 5 SOUTH WEST OF  
 GLENDALE INTERCHANGE AND  
 APPROX. 150 FT. WEST OF SOUTH-  
 BOUND I-5 LANES

Comp. Declin. 16 3/4° E  
 Agency D.C.S.O.  
 Party Chief S. FLAUSE  
 Notekeeper J. PIKE  
 Witnesses

Address

Surveyor's Seal

REGISTERED  
 PROFESSIONAL  
 LAND SURVEYOR

*Randall W. Smith*  
 6-30-2006

OREGON  
 JULY 25, 1993  
 RANDALL W. SMITH  
 2400