

FILED

GOVERNMENT CORNER RESTORATION FORM

Date: 3/28/05 By: 2c

Township 30 S Range 5 W Sec. 19

County DOUGLAS

This survey consists of:

State OR Date 3-3-05

No. 100300

Map: _____
Name: _____
Corner Rpt: 67/10-15

Corner Designation SW COR. SEC. 19

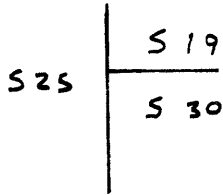

DOUGLAS COUNTY SURVEYOR

- Condition Report Only
- Not Found
- Renewed
- Unrecorded
- Surveyed In
- Referenced Out

Previous Renewals _____

MONUMENT DETAIL

Monument(s) Found: (Condition and Source)

1993 D.C.S.O. BC/IP 12"
BELOW GROUND

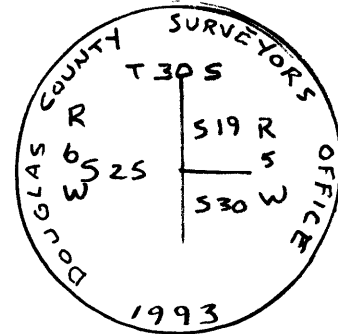

Accessories Found:

28" PINE NOW 34", FULLY HEALED DOUBLE BLAZE VISIBLE
BEARS N 89 3/4° E, 35.9 FT. (REC. S 88 1/2° E 35.9 FT.) (1993)
TREE TO BE REMOVED.

26" PINE NOW 32", STANDING DEAD, FULLY HEALED DOUBLE BLAZE VISIBLE
BEARS S 2 1/2° E, 113.7 FT. (REC. S 1 1/4° E, 113.7 FT.) (1993)
TREE TO BE REMOVED.

BC/IP AT CORNER FOR SECTIONS 24 & 25, T 30-6 BEARS N 3/4° W 106.8 FT.
(REC. NORTH 106.8 FT.) (1993)

C.S. File No 67/10-15

