

FILED

GOVERNMENT CORNER RESTORATION FORM

Date: 3-28-2005 By: JC

Township 26 S Range 3 W Sec. 19

County Douglas

This survey consists of:

State OR

Date 3-16-05

No. 100300

Corner Rpt: 67/10-14

Corner Designation

T 26 S

R	S 24	S 19	R
4			3
W	S 25	S 30	W

DOUGLAS COUNTY SURVEYOR

- Condition Report Only
- Not Found
- Renewed
- Unrecorded
- Surveyed In
- Referenced Out

MONUMENT DETAIL

Previous Renewals DCSO 1916; DCSO 1959; DCSO 1966

Monument(s) Found: (Condition and Source)

2 1/2" BC ON 1 1/4" O.D. IRON PIPE PROJECTING 10" ABOVE GROUND.

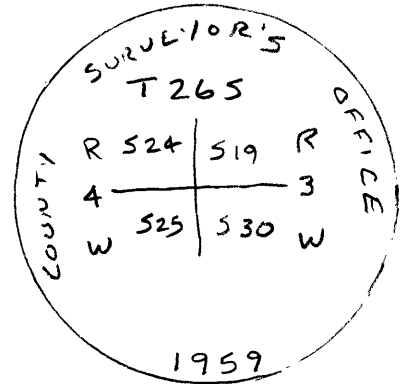

Accessories Found:

- 5" D. FIR NOW 31" HEALED BLAZE BARELY VISIBLE BEARS S 11 1/2° W, 21.4 FT. (REG. S 8° W, 21.4 FT.) (1966 BT)
- 3" LAUREL NOW 14" HEALED BLAZE VISIBLE BEARS N 42° E, 37.0 FT. (AGREES W/REG.) (1959 BT)
- 16" LAUREL NOW 23" STANDING DEAD, HEALED BLAZE VISIBLE BEARS N 4° W 221.4 FT. (REG. N 4° W, 223.0 FT.) (1959 BT)
- 12" R. FIR NOW BURNT ROTTED STUMP BEARS S 68° E, 125.8 FT. (AGREES W/RECORD) (1959 BT)

C.S. File No 67/10-14

