

FILED

GOVERNMENT CORNER RESTORATION FORM

Date: 3-28-05 By: [Signature]

This survey consists of:

Township 30 S Range 6 W Sec. 24 County DOUGLAS

State OR Date 3/3/05 No. 700300

Narrative: _____
Corner Rpt: 67/10-12

Corner Designation SE COR. SEC. 24

S 24		S 19
S 25		

DOUGLAS COUNTY SURVEYOR

- Condition Report Only
- Not Found
- Renewed
- Unrecorded
- Surveyed In
- Referenced Out

MONUMENT DETAIL

Previous Renewals DCSO 1969, DCSO 1993

Monument(s) Found: (Condition and Source)

1993 D.C.S.O. BC/IP 8" BELOW GROUND

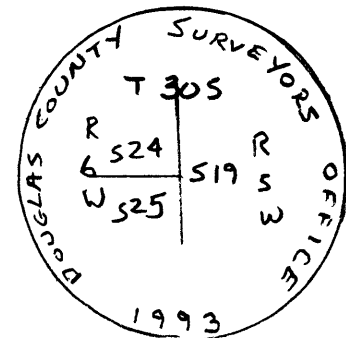

Accessories Found:

- 28" PINE NOW 36", FULLY HEALED DOUBLE BLAZE VISIBLE BEARS S 61 1/4° W, 38.8 FT. (REC. S 63° W, 38.8 FT.) (1993)
- BC/IP AT CORNER FOR SEC'S. 19 & 30 T. 30 S R 5 W BEARS S 3/4° E, 106.8 FT. (REC. SOUTH 106.8 FT) (1993)
- 5/8" I.R. TOP BENT S.WESTERLY APPROX 0.2 FT. 2" BELOW GROUND BEARS S 87° W, 15.55 FT. TO PLUMB POSITION. (REC 3/4" I.R.; WEST 15.0 FT.) (1969 & 1993)
- 1/2" I.R. 2" BELOW GROUND BEARS S 87° W, 20.0 FT. (REC 3/4" I.R.; WEST 20.0 FT.) (1969 & 1993)
- 26" PINE NOW 30" FULLY HEALED DOUBLE BLAZE VISIBLE BEARS N 21 1/4° W, 149.5 FT. (REC. N 19° W, 149.5 FT.) (1993)

NOTE: THE 2 FOUND PINE TREES ARE TO BE REMOVED.

C.S. File No 67/10-12

