

GOVERNMENT CORNER RESTORATION FORM

FILED

Township 25 S Range 4 W Sec. 8 <sup>SE COR</sup> County DOUGLAS Date: 2-14-2005 By: JC  
 State OR Date 11-3-04 No. 300500 This survey consists of:  
 Map: \_\_\_\_\_ Narrative: \_\_\_\_\_  
 Corner Rpt: 67/10-3

Corner Designation

8 | 9  
 ---  
 17 | 16

DOUGLAS COUNTY SURVEYOR Only

- Condition Found
- Not Found
- Renewed
- Unrecorded
- Surveyed In
- Referenced Out

MONUMENT DETAIL

Previous Renewals BBI 1939; BLM 1957

Monument(s) Found: (Condition and Source)

- A 3 1/4 INCH DIAM. BLM BRASS CAP MARKED AS AT RIGHT ON 2 INCH I.D. 29 INCH LONG IRON PIPE ON SURFACE OF GROUND.
- 1 1/4" O.D. IRON PIPE PROTRUDING 18" ABOVE GROUND. TOP LEANS N. EASTWARD APPROX 12" FROM PLUMB POSITION (1939 BBI)

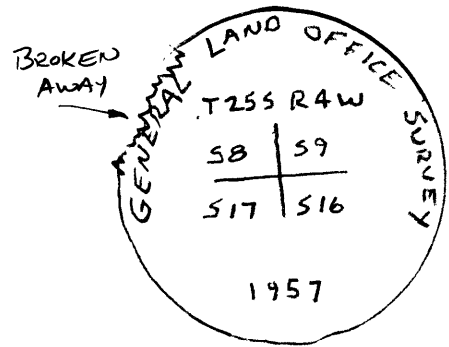

Accessories Found:

- 7" Now 20" DIA X 14" TALL D. FIR STUMP, HEALED BLAZE VIS. BEARS N 57° E; 33 FT. REC. N 55 1/4° E, 33 FT. (1957 BLM)
- ROTTED REMNANTS INDETERMINABLE SIZE D. FIR STUMP BEARS S 60° E; 37.6 FT. (O.B.T. AGREES W/REC.)
- 6" Now 19" DIA. X 12" TALL D. FIR HEALED BLAZE VIS. BEARS S 67 3/4° W; 25 FT. AGREES W/REC (1957 BLM)
- 24" Now 32" X 24" TALL D. FIR STUMP PARTIALLY BURNED BEARS S 21 1/2° W, 107 1/2 FT. REC. S 18° W, 107 1/2 FT (BBI 1939)

ACCESSORY BEARING AND DISTANCES MEASURED FROM BC/1P POSITION RELATIVE TO PLUMB POSITION OF ABOVE FOUND 1 1/4" O.D. IRON PIPE AS DESCRIBED IN 1957 BLM RENEWAL.

C.S. File No 67/10-3

RENEWAL

Monument Set (Procedure and Description)

Monument Detail

DETERMINED POSITION FROM 1/4" I.P.  
 SET B.C./I.P. S 58° E 2.64 FT.  
 FROM SAID I.P. AS PER 1957 BLM REC.

INTERSECTING DISTANCES FROM 1957  
 NE & SW FIR RENEWAL TREES  
 AGREE WELL WITH THIS POSITION.

CAP IS RESET PROTRUDING 6 INCHES ABOVE GROUND  
 WITH THE ADDED STAMPING "RESET 2004" AS AT NIGHT

GENERAL LAND OFFICE SURVEY  
 T255 R4W  
 58 | 59  
 516 | 517  
 RESET  
 2004  
 1957

New Accessories

- B.O. # 1 - BOAT SPIKE SET IN CENTER OF 20" DIA. X 14" TALL STUMP  
 BEARS N 57° E ; 332 FT. STAMPED B.O. 1 (1957 BLM)
- B.O. # 2 - 50 PENNY SPIKE SET IN CENTER OF 18" DIA. X 12" TALL  
 D. FIR STUMP BEARS S 12 1/2° E ; 15 3/4 STAMPED B.O. 2
- B.O. # 3 - BOAT SPIKE SET IN CENTER OF 19" DIA. BY 12" TALL D. FIR STUMP (1957  
 BLM)  
 BEARS S 67 3/4° W, 25.4 FT.

Sketch of Monument, Accessories, and General Area

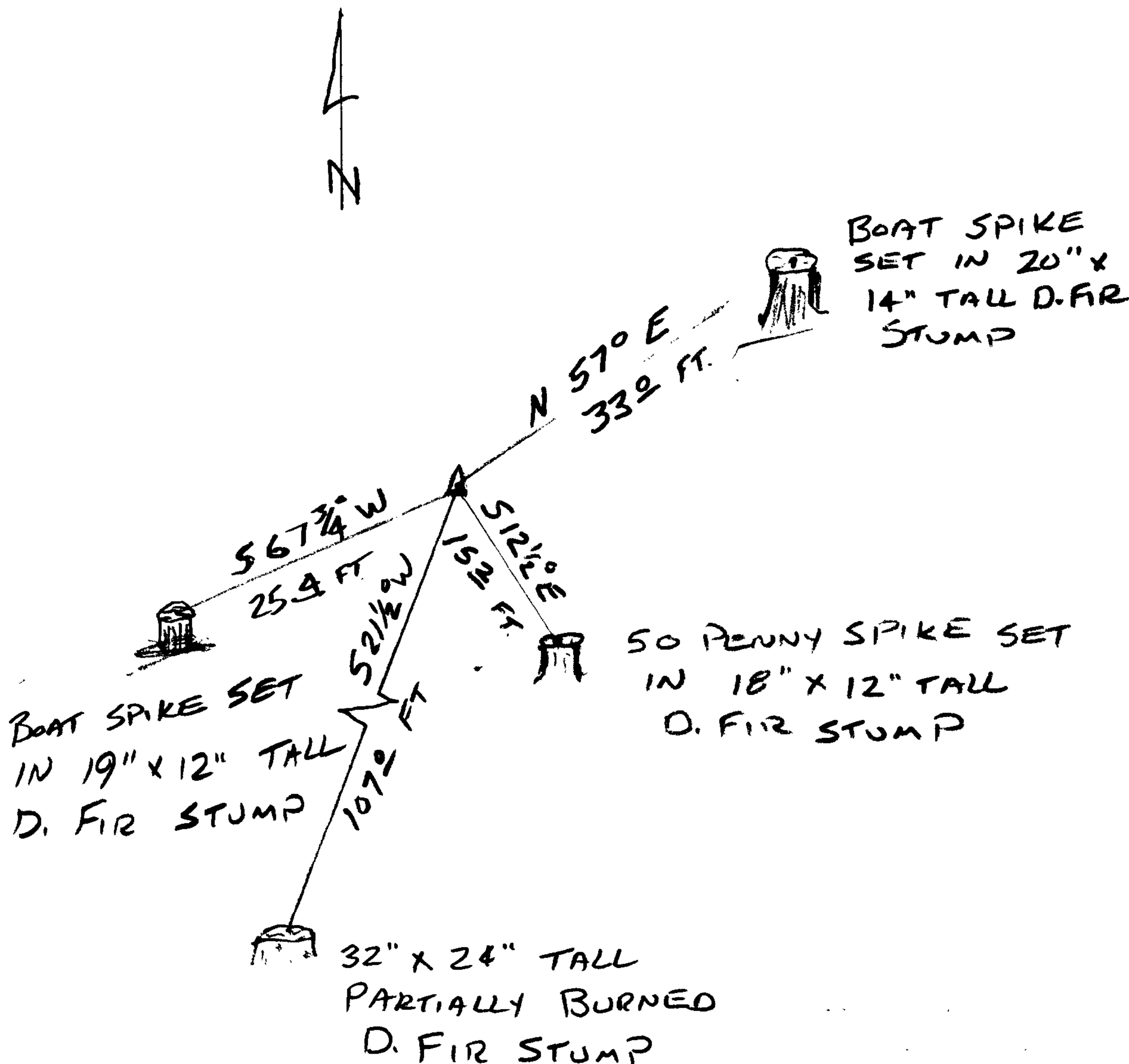

Location & Comments

CORNER LIES ON NORTHERLY  
 SLOPE THAT WAS RECENTLY  
 CLEARCUT. NO NEW TREES  
 WERE SCRIBED.

COB3009A

Comp. Declin. 17 1/2° E  
 Agency D.C.S.O.  
 Party Chief S. FLAUSE  
 Notekeeper J. PIKE  
 Witnesses

Address

Surveyor's Seal  
 REGISTERED  
 PROFESSIONAL  
 LAND SURVEYOR

*Randall W. Smith*  
 EXPIRES 6-30-2006

OREGON  
 JULY 25, 1980  
 RANDALL W. SMITH  
 2489