

FILED

GOVERNMENT CORNER RESTORATION FORM

Date: 2/14/2005 By: JC

This survey consists of:

Township 27 S Range 7 W Sec. 4 County DOUGLAS Msp: _____

State OR Date 4/8/2004 No. 340660 Narrative: _____

Corner Rpt: 67/10-1

Corner Designation

CENTER NORTH 1/16

DOUGLAS COUNTY SURVEYOR

Condition Report Only

Not Found

Renewed

Unrecorded

Surveyed In

Referenced Out

MONUMENT DETAIL

M 39-16

Previous Renewals SET BY J. BYRON, JULY 1970

Monument(s) Found: (Condition and Source)

BRASS CAP NOT FOUND.

Accessories Found:

- 7" NOW 12" LAUREL BEARS N 67 1/2° E 23.5 FT. HEALED BLAZE VISIBLE (AGREES WITH RECORD)

- 10" NOW 19" DOUBLE TRUNK LAUREL, HEALED BLAZE VISIBLE ON MOST EASTERLY TRUNK, BEARS N 35 1/2° W, 70.5 FT. TO CENTER OF ROOT CROWN, (REC. N 35 1/2° W, 66.8 FT. TO EASTERLY TRUNK AT BREAST HEIGHT)

C.S. File No 67/10-1

RENEWAL

Monument Detail

Monument Set (Procedure and Description)

SET 5/8" X 60" IRON ROD WITH
 1/2" ALUM. CAP MKD. "DOUGLAS
 CO. SURVEYOR C N 1/16 S 4"
 FROM EXISTING BEARING TREES.
 PROTRUDES 2" ABOVE GROUND

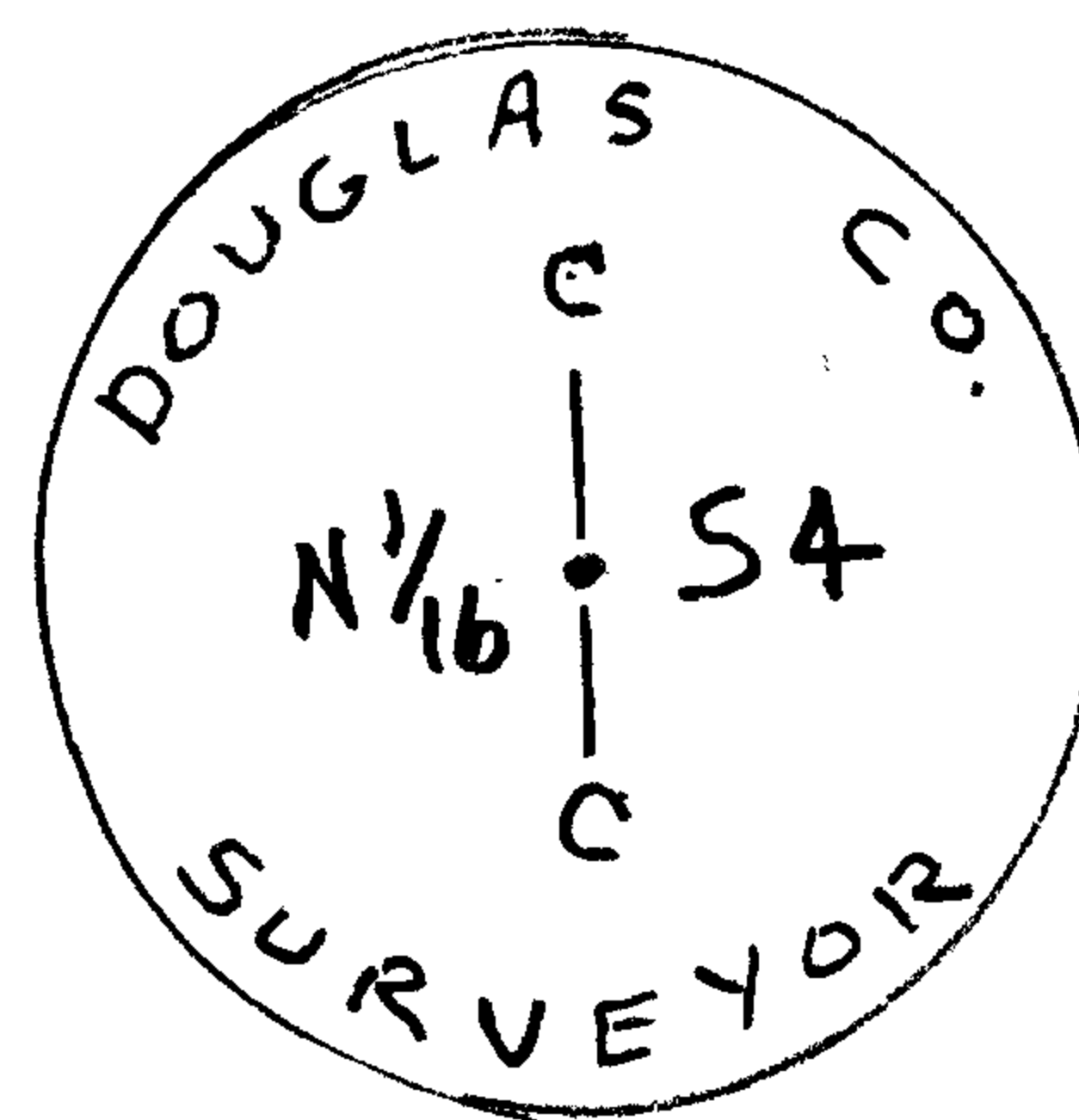

New Accessories

2" I.D. IRON PIPE NEAR 4 WAY FENCE CORNER (SEE SKETCH)
 BEARS S 82 1/2° E 31.6 FT. PIPE PROTRUDES 10" AND
 LEANS APPROX. 0.4 FT. SOUTHERLY. THIS IS AN APPARENT "LOCAL
 CORNER" WITH NO PREVIOUS RECORD UNTIL G. LANG TIED IT
 ON SURVEY M145-8013.

Sketch of Monument, Accessories, and General Area

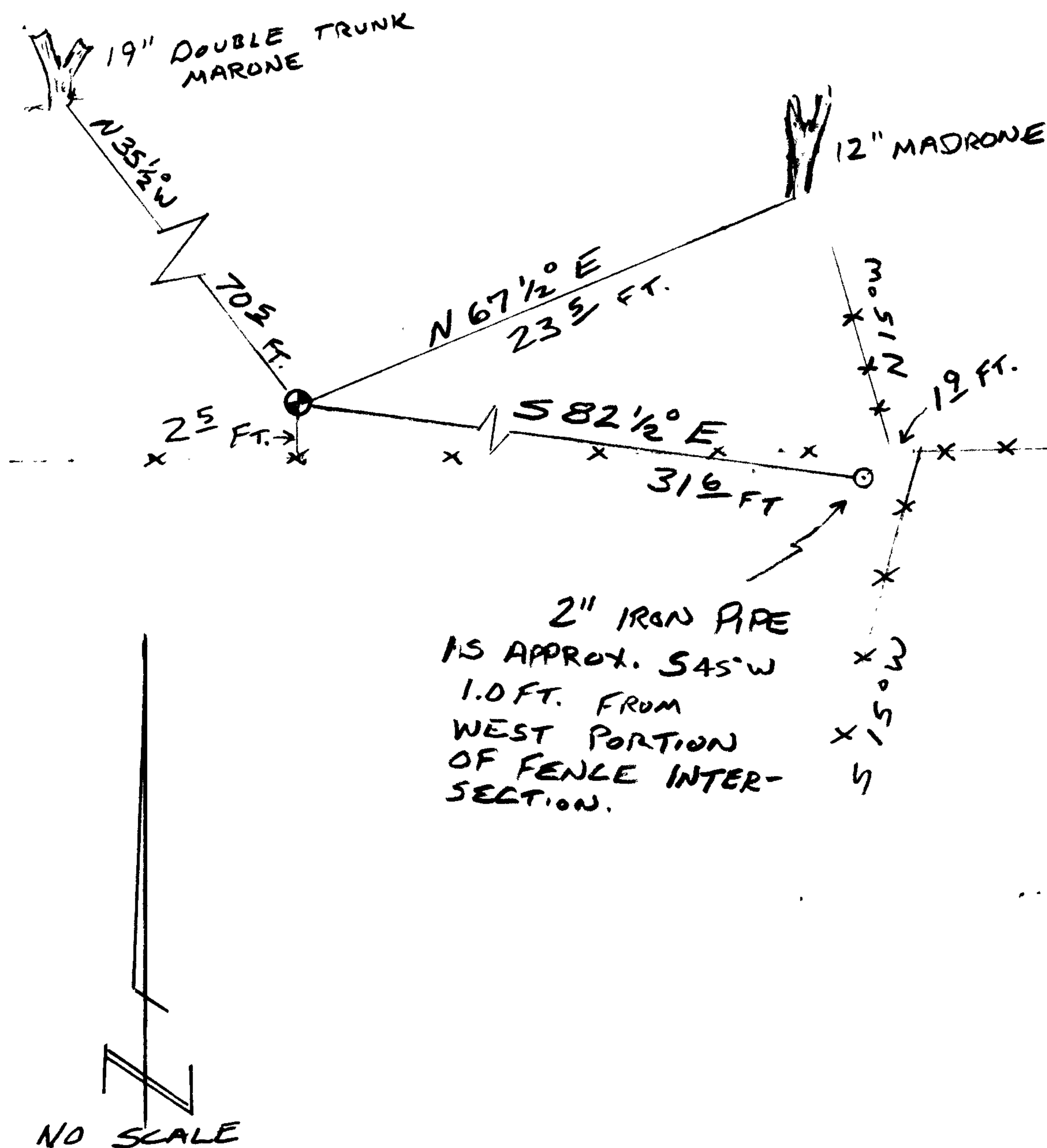

Location & Comments

LIES APPROX. 2.5 FT.
 NORTH OF EAST-WEST
 FENCE LINE.

Comp. Declin. 17 1/2° E
 Agency D.C.S.O.
 Party Chief S. FLAUSE
 Notekeeper J. PIKE
 Witnesses

C040812A

Address

Surveyor's Seal

REGISTERED
 PROFESSIONAL
 LAND SURVEYOR

Randall W. Smith
 EXPIRES 6-30-06

OREGON
 JULY 25, 1990
 RANDALL W. SMITH
 2469