

RENEWAL

Monument Set (Procedure and Description)

SET 5/8" X 30" IRON ROD W/ALUM
CAP MARKED 'DOUGLAS CO. SURVEYOR
DLC 37 2004' 9" BELOW
SURFACE OF GRAVELLED ROAD.

Monument Detail

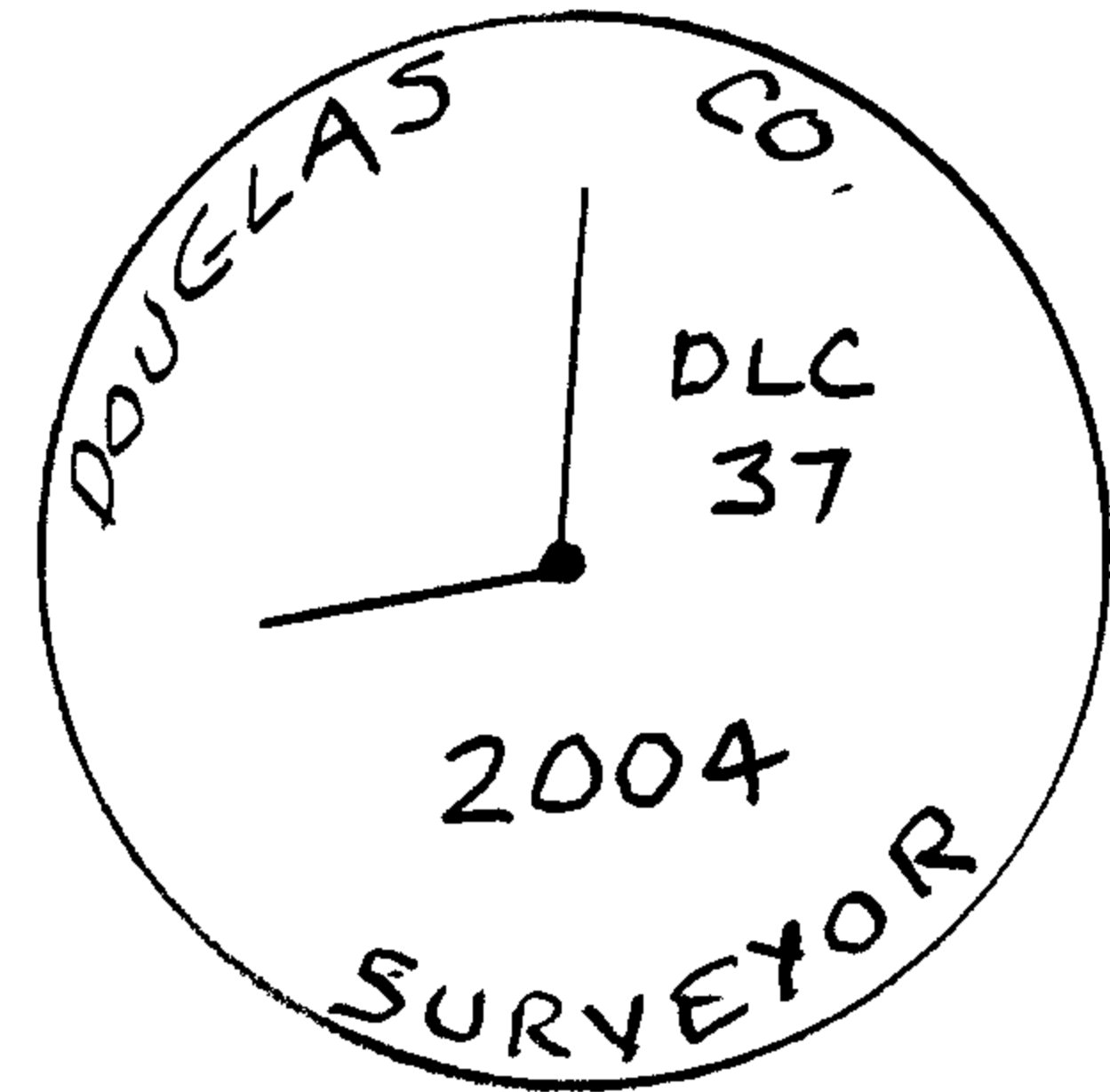

New Accessories

28" D. FIR BEARS S 72 1/2° W, 330 FT.
BARK SCRIBED 'INT NW DLC 37 CS BT'
18" ASH BEARS N 51° E, 74 1/2 FT. ILLEGIBLE SCRIBE VISIBLE
ON OPEN BLAZE
5/8" X 30" I.R. W/ALUM. CAP MKD. DOUGLAS CO. SURVEYOR BEARS S 8° W 11.11 FT.
5/8" X 30" I.R. W/ALUM CAP MKD. DOUGLAS CO. SURVEYOR DLC 38 2004 BEARS N 8° E
48.84 FT.

Sketch of Monument, Accessories, and General Area

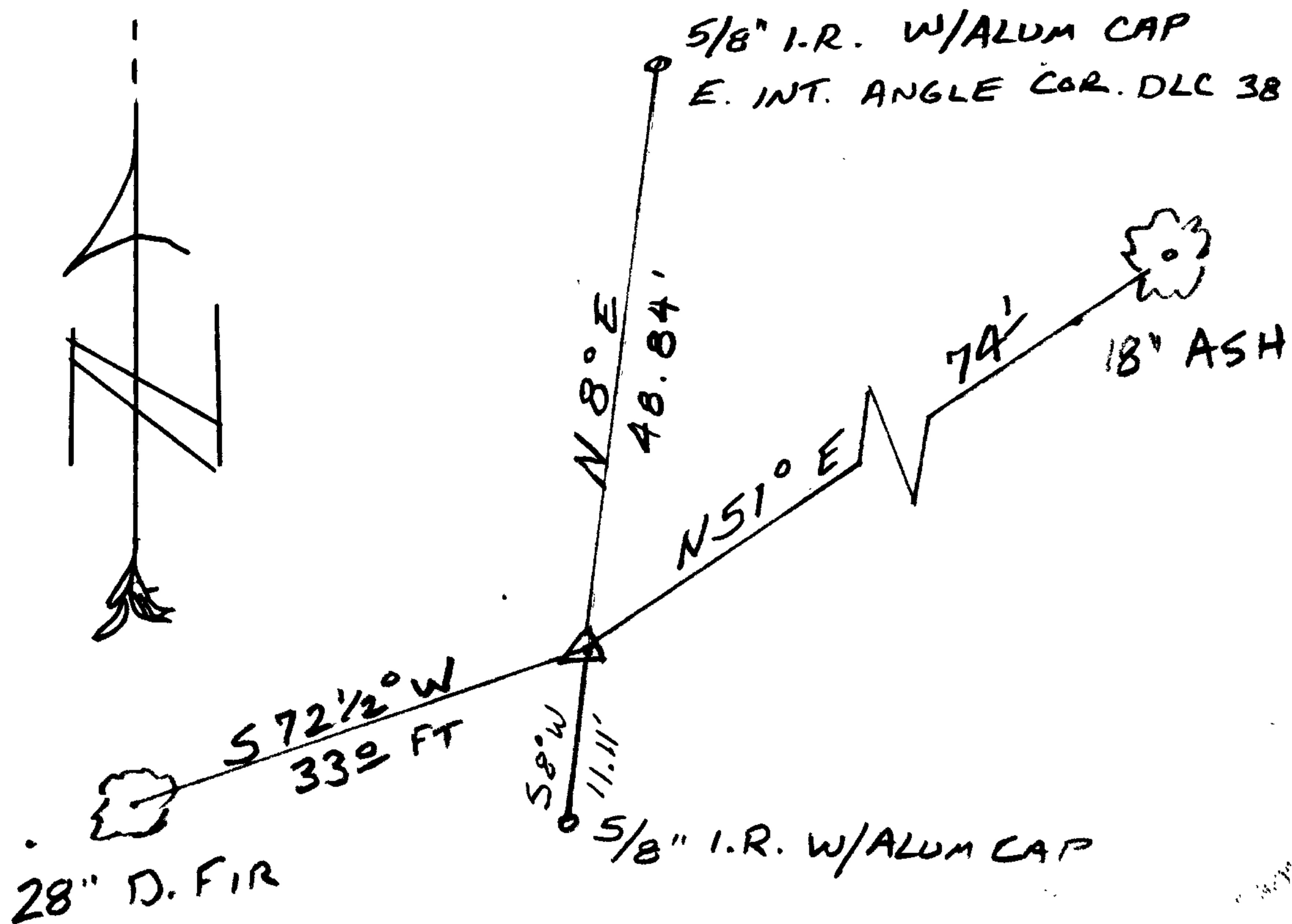

Location & Comments

CORNER LIES IN BINDER RD.

Comp. Declin. 17 1/2° E
Agency D.C.S.O.
Party Chief S. FLAUSE
Notekeeper J. PIKE
Witnesses

Address

Surveyor's Seal

REGISTERED
PROFESSIONAL
LAND SURVEYOR

Randall W. Smith
EXPIRES 6-30-2006

OREGON
JULY 25, 1997
RANDALL W. SMITH
2489