

GOVERNMENT CORNER RESTORATION FORM

Date: 9-30-2004 By: JC

Township 25S Range 5W Sec. 3

County DOUGLAS

This survey consists of:

State OR

Date 9-9-04

No. 440700

Map: \_\_\_\_\_

Narrative: \_\_\_\_\_

Corner Rpt: 67/6-21

Corner Designation

1	34
4	3

DOUGLAS COUNTY

SURVEYOR

Condition Report Only

Not Found

Renewed

Unrecorded

Surveyed In

Referenced Out

MONUMENT DETAIL

Previous Renewals FREAR 1933  
BYRON 1957

Monument(s) Found: SMITH 1997 (Condition and Source)

BRASS CAP MONUMENT FOUND (1957)  
BROKEN OFF ON TOP OF GROUND.  
IN SMALL HAYFIELD. REST OF  
IRON PIPE BENT BUT IN PLACE  
WHERE IT GOES STRAIGHT DOWN.

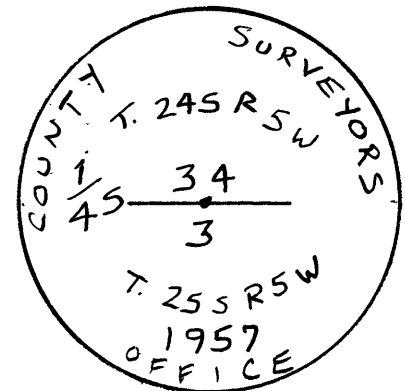

Accessories Found:

48" Now 49" W. OAK WITH LARGE PREVIOUSLY OPENED  
BLAZE BEARS S 35 1/2° W 551 1/2 FT. (1957)

ALL NEW ACCESSORIES FROM 1997 RENEWAL IN PLACE.

RENEWAL

Monument Set (Procedure and Description)

REFERENCED PLUMB POSITION  
OF BROKEN OFF PIPE.

SET 2" BRASS CAP ON 30" IRON  
PIPE 6 INCHES BELOW GROUND.  
MARKED AS SHOWN, AT REFERENCED  
POSITION.

Monument Detail

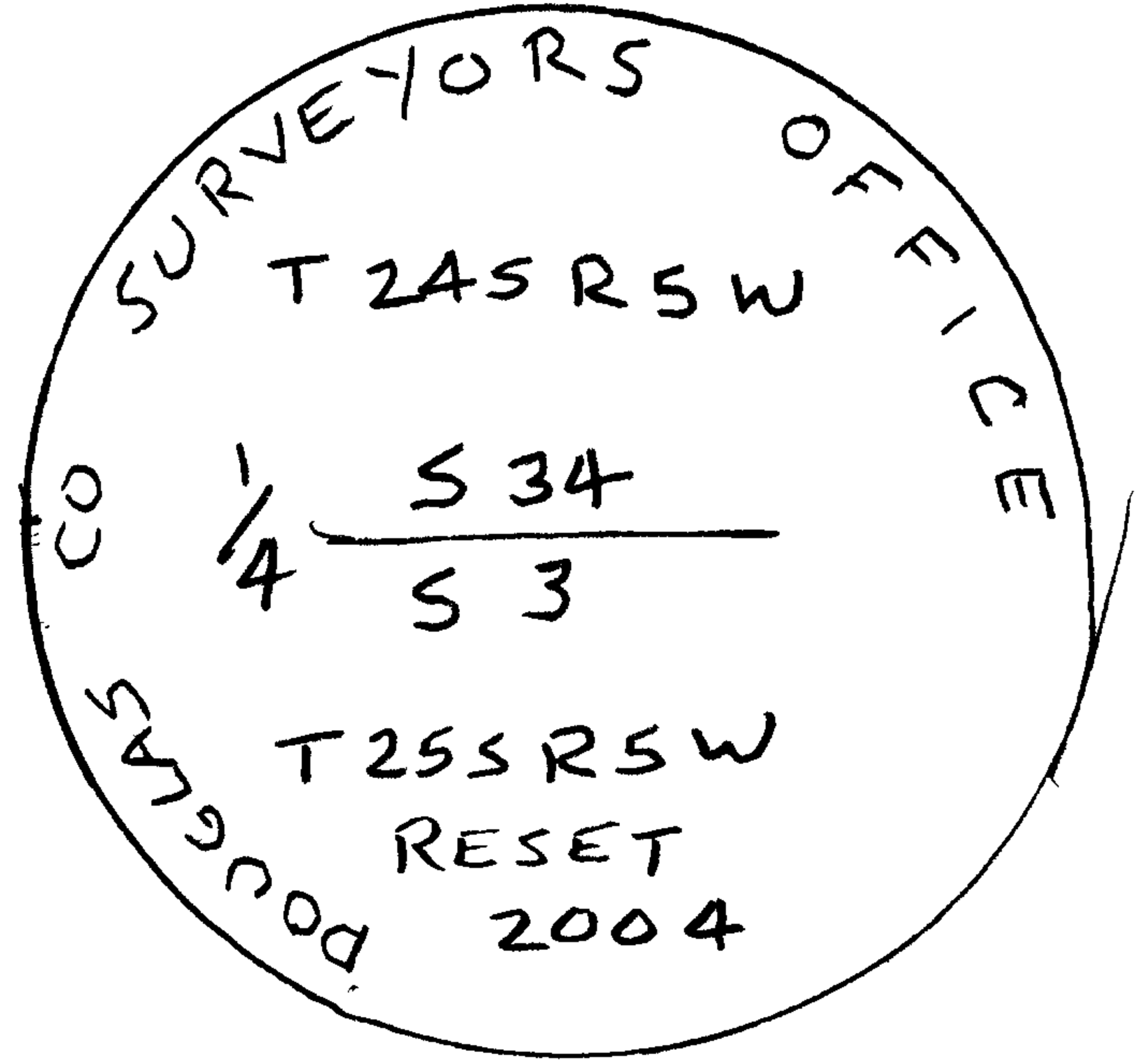

New Accessories

WITNESS POST 'NEARBY SURVEY MARKER' BEARS NORTH 58± FT.  
IN R/W FENCE.

Sketch of Monument, Accessories, and General Area

Location & Comments

Comp. Declin. 17 1/2° E  
 Agency D.C.S.O.  
 Party Chief JOHN PIKE  
 Notekeeper " "  
 Witnesses PAT CRAWFORD

Address ROOM 105 A COURTHOUSE  
ROSEBURG, OR 97470

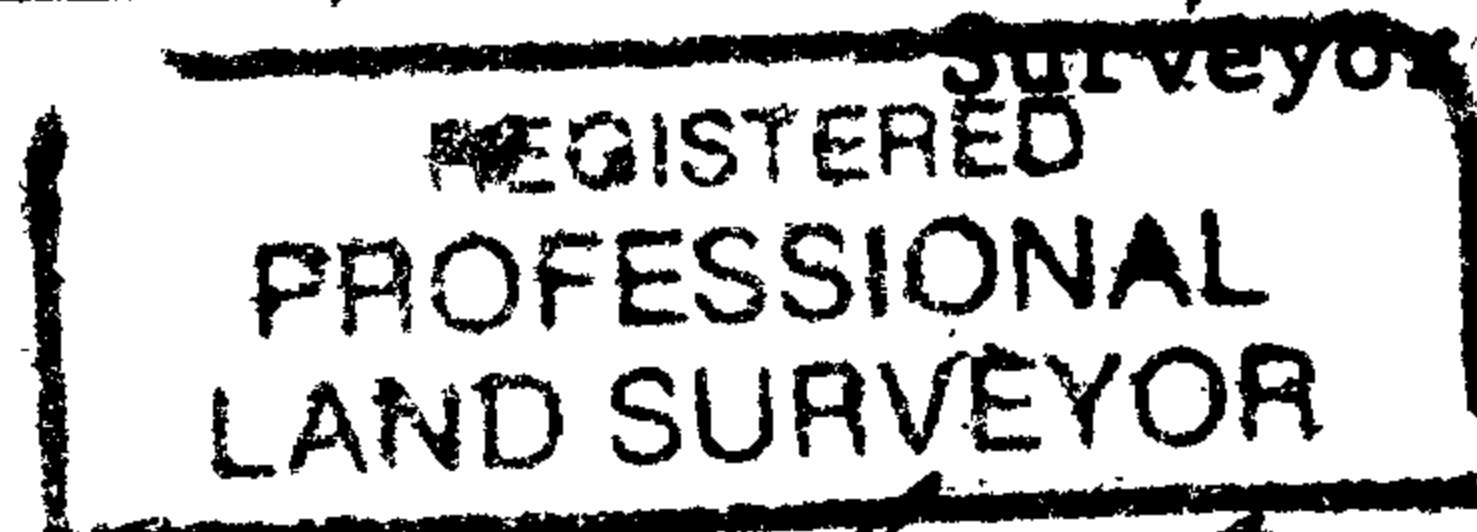

*Seal Valid at*  
 EXPIRES 6-30-2006

