

27-6-12  
Vol 2 Pg 16

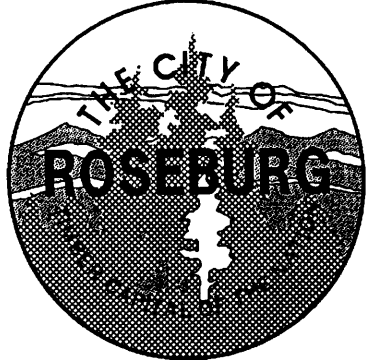

CERTIFICATION

STATE OF OREGON )  
COUNTY OF DOUGLAS ) SS  
CITY OF ROSEBURG )

I, Sheila R. Cox, City Recorder of the City of Roseburg, declare that I have compared the attached copy of Ordinance No. 3084, vacation a portion of NW Dee Street in the City of Roseburg, with the original, and hereby certify that it is a full and true copy of said document.

*Sheila R. Cox*  
\_\_\_\_\_  
Sheila R. Cox, City Recorder

December 28, 2000

FILED

Date: 1-3-2001 By: JP  
This survey consists of:  
FOR Map: Vol 2 Pg 16  
Narrative: \_\_\_\_\_  
Corner Rpt: \_\_\_\_\_

DOUGLAS COUNTY  
SURVEYOR

C.S. File No. 66/15-9A

ORDINANCE NO. 3084**AN ORDINANCE VACATING OF A PORTION OF NW DEE STREET  
IN THE CITY OF ROSEBURG**

**WHEREAS**, pursuant to Roseburg Municipal Code Chapter 4.06, upon receipt of a report from the Community Development Department, the City Recorder initiated proceedings to vacate a portion of NW Dee Street located in northeast Roseburg, more particularly described in Section 1 of this ordinance and shown on the map attached hereto as Exhibit "A" of this ordinance; and

**WHEREAS**, the City Recorder published a notice of public hearing on the proposed vacation to be held before the Roseburg City Council on November 13, 2000, in The News-Review, a newspaper of general circulation in the City of Roseburg, Oregon, on October 22 and 29, 2000, posted said notice at or near each end of the vacation area and mailed such notice to all affected property owners, not less than 14 days prior to the date of the hearing, all of which more fully appear in the proof of publication, posting and mailing on file in the City Recorder's Office; and

**WHEREAS**, such public hearing was duly held before the Roseburg City Council on the above mentioned date, and all persons desiring to be heard on said matter were heard;

**NOW, THEREFORE, THE CITY OF ROSEBURG ORDAINS AS FOLLOWS:**

**Section 1.** That portion of NW Dee Street located in northeast Roseburg in the City of Roseburg, and more particularly described as follows, is hereby vacated:

A strip of land in Township 27 South, Range 06 West, Willamette Meridian, Section 12, lying 16.5 feet on either side of a centerline beginning at a point 16.5 feet west of the northwest corner of Lot 8, Fruitvale Addition to Douglas County, Oregon; thence, south along said centerline to its intersection with the easterly line of the Oakland-Shady Highway which centerline is referred to in that deed to the State of Oregon, Department of Transportation, recorded May 15, 1991 in Book 1136, Page 775 Douglas County Book of Records.

**Section 2.** A public and private utility easement shall be granted and reserved over the entire property described in the above Section 1, and being vacated by this ordinance, for the purpose of allowing continued existence and future maintenance of, and the right of ingress and egress to, any public or private utility which currently has utility facilities located within the area being vacated, until such time said facilities are relocated. There shall be no modifications to or construction on the property being vacated which would in any way interfere or conflict with any public and/or private utility currently located within the vacated area, unless plans for said modification or

utility facilities located within the area being vacated, until such time said facilities are relocated. There shall be no modifications to or construction on the property being vacated which would in any way interfere or conflict with any public and/or private utility currently located within the vacated area, unless plans for said modification or construction are developed in a manner which is considered compatible with said utilities.

**Section 3.** The title to the property being vacated by this ordinance shall attach to the lands bordering on such equal portions in accordance with ORS 271.140.

**Section 4.** Pursuant to ORS 271.150, the City Recorder is hereby directed to file a certified copy of this ordinance and the map attached hereto as Exhibit "A" with the Douglas County Clerk, Douglas County Assessor and Douglas County Surveyor.

ADOPTED BY THE CITY COUNCIL THIS 27th DAY OF November 2000, AND

APPROVED BY THE MAYOR THIS 27th DAY OF November, 2000.

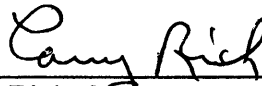
  
\_\_\_\_\_  
Larry Rich, Mayor

ATTEST:

  
\_\_\_\_\_  
Sheila R. Cox, City Recorder

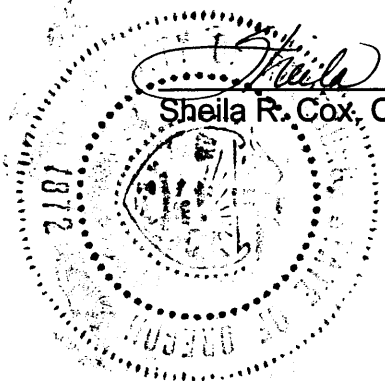

# EXHIBIT "A"

<input type="checkbox"/>	VAC002NOTICE
<input checked="" type="checkbox"/>	VAC002AREA
<input checked="" type="checkbox"/>	TEXT
<input type="checkbox"/>	city
<input checked="" type="checkbox"/>	parcel

BOOK 1730 PAGE 275

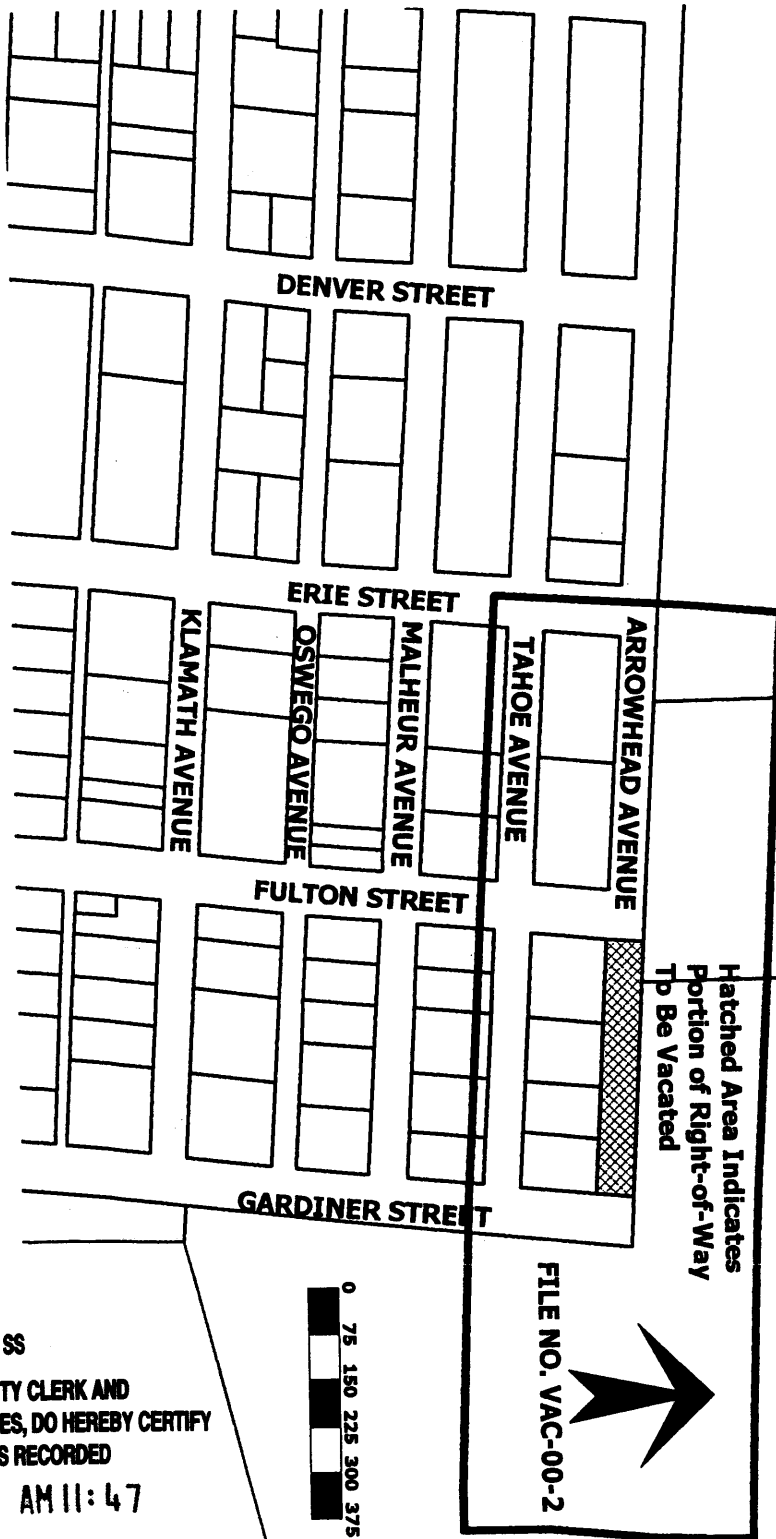

Bold Line Indicates Properties Located Within the Notification Boundary

Hatched Area Indicates Portion of Right-of-Way To Be Vacated



STATE OF OREGON }  
COUNTY OF DOUGLAS } SS  
I, DOYLE SHAVER JR., COUNTY CLERK AND  
RECORDER OF CONVEYANCES, DO HEREBY CERTIFY  
THAT THIS INSTRUMENT WAS RECORDED

00 DEC 28 AM 11:47

DOYLE SHAVER JR.  
DOUGLAS COUNTY CLERK

IN THE OFFICIAL RECORDS OF DOUGLAS COUNTY

BY Deana Odair

DEPUTY	26 <sup>00</sup>
FILE	10 <sup>00</sup>
	36 <sup>00</sup>

2000-26405

HANDED City/NANCY