

GOVERNMENT CORNER RESTORATION FORM

Township 235 Range 7W Sec. 8  
State OR Date 7-28-99

County DOUGLAS This survey consists of:  
Map: \_\_\_\_\_  
Narrative: \_\_\_\_\_  
Corner Rpt: 66/12-42

Corner Designation

$\frac{1}{4}$  S 8  
S 17

DOUGLAS COUNTY  
SURVEYOR  
Condition Report Only  
 Not Found  
 Renewed  
 Unrecorded  
 Surveyed In  
 Referenced Out

Previous Renewals 1965 BLM

Monument(s) Found: (Condition and Source)  
3 1/2" DIA BLM BRASS CAP ON A  
2 1/2" DIA. IRON PIPE, PROTRUS  
3" ABOVE GROUND 1965  
  
BOTH BT'S FROM 1965 FOUND  
PER RECORD.  
  
\* THE ABOVE MONUMENT IS APPROX -  
IMATELY S 32 3/4° E, 118 FEET DISTANT  
FROM THE CORNER LOCATION AS  
DETERMINED FROM THE FOUND  
ORIGINAL BT EVIDENCE AS NOTED  
BELOW.

U.S. DEPT. OF THE INTERIOR

$\frac{1}{4}$  S 8  
S 17  
T 235 R 7W  
1965

BUREAU OF LAND MANAGEMENT

Accessories Found:

4" NOW 20" DIA 1 1/2 FT HIGH D. FIR STUMP  
WITH SCRIBING VISIBLE "BT" BEARS  
N 4 1/2° E, 35.0 FT (AGREE WITH REC.) OBT  
  
24" NOW 48" DIA 3 FT HIGH D. FIR STUMP  
PARTIALLY ROTTED SHOWS EVIDENCE OF OLD SHALLOW STAMPIT  
BEARS, S 56 1/4° W, 25 1/2 FT (RECORD S 56 1/4° W, 27 FT; THIS IS A REASONABLE SLOPE DIST.)  
OBT.

RENEWAL

Monument Set (Procedure and Description)

2 3/8" DIA BRASS CAP ON A  
 1 3/8" O.D. BY 32" LONG IRON  
 PIPE SET AT A POSITION  
 DETERMINED BY ORIG. BTS.  
 PROTRUDES 8" ABOVE GROUND.

Monument Detail

DOUGLAS COUNTY SURVEYORS  
 T 23 S  
 R  
 1/4 S8 7  
 S17 W  
 1999  
 OFFICE

New Accessories

12" MAPLE DOUBLE BLAZED AND SCRIBED "1/4 S8 CSBT"  
 BEARS N 63 1/2° W, 17.6 FT  
 7" I. CEDAR DOUBLE BLAZED AND SCRIBED "1/4 S17 CSBT"  
 BEARS S 13° E, 23.0 FT  
 16" W. FIR DOUBLE BLAZED AND SCRIBED "1/4 S8 CSBT"  
 BEARS N 80° E, 25.7 FT  
 20" D. FIR, SINGLE BLAZED AND SCRIBED "1/4 S8 CSBT"  
 BEARS N 26° W, 33.5 FT

Sketch of Monument, Accessories, and General Area

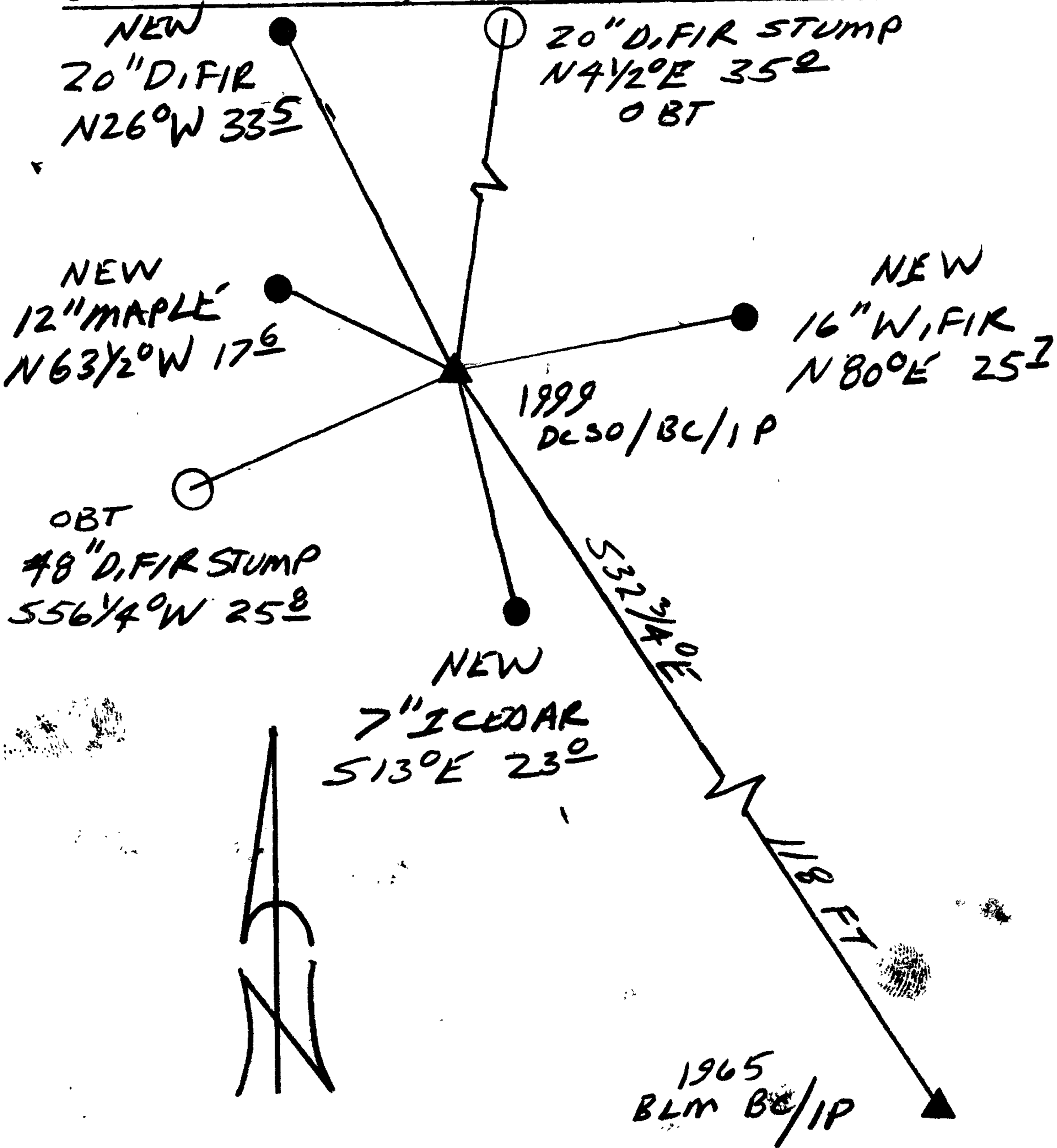

Location & Comments

SET DC SO. BC / IP. AND  
 SCRIBED NEW BTS ON  
 11-22-99

NOTE BLM WAS  
 INFORMED OF THE ORIG.  
 CORNER BEING FOUND, NEAR  
 DATE OF DISCOVERY

Comp. Declin. 17 3/4° E  
 Agency DC SO  
 Party Chief RANDALL W. SMITH  
 Notekeeper [Signature]  
 Witnesses STEPHEN J. FRAISE

Address

Surveyor's Seal

REGISTERED  
 PROFESSIONAL  
 LAND SURVEYOR

[Signature]  
 MAPS 6-30-2000

OREGON  
 JULY 25, 1990  
 RANDALL W. SMITH  
 2469



# PROJECT NOTIFICATION TO COUNTY SURVEYORS

## LOCATION NOTIFICATION

PROJECT <i>M.P. 4.7 Slide</i>		REGION 3	KEY NUMBER <i>09988</i>
HIGHWAY <i>Elkton-Sutherland (138W)</i>	FROM MILE POST	TO MILE POST	COUNTY Douglas
LOCATION PROJECT MANAGER Robert G. Pappe, PLS, PE	TELEPHONE 957-3580	COUNTY SURVEYOR Romey Ware, PLS	TELEPHONE 440-4272
ADDRESS 3500 NW Stewart Parkway, Suite 140		ADDRESS Douglas County Courthouse, Room 105A	
CITY STATE AND ZIP CODE Roseburg, Oregon 97470		CITY STATE AND ZIP CODE Roseburg, Oregon 97470	
PROJECT DESCRIPTION <i>Slide stabilization, realignment of highway, possible right-of-way take or easement.</i>			
SURVEY START DATE <i>April 27, 1998</i>		SURVEY END DATE <i>May 29, 1998</i>	SCHEDULED CONSTRUCTION DATE <i>April 1999</i>
KNOWN PUBLIC LAND SURVEY SYSTEM MONUMENTS WITHIN PROJECT LIMITS <i>X4 Corner Secs. 8 &amp; 17, T23S, R7W, 1965</i>			

LOCATION PROJECT MANAGER SIGNATURE

*ROBERT PAPPE PE, PLS*

## CONSTRUCTION NOTIFICATION

CONSTRUCTION PROJECT MANAGER	TELEPHONE	CONTRACT AWARD DATE
ADDRESS		ESTIMATED COMPLETION DATE
CITY STATE AND ZIP CODE		
PUBLIC LAND SURVEY SYSTEM MONUMENTS AFFECTED BY CONSTRUCTION		
TO BE REPLACED BY		

PLANS ENCLOSED

PLANS TO FOLLOW

CONSTRUCTION PROJECT MANAGER SIGNATURE

LOCATION PROJECT MANAGER: Fill out top section prior to location survey and forward to County Surveyor.

Submit copy with location data for completion by Construction PM.

CONSTRUCTION PROJECT MANAGER: Complete lower section prior to commencement of construction.

Forward to County Surveyor with copy of preliminary contract plans.