

GOVERNMENT CORNER RESTORATION FORM

Date: 11-4-1999 By: JC

This survey consists of:

Township 28S Range 5W Sec. 2

County DOUGLAS Map: _____

State OR Date 9-9-99

No. 400500-018 Corner Rpt: 66/12-36

Corner Designation

S9/S10
S16/S15

DOUGLAS COUNTY SURVEYOR

Condition Report Only

Not Found

Renewed

Unrecorded

Surveyed In

Referenced Out

MONUMENT DETAIL

Previous Renewals 1925 + 1961

Monument(s) Found: (Condition and Source)

2 1/2" DIA BRASS CAP ON A
1 1/2" O.D. IRON PIPE, PROTRUDES
15" ABOVE GROUND. 1961

COUNTY SURVEYORS OFFICE
T28S R5W

S9/S10
S16/S15
1961

Accessories Found:

12" NOW 21" DIA DEAD B. OAK WITH A FULLY
HEALED DOUBLE BLAZE, BEARS N69 1/2° W, 313.7 FT.
(AGREES WITH REC.) 1925

21" NOW 23" DIA. DEAD B. OAK WITH A FULLY
HEALED DOUBLE BLAZE, BEARS S77 1/2° W, 44.0 FT
(AGREES WITH REC.) 1961

19" NOW 24" DIA W. OAK WITH A FULLY HEALED
DOUBLE BLAZE, BEARS S80 1/2° E, 311.7 FT
(AGREES WITH REC.) 1961

12" NOW 17" DIA. W. OAK WITH A FULLY HEALED
DOUBLE BLAZE, BEARS N49 1/2° E, 78.5 FT
(AGREES WITH REC.) 1961

RENEWAL

Monument Set (Procedure and Description)

Monument Detail

NONE

N/A

New Accessories

8" DIA. W. OAK DOUBLE BLAZED AND SCRIBED "T285 R5W
S 16 CS BT", BEARS S 74 1/2° W, 24.1 FT

14" DIA. MADRONE DOUBLE BLAZED AND SCRIBED "T285 R5W
S 15 CS BT", BEARS S 55° E, 33.7 FT

Sketch of Monument, Accessories, and General Area

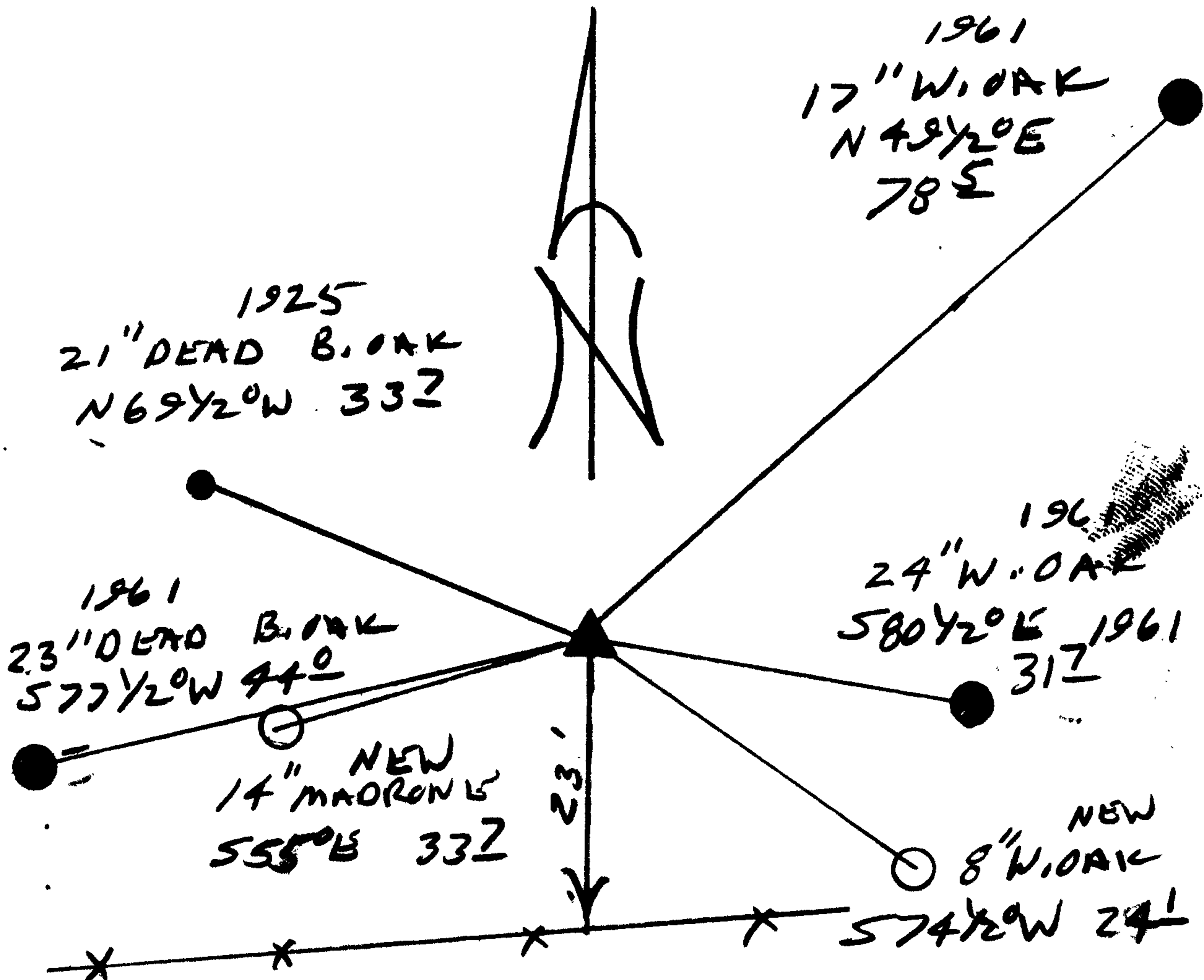

Location & Comments

CORNER LIES 23 FT
NORTH OF A RANDOM
S.W. LY. RUNNING FENCE

Comp. Declin. 17 3/4° E
Agency DCS
Party Chief RANDALL W. SMITH
Notekeeper [Signature]
Witnesses STEPHEN J. FLAISE

Address

Surveyor's Seal

REGISTERED
PROFESSIONAL
LAND SURVEYOR

[Signature]
EXPIRES 6-30-2000

OREGON
JULY 28, 1980
RANDALL W. SMITH
2488