

GOVERNMENT CORNER RESTORATION FORM

Date: 11-3-1999 By: SC

Township 265 Range 3W Sec. \_\_\_\_\_

County DOUGLAS Map: \_\_\_\_\_

This survey consists of:

State OR Date 7-29-99

No. 043020 Narrative: \_\_\_\_\_

Corner Rpt: 66/12-26

Corner Designation

NW  
DLC  
43

DOUGLAS COUNTY

Condition Report Only

Not Found

7 Renewed

Unrecorded

Surveyed In

Referenced Out

MONUMENT DETAIL

Previous Renewals 1916, 1934, AND 1966 DCSO

Monument(s) Found: (Condition and Source)

2 1/2" DIA BRASS CAP ON A  
1 1/2" O.D. IRON PIPE PROTRUDES  
11" ABOVE GROUND. 1/1966

COUNTY SURVEYORS OFFICE

T 265  
N.W. COR.

D.L.C. | 43

R 3W  
1966

Accessories Found:

8" NOW 17" DIA W. OAK WITH A FULLY HEALED BLAZE  
BEARS S 27 1/2° W 49.7 FT (AGREES WITH REC.) 1966

10" NOW 8" DIA W. OAK WITH A FULLY HEALED DOUBLE  
BLAZE, BEARS N 30° E, 51.1 FT (REC N 32° E, 51.1 FT)  
1966

ROTTED D. FIR STUMP BEARS N 53° E, 3.5 FT  
(AGREES WITH REC.) 1934

ROTTED D. FIR STUMP BEARS S 24° E, 17.0 FT  
(AGREES WITH REC.) 1934

RENEWAL

Monument Set (Procedure and Description)

NONE

Monument Detail

N/A

New Accessories

WIT. COR SW PLC 46 (2 1/2" DCSO BC ON A 1 1/2" O.D. IRON PIPE, PRETRUPES 10" ABOVE GROUND IN A FENCE LINE) BEARS N 89° W, 183.8 FT

Sketch of Monument, Accessories, and General Area

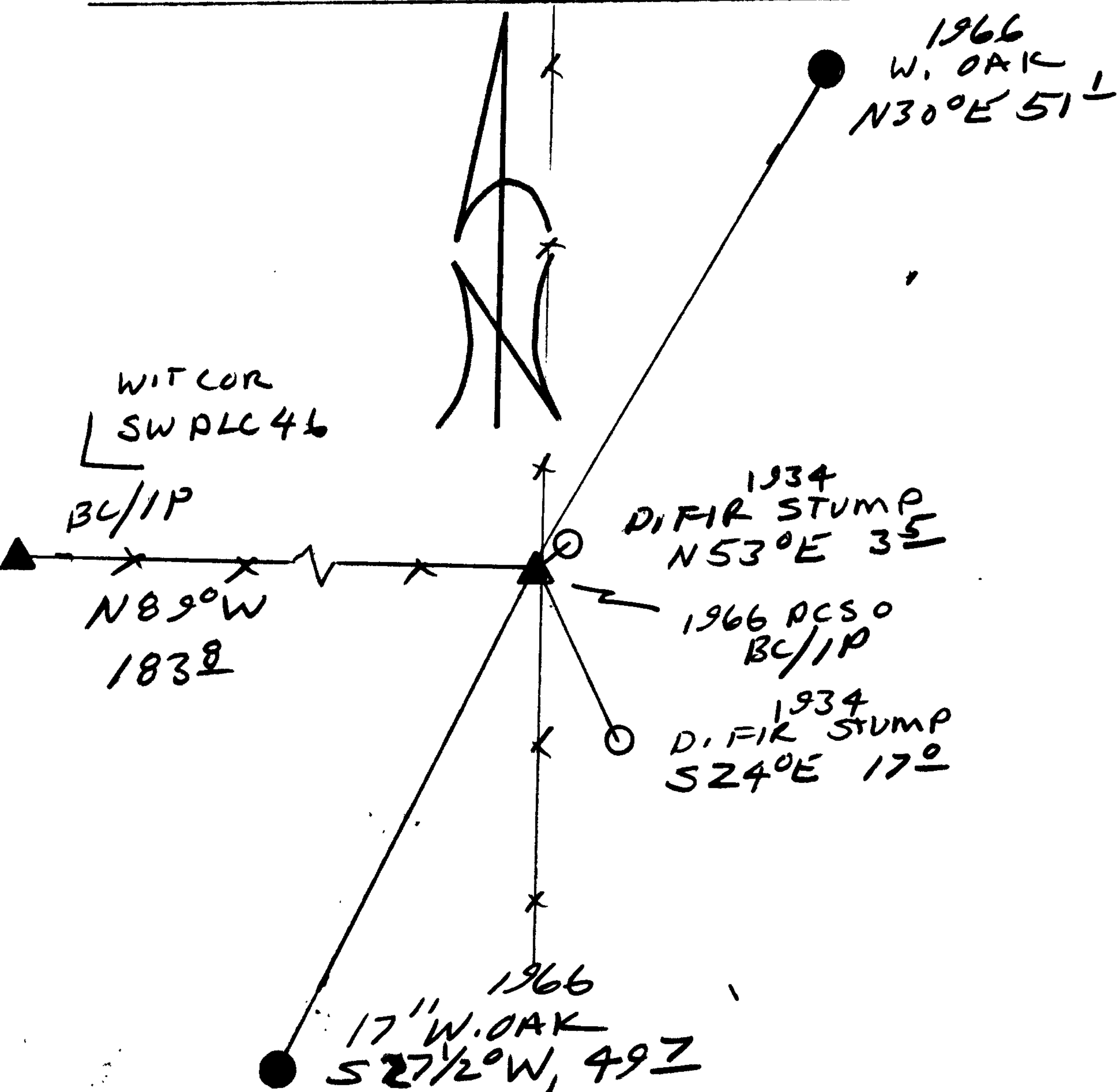

Location & Comments

COR LIES IN AN OLD NOW DOWN FENCE CORNER WITH FENCES RUNNING N'ly, S'ly AND W'ly

Comp. Declin. 17 3/4° E  
Agency DCSO  
Party Chief RANDALL W SMITH  
Notekeeper [Signature]  
Witnesses STEPHEN J FLAUSE

Address

Surveyor's Seal

REGISTERED PROFESSIONAL LAND SURVEYOR

[Signature]  
EXPIRES 6-30-2000

OREGON  
JULY 26, 1990  
RANDALL W. SMITH  
2469