

## GOVERNMENT CORNER RESTORATION FORM

Date: 11-3-1999 By: XTownship 27S Range 6W Sec. 2 County DOUGLAS Map: \_\_\_\_\_State OR Date 7-21-99 No. 500640.002 Narrative: \_\_\_\_\_Corner Designation PERPETUATE CORNER AS DETERMINED BY M 45-71 66/12-251/4 S3/S2 IN 1972DOUGLAS COUNTY  
Condition Report Only  
 Not Found  
 Renewed  
 Unrecorded  
 Surveyed In  
 Referenced OutPrevious Renewals M 45-71 1972

Monument(s) Found: (Condition and Source)

1/4" O.D. IRON PIPE GLASS  
CAP MISSING PROTRUDES  
1" ABOVE GROUND BENT  
0.4 FT SE'ly. 1972

N/A

Accessories Found:

10" NOW 30" DIA W. OAK WITH A FULLY HEALED  
BLAZE BEARS N 60 1/4° E, 69.3 FT (REL.  
N 58 1/4° E, 69.3 FT) ORT10" NOW 13" DIA W. OAK WITH A FULLY HEALED  
SINGLE BLAZE BEARS N 79° E, 56.9 FT (REL.  
N 72° E, 56.9 FT). 1972

RENEWAL

Monument Set (Procedure and Description)

I.P. RETURNED TO PLUMB POSITION, PROTRUDS 2" ABOVE GROUND

Monument Detail

N/A

New Accessories

5/8" I.R. WITH "IE KNG" PLASTIC CAP, BEARS S12 1/2° W, 30.0 FT.

6" DIA ASH DOUBLE BLAZED AND SCRIBED "Y45 3 CS BT" BEARS S39° W, 109.2 FT. NOTE: BEG GOES TO CENTER OF BASE OF MOST EASTERLY TRUNK OF NORTHERLY GROUP OF TREES IN A SMALL GROVE

Sketch of Monument, Accessories, and General Area

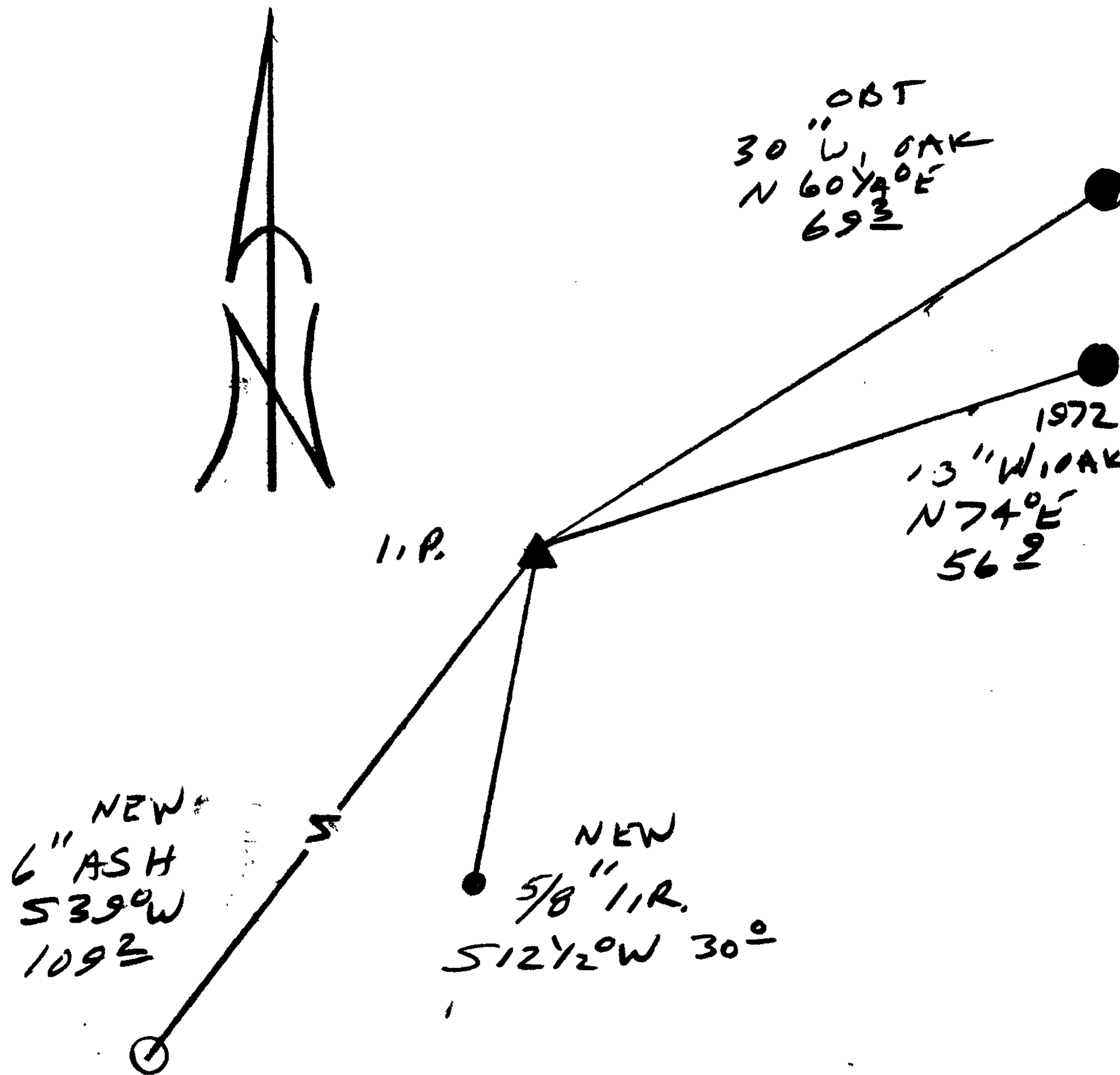

Location & Comments

Blank lines for location and comments.

Comp. Declin. 17 3/4° E  
Agency DCSO  
Party Chief STEPHEN J. FRAZER  
Notekeeper Stephen John Frazer  
Witnesses JOHN L. PIKE

Address

Blank line for address.

