

GOVERNMENT CORNER RESTORATION FORM

Date: 10-18-1999 By: JC

Township 29S Range 8W Sec. 9

County DOUGLAS

This survey consists of:

State OR Date 7-13-99

No. 400540111

Narrative:

Corner Rpt: 66/12-9

Corner Designation

1/4 S9/S10

DOUGLAS COUNTY

Condition SURVEYOR only

Not Found

Renewed

Unrecorded

Surveyed In

Referenced Out

Previous Renewals 1939 OSHD, 1967+1978 DCSO, 1982 BLM

MONUMENT DETAIL

Monument(s) Found: (Condition and Source)

2 1/2" BRASS CAP ON A 1 1/2" O.D. IRON PIPE, TOP LEANS 1 1/2 FT NORTH OF PLUMB, PROTRUDING 6" ABOVE GROUND, 1967 DCSO

1/2" DIA. IRON ROD PROTRUDING 8" ABOVE GROUND SOUTH UNKNOWN I.R. FOUND ALONG SOUTH EDGE OF PLUMB POSITION OF BC/IP

COUNTY SURVEYORS OFFICE

T 29S R 8W

1/4 S9/S10

1967

Accessories Found:

30" NOW 37" DIA 4 FT HIGH HEMLOCK STUMP WITH A FULLY HEALED SINGLE BLAZE AND METAL TOP, BEARS N 70 1/2° W, 56.8 FT (REC. N 70 1/2° W, 55.7 FT DIST. FITS FOR A FACE MEASUREMENT), 1939

48" NOW 44" DIA 3 FT HIGH O.F.I.R STUMP, NO SCRIBING VISIBLE, BEARS S 46° E 33.4 FT (REC. S 46° E 37.6 DIST. GOOD TO FACE) 1939

15" NOW 24" DIA 2 FT HIGH CEDAR STUMP WITH A FULLY HEALED BLAZE, BEARS S 37° E, 11.4 FT (AGREES WITH REC.) 1967

EVIDENCE OF ORT'S NOW GONE AREA FALLS WITHIN BULL DOZER TRAIL UNDER POWER LINES

17" NOW 24" DIA CEDAR WITH A FULLY HEALED DOUBLE BLAZE, BEARS N 52° E, 142.6 FT (AGREES WITH 1982 BLM)

RENEWAL

Monument Set (Procedure and Description)

BC/IP RETURNED TO PLUMB POSITION, PROTRUDE 10" ABOVE GROUND.

Monument Detail

N/A

New Accessories

14" DIA. HEMLOCK DOUBLE BLAZED AND SCRIBED 1/4S 9 CS BT 13 BEARS N 24° W, 41.9 FT
15" DIA. HEMLOCK DOUBLE BLAZED AND SCRIBED 1/4S 10 CS BT 13 BEARS S 70 3/4° E, 69.2 FT

Sketch of Monument, Accessories, and General Area

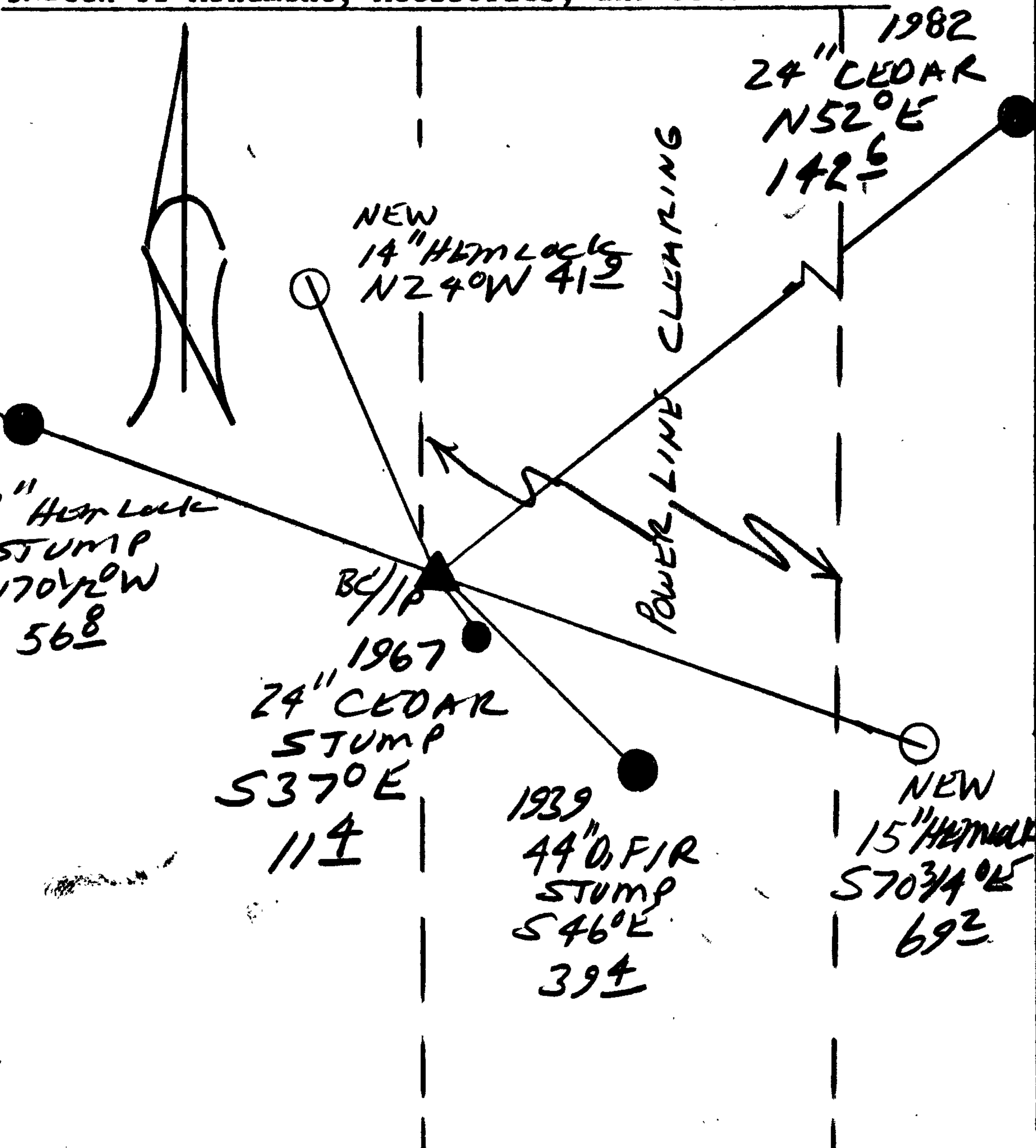

Location & Comments

CORNER LIES ON A STEEP SOUTH SLOPE ON WEST EDGE OF POWER LINE CUT

Comp. Declin. 17 3/4° E
Agency DCSO
Party Chief RANDALL W. SMITH
Notekeeper [Signature]
Witnesses STEPHEN J. FLAUS

Address

Surveyor's Seal

