

GOVERNMENT CORNER RESTORATION FORM

Date: 10-18-1999 By: JC

This survey consists of:

Township 29S Range 8 W Sec. \_\_\_\_\_

County DOUGLAS Map: \_\_\_\_\_

State OR

Date 7-13-99

No. 045020.111

Narrative: \_\_\_\_\_

Corner Rpt: 66/12-8

Corner Designation

DLC  
45

DOUGLAS COUNTY

Condition Report Only

Not Found

Renewed

Unrecorded

Surveyed In

Referenced Out

MONUMENT DETAIL

Previous Renewals 1924 GLO, 1957+1966 OCSO

Monument(s) Found: (Condition and Source)

2 1/2" O.D. IRON PIPE PROTRUDES  
20" ABOVE GROUND

2" X 3" PROTRUDES 6" ABOVE  
GROUND STUMP IS 15" SOUTH  
OF FB/11 0.7 FT.

N/A

Accessories Found:

19" PINE NOW GOOD ROOT HOLE BEARS N 28 1/2° E,  
40.9 FT (AGREES WITH REC.) 08T

40" NOW 48" DIA. 1 1/2 FT HIGH D. FIR STUMP,  
SCRIBING FOUND "45 FT", BEARS N 73 1/2° E,  
46.9 FT (REC. N 76° E 46.9 FT) 1923

5" NOW 18" DIA 1 FT HIGH ROTTED D. FIR STUMP  
WITH ILLEGIBLE SCRIBING BEARS S 78 1/2° E, 21.7 FT  
(REC. S 82° E, 21.7 FT) 1957

7" NOW 15" DIA D. FIR WITH A FULLY HEALED  
DOUBLE BLAZE BEARS N 89° W 15.4 FT  
(REC. S 86° W, 15.4 FT) 1957

RENEWAL

Monument Set (Procedure and Description)

NONE

Monument Detail

N/A

New Accessories

4" D. FIR DOUBLE BLAZED AND SCRIBED " X 13T"  
BEARS N51 1/2° E 13.1 FT.

7" W. OAK DOUBLE BLAZED AND SCRIBED " SW D L C 45 C S BT"  
BEARS S13° W, 16.7 FT.

Sketch of Monument, Accessories, and General Area

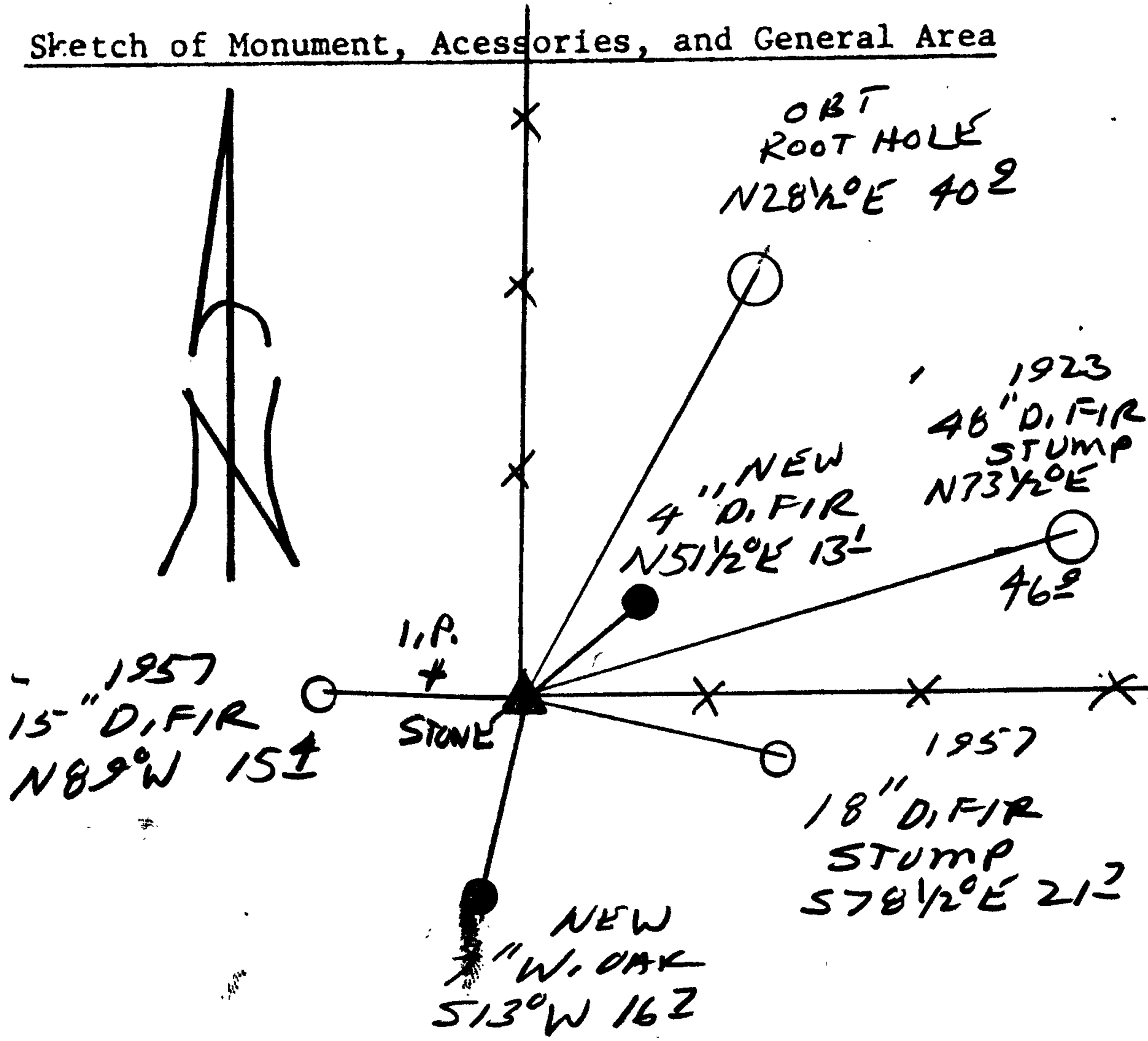

Location & Comments

CORNER LIES AT THE INTERSECTION OF A FENCE CORNER WITH FENCE LINES RUNNING NORTH AND EAST

Comp. Declin. 17 3/4° E  
Agency OCSO  
Party Chief RANDALL W. SMITH  
Notekeeper [Signature]  
Witnesses STEPHEN J. FLAHERTY

Address

Surveyor's Seal

REGISTERED PROFESSIONAL LAND SURVEYOR

[Signature] EX-105 6-30-2000

OREGON JULY 25, 1980 RANDALL W. SMITH 2489