

GOVERNMENT CORNER RESTORATION FORM

Date: 10-18-1999 By: JC

This survey consists of:

Township 26 S Range 4W Sec. 15 County DOUGLAS

Map: _____

State OR

Date 5-26-99

No. 400440.008

Narrative: _____

Corner Rpt: 66/12-7

Corner Designation

1/4 S16/S15

DOUGLAS COUNTY SURVEYOR

Condition Report Only

Not Found

Renewed

Unrecorded

Surveyed In

Referenced Out

MONUMENT DETAIL

Previous Renewals 1947 DCSO PI# 400440

Monument(s) Found: (Condition and Source)

2 1/2" BRASS CAP ON A 1 1/2" O.D. IRON PIPE, PROTRUDES 8" ABOVE GROUND. 1947

COUNTY SURVEYORS OFFICE

S16 / S15

Accessories Found:

FD ROOT HOLE NEAR REC OF ORIG NW BT N 75° W, 21.8 FT, ORT

7" NOW 1 1/2" DIA. W. OAK WITH A FULLY HEALED BLAZE BEARS N 68° W, 11.8 FT (AGREES WITH REC.) 1947

NO OTHER BT'S FOUND

RENEWAL

Monument Set (Procedure and Description)

Monument Detail

NONE

N/A

New Accessories

20" DIA B. OAK DOUBLE BLAZED AND SCRIBED "Y4S15CS BT"
 BEARS N 58 1/2° E 43.4 FT
 8" DIA W. OAK DOUBLE BLAZED AND SCRIBED "Y4S15CS BT"
 BEARS S 28° E 58.2 FT
 11" DIA. D. FIR DOUBLE BLAZED AND SCRIBED "Y4S16CS BT"
 BEARS S 28 1/2° W 53.8 FT

Sketch of Monument, Accessories, and General Area

Location & Comments

CORNER LIES AT THE INTERSECTION OF A 4 WAY FENCE CORNER

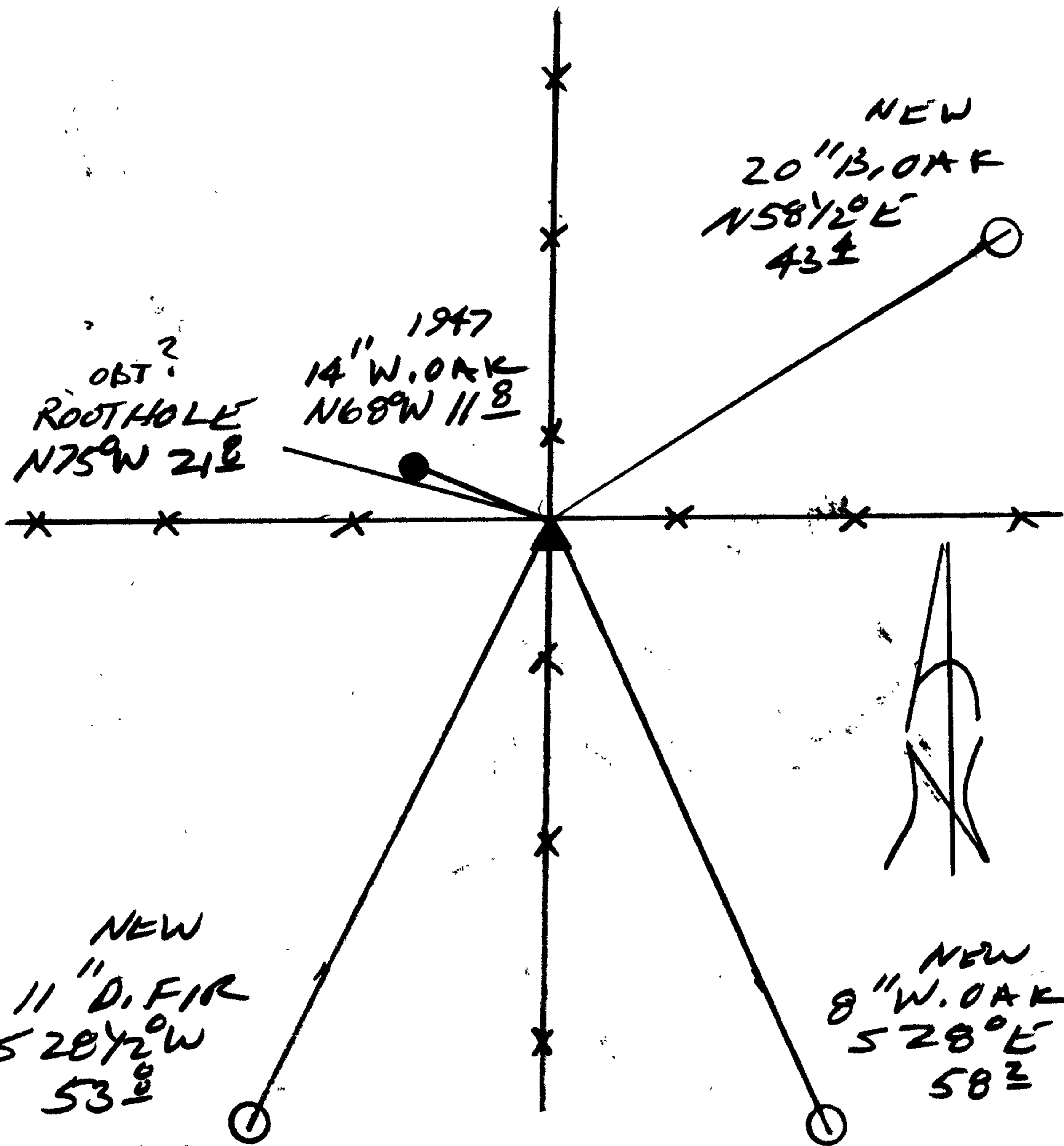

Comp. Declin. 17 3/4° E
 Agency DCSO
 Party Chief RANDALL W. SMITH
 Notekeeper [Signature]
 Witnesses STEPHEN J. FLAHERTY

Address

Surveyor's Seal

REGISTERED PROFESSIONAL LAND SURVEYOR

[Signature]

EXPIRES 6-30-2000

OREGON JULY 28, 1980 RANDALL W. SMITH 2489