

GOVERNMENT CORNER RESTORATION FORM

Date: 5/24/1999 By: JC

Township 25S Range 5W Sec. 7

County DOUGLAS

This survey consists of: _____

State OR

Date 3-30-99

No. 100500.005

Narrative: _____

Corner Rpt: 66/8-38

Corner Designation

| | |
|-----|-----|
| S12 | S7 |
| S13 | S18 |

DOUGLAS COUNTY

- Condition Survey Only
- Not Found
- Renewed
- Unrecorded
- Surveyed In
- Referenced Out

Previous Renewals 1972 + 1997

Monument(s) Found: (Condition and Source)

2 3/8" DIA BRASS CAP ON
AN IRON PIPE FLUSH
WITH GROUND. 1997

1972 DCSSO BC/IP FOUND
10" BELOW GROUND ALONG
NORTH EDGE OF 1997 BC/IP

MONUMENT DETAIL

DOUGLAS COUNTY SURVEYORS
T 25S

| | | | |
|---|----|----|---|
| R | 12 | 7 | R |
| G | | | S |
| W | 13 | 18 | W |

RESET

1997
OFFICE

Accessories Found:

BRG + DIST'S TAKEN FROM NEW 1999 COR POSITION

40" NOW 50" DIA BLACK OAK WITH A FULLY HEALED
SINGLE BLAZE BEARS N4°W, 122.6 FT (1972)

14" NOW 20" DIA MADRONE WITH A FULLY HEALED
SINGLE BLAZE BEARS S15°E, 199.2 FT (1972)

14" NOW 14" DIA BIODAK WITH A PARTIALLY HEALED
DOUBLE BLAZE, SCRIBING VISIBLE "T25S R SW S12 CS BE"
BEARS S42 3/4°E, 160.1 FT (1997)

MULTI TRUNKED W. OAK WITH A PARTIALLY HEALED
DOUBLE BLAZE ON 15" DIA SOUTH-EASTERN TRUNK,
SCRIBING VISIBLE "T25S R SW S12 CS BE" CENTER OF
ROOT CROWN OF MULTI TRUNKED TREE BEARS
N42 1/4°W, 325.4 FT (1997)

RENEWAL

Monument Detail

Monument Set (Procedure and Description)

BC/IP FROM 1997 IS REMOVED AND DATE MARKED 1999. BC/IP IS SET AT NEW PROPORTIONED POSITION, SET FLUSH WITH GROUND

N/A

~~1972 BRASS CAP IS SAUN OFF AND 1/2" BELOW PLASTIC DCSD CAP IS SET IN ITS CENTER IRON PIPE IS 1" BELOW GROUND.~~

1992 BC/IP IS SET UPSIDE DOWN AT 1972 CORNER POSITION A YELLOW DCSD PLASTIC CAP IS SET IN CENTER OF I.P., I.P. SET 3 IN BELOW GROUND.

(NOTE NO FLANGES ON 1972 BC/IP)

New Accessories

1972 IRON PIPE BEARS N 14 1/2° W, 20.3 FT

Sketch of Monument, Accessories, and General Area

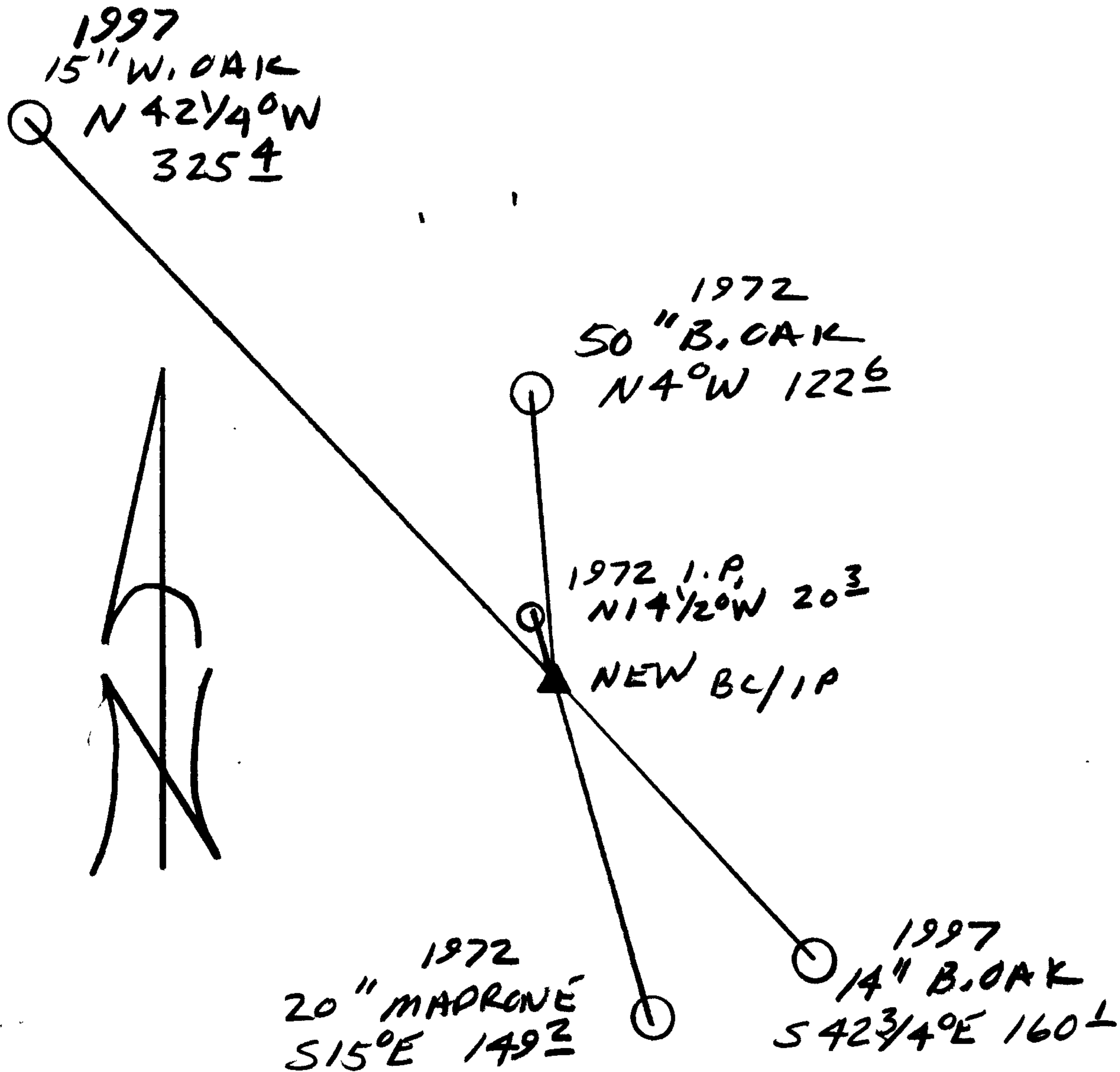

Location & Comments

Comp. Declin. 17 3/4° E
Agency DCSD
Party Chief RANDALL W. SMITH
Notekeeper [Signature]
Witnesses STEPHEN T. FLAUSCH

Address

Surveyor's Seal
REGISTERED PROFESSIONAL LAND SURVEYOR

[Signature]
EXPIRES 6-20-2000

OREGON
JULY 25, 1990
RANDALL W. SMITH
2469