

GOVERNMENT CORNER RESTORATION FORM

Date: 5-24-1999 By: JC

Township 25S Range 5W Sec. 7

County DOUGLAS

This survey consists of:

State OR

Date 3-30-99

No. 100540.005

Map: _____

Narrative: _____

Corner Designation

W.C.

1/4 S12/S7

Corner Rpt: 66/8-33

DOUGLAS COUNTY

Condition Report Only

Not Found

Renewed

Unrecorded

Surveyed In

Referenced Out

Previous Renewals 1972 + 1997 DCSO

Monument(s) Found: (Condition and Source)

2 3/8" DIA. BRASS CAP ON A 1 3/8" O.D. IRON PIPE, SET FLUSH WITH GROUND. 1997

MONUMENT DETAIL

DOUGLAS COUNTY SURVEYORS

T 25S

W.C. 99.8

N. TO

R

G

W

1/4 S12/S7

R

S

W

1997 OFFICE

Accessories Found:

BT'S FOUND AS RECORDED IN 1997 DCSO RENEWAL

RENEWAL

Monument Set (Procedure and Description)

Monument Detail

NONE

THE MARKS "99.8 N. TO"
ARE STAMPED OFF BRASS CAP

N/A

New Accessories

N/A

SEE 1997 RENEWAL

Sketch of Monument, Accessories, and General Area

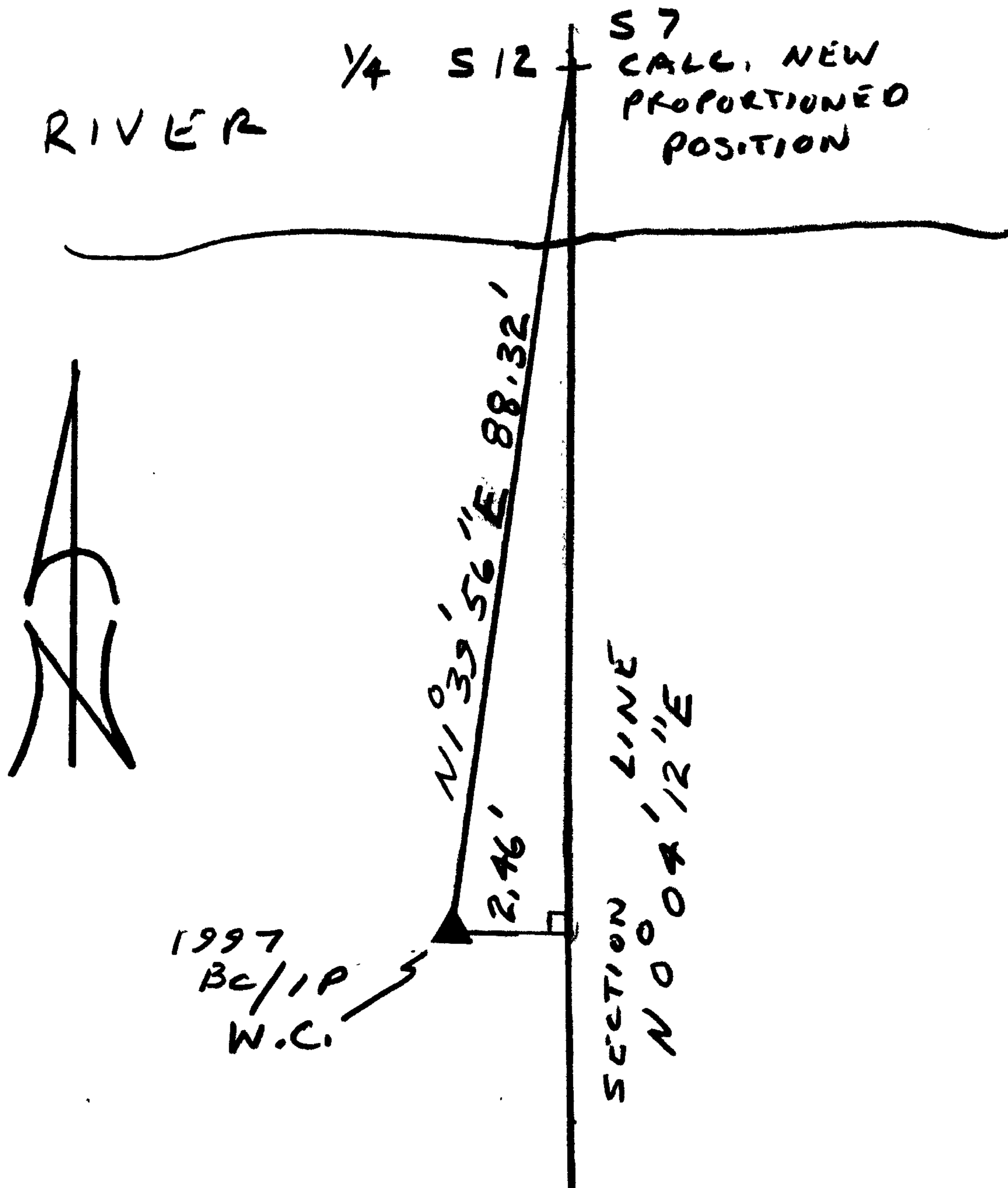

Location & Comments

Comp. Declin. 17 3/4° E

Agency DCSO

Party Chief RANDALL W. SMITH

Notekeeper [Signature]

Witnesses STEPHEN J. FLAHERTY

Address

REGISTERED Surveyor's Seal
PROFESSIONAL
LAND SURVEYOR

[Signature]
EXPIRES 6-30-2000

OREGON
JULY 25, 1990
RANDALL W. SMITH
2469