

GOVERNMENT CORNER RESTORATION FORM

Date: 5/24/1999 By: JC

This survey consists of:

Township 27S Range 7W Sec. 15

County DOUGLAS

Map:

State OR

Date 2-4-1999

No. 440400.012

Narrative:

Corner Rpt: Edo/8-27

Corner Designation

$\frac{1}{4}$ $\frac{S15}{S22}$

DOUGLAS COUNTY

Condition Report Only

Not Found

Renewed

Unrecorded

Surveyed In

Referenced Out

MONUMENT DETAIL

Previous Renewals 1954 + 1968 DCSO

Monument(s) Found: (Condition and Source)

2 1/2" BRASS CAP ON A 1 1/2" OLD IRON PIPE, PROTRUDING 13" ABOVE GROUND, 1954

COUNTY SURVEYORS OFFICE
T27S R7W

SEC 15

SEC 22

14 COR

1954

Accessories Found:

12" NOW 17" DIA. MAPLE WITH A FULLY HEADED SINGLE BLAZE, BEARS N 30W, 29.8 FT (AGREES WITH REC.) 1954

18" NOW 20" DIA B. OAK WITH A FULLY HEADED SINGLE BLAZE, BEARS S21 1/2 W 48.1 FT. (REC S23 W, 48.1 FT BEG TO BLAZE). 1968

RENEWAL

Monument Set (Procedure and Description)

Monument Detail

NONE

N/A

New Accessories

7" D. FIR DOUBLE BLAZED AND SCRIBED "Y4S15CS BT"
BEARS N 58° E, 36.7 FT

7" MADRONE DOUBLE BLAZED AND SCRIBED "Y4S22CS BT"
BEARS S 34 1/2° E, 33.9 FT

Sketch of Monument, Accessories, and General Area

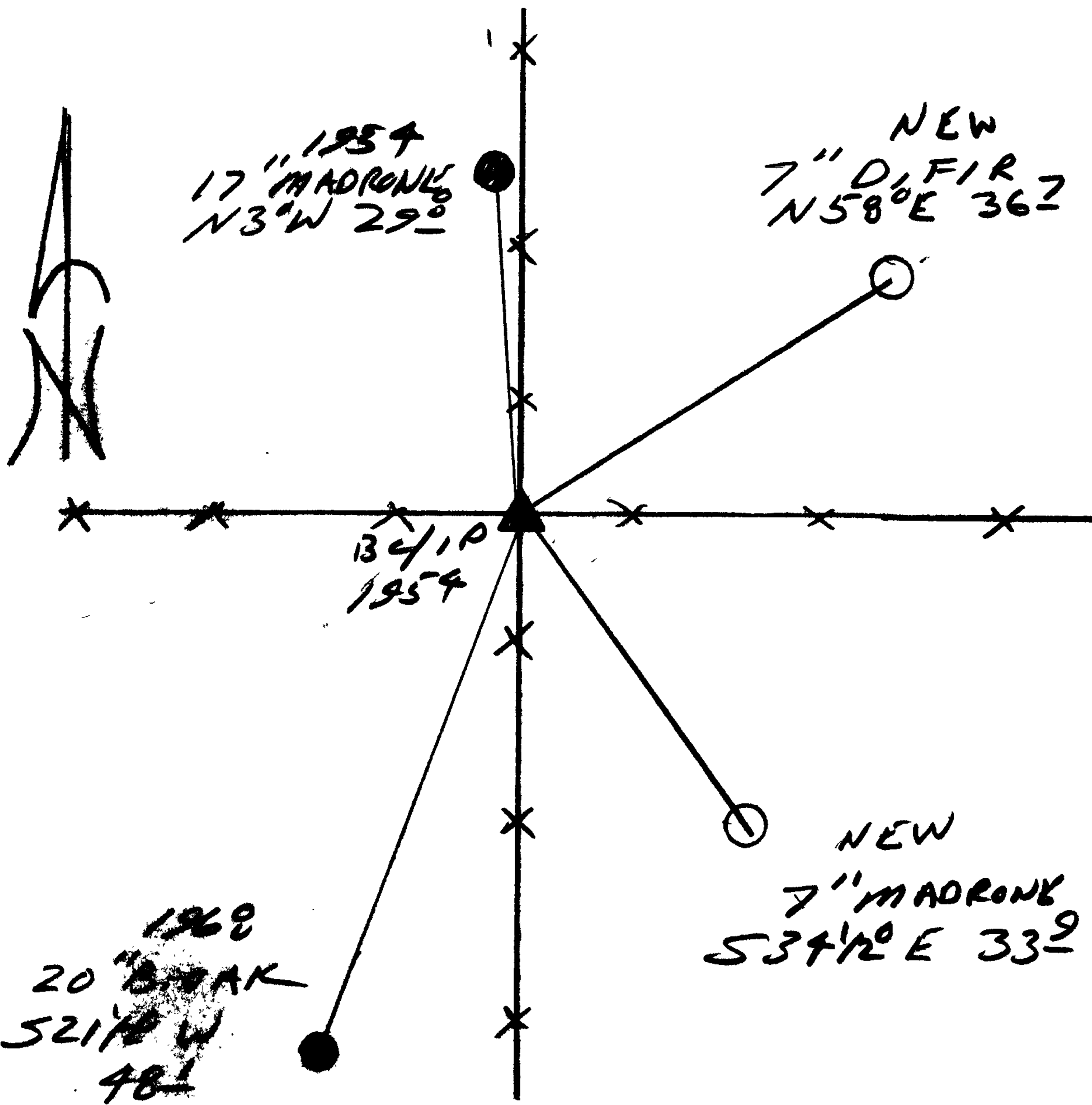

Location & Comments

COR. LINES AT THE INTERSECTION OF A 4WAY FENCE LINES

Comp. Declin. 17 3/4° E
Agency DESG
Party Chief RANDALL W. SMITH
Notekeeper
Witnesses STEPHEN J. FLAVEL

Address

Surveyor's Seal

REGISTERED PROFESSIONAL LAND SURVEYOR

Randall W. Smith
EXPIRES 6-30-2001

OREGON
JULY 25 1998
RANDALL W. SMITH
2489