

GOVERNMENT CORNER RESTORATION FORM

Date: 11-5-1998 By: DC

This survey consists of:

Township 305 Range 4W Sec. 5 County DOUGLAS

Map: _____

State OR Date 10-26-98 No. _____

Narrative: _____

Corner Rpt: 66/4-6

Corner Designation

DOUGLAS COUNTY SURVEYOR

C
N 1/16 | S5
C

- Condition Report Only
- Not Found
- Renewed
- Unrecorded
- Surveyed In
- Referenced Out

Previous Renewals 1994 BLM

MONUMENT DETAIL

Monument(s) Found: (Condition and Source)

3/4" DIA BRASS CAP ON A
2 1/2' O.D BY 30' LONG BENT
STAINLESS STEEL PIPE IS
BROUGHT INTO DCS OFFICE
BY GREG LANGR, (1994 BLM)

U.S. DEPARTMENT OF THE INTERIOR

C
N 1/16 | S5
C

"DEEP-1" MAGNETIC MARKER
WAS LOCATED 12" BELOW
NEWLY GRADED CAT ROAD
(1994 BLM)

1994

BUR. OF LAND MANAGEMENT

Accessories Found:

16" NOW 18" DIA I. CEDAR WITH AN UNHEALED
SINGLE BLAZE SCRIBING VISIBLE "CN 1/16 S5 BT"
BEARS S 7 1/2° W, 39.6 FT (AGREES WITH REC.) 1994

9" NOW 11" DIA D. FIR WITH A PARTIALLY HEALED
SINGLE BLAZE SCRIBING VISIBLE "16 S 1/5 BT"
BEARS N 73 1/2° W, 19.1 FT (AGREES WITH REC.) 1994

RENEWAL

Monument Detail

Monument Set (Procedure and Description)

5/8" BY 30" LONG IRON ROD IS
DRIVEN ALONG SIDE FOUND
MAGNETIC MARKER. SET 2"
BELOW CAT ROAD SURFACE

DOUGLAS COUNTY
T 30 S
R
C
B0 | N 4
1 | 1/16
SOUTH 15' W
1998
SURVEYORS

New Accessories

4" DIA. D.FIR DOUBLE BLAZED AND SCRIBED "X BT"
N 77 1/2° E, 17.9 FT

2 3/8" DIA. BRASS CAP ON A 1 3/8" DIA BY 32" LONG IRON PIPE
MARKED AS SHOWN ABOVE, PROTRUDES 9" ABOVE GROUND
BEARS NORTH 15' 0 FT

Sketch of Monument, Accessories, and General Area

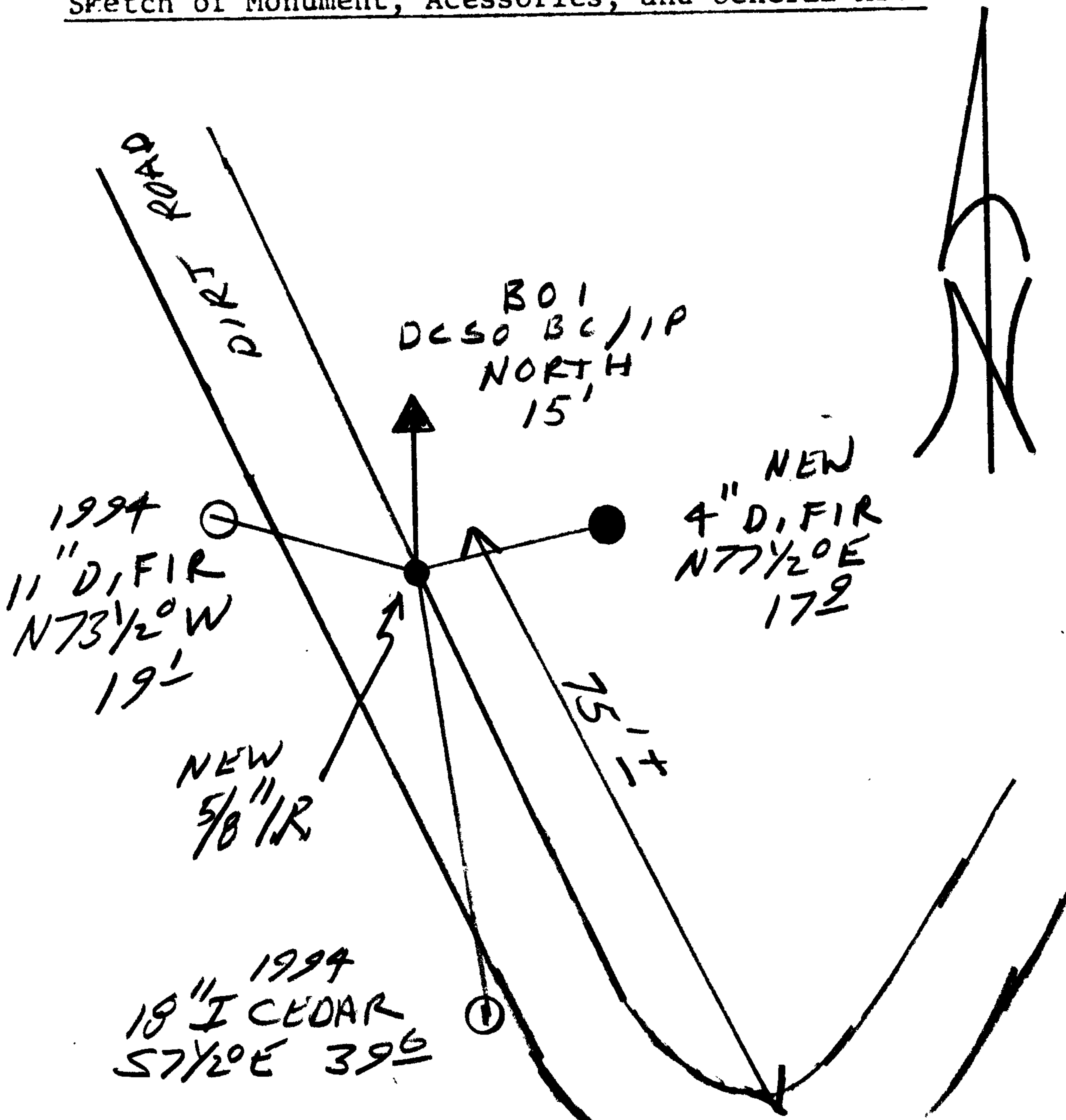

Location & Comments

CORNER FALLS
ALONG EASTERN
EDGE OF CAT ROAD

Comp. Declin. 17 3/4° E
Agency DCSO
Party Chief RANDALL W. SMITH
Notekeeper
Witnesses STEVEN J. FLAUSCH

Address

Surveyor's Seal

REGISTERED
PROFESSIONAL
LAND SURVEYOR

Expires 6-30-2000

OREGON
JULY 25, 1990
RANDALL W. SMITH
2489