

GOVERNMENT CORNER RESTORATION FORM

Date: 5-21-1998 By: JC

Township 31S Range 4W Sec. 13 County DOUGLAS

This survey consists of:

State OR Date 5-20-98

Map: _____
Narrative: _____

Corner Designation

Corner Rpt: 66/2-35

S14 | S13

S23 | S24

DOUGLAS COUNTY SURVEYOR
Condition Report only
 Not Found
 Renewed
 Unrecorded
 Surveyed In
 Referenced Out

Previous Renewals 1958, 1965 DCSO

MONUMENT DETAIL

Monument(s) Found: (Condition and Source)

2 1/2" DIA BRASS CAP ON A 1 1/2" O.D. IRON PIPE PROTRUDING 10" ABOVE GROUND, 1965

COUNTY SURVEYORS OFFICE

T31S R4W

14 | 13

23 | 24
1965

Accessories Found:

5" NOW 16" DIA D.FIR WITH A FULLY HEALED BLAZE BEARS N34°E, 20.8 FT (REC N36°E 22.0 FT) 1965

6" NOW 14" DIA D.FIR WITH A FULLY HEALED DOUBLE BLAZE, BEARS S72°W, 38.3 FT (REC S72°W, 40.3 FT) 1965

32" NOW 33" DIA 2 1/2 HIGH D.FIR STUMP WITH A FULLY HEALED BLAZE, BEARS EAST, 92.3 FT (AGLES WITH REC) 1965

31" NOW BLOW DOWN FOUND NEAR RECORD " N24°20'W, 105.1 FT" 1965

RENEWAL

Monument Set (Procedure and Description)

NONE

Monument Detail

N/A

New Accessories

7" DIA. D.FIR DOUBLE BLAZED AND SCRIBED "T31SR4WS29CSBT"
BEARS S46 1/2° E, 8.0 FT

5" DIA. D.FIR DOUBLE BLAZED AND SCRIBED "XCS BT"
BEARS N53° W, 1.2 FT

Sketch of Monument, Accessories, and General Area

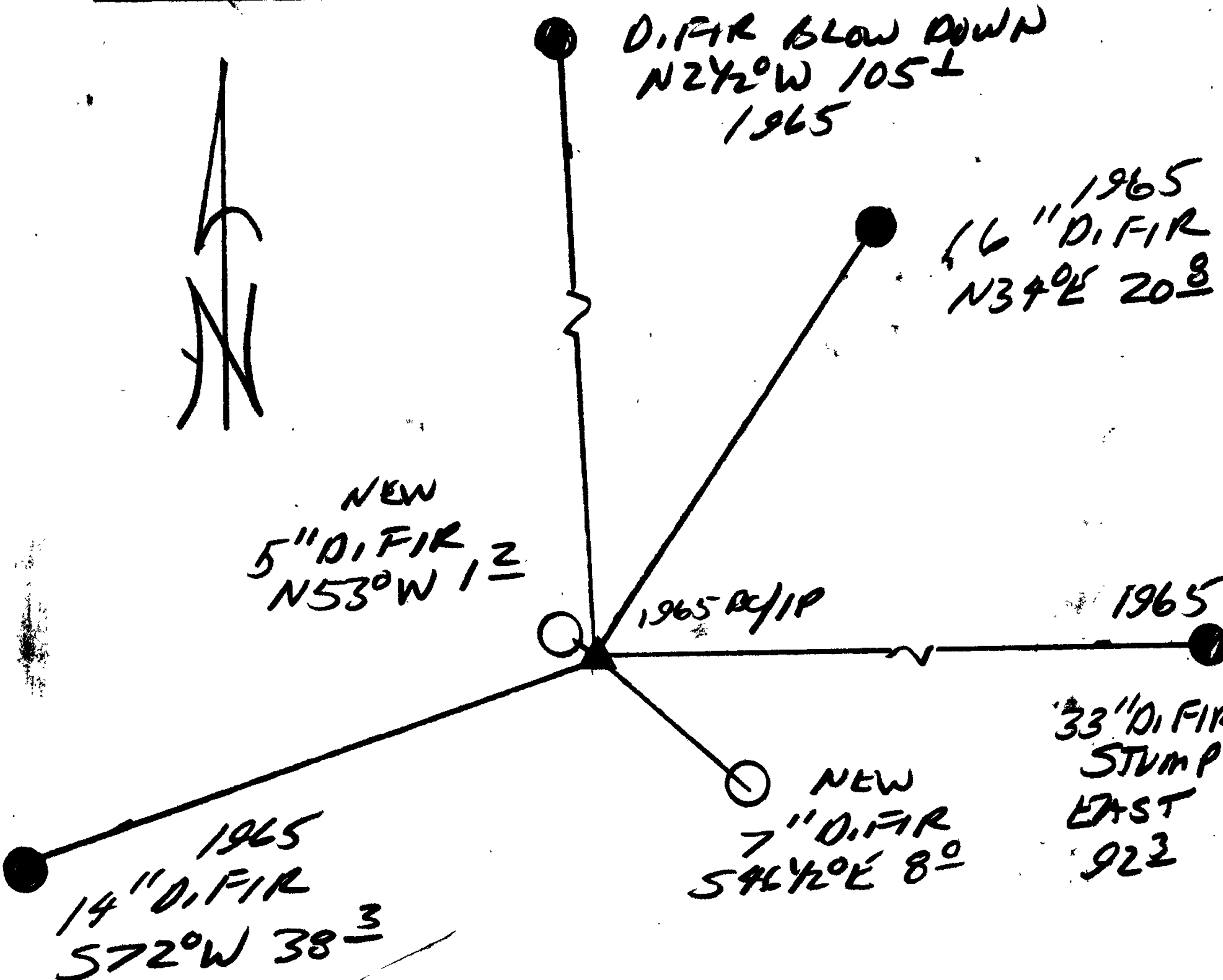

Location & Comments

Comp. Declin. 17 3/4° E
 Agency DCSO
 Party Chief RANDALL W. SMITH
 Notekeeper [Signature]
 Witnesses STEPHEN J. FLANNERY

Address

Surveyor's Seal

REGISTERED
 PROFESSIONAL
 LAND SURVEYOR

[Signature]
 EXPIRES 6-30-98

OREGON
 JULY 25, 1989
 RANDALL W. SMITH
 2489