

GOVERNMENT CORNER RESTORATION FORM

Date: 5-19-1998 By: JC

Township 28S Range 7W Sec. 6

County DOUGLAS

This survey consists of:

State OR

Date 5-13-98

No. _____

Map: _____

Narrative: _____

Corner Rpt: 106/2-29

Corner Designation

W 1/4 SEC 6 ONLY

DOUGLAS COUNTY
Condition Report Only
SURVEYOR

Not Found

Renewed

Unrecorded

Surveyed In

Referenced Out

MONUMENT DETAIL

Previous Renewals 1924 GLO, 1961 DC50

Monument(s) Found: (Condition and Source)

2 1/2" BRASS CAP ON A 1" OD. IRON
PIPK, PROTRUDES 12" ABOVE
GROUND. 1924

U.S. GENERAL LAND OFFICE

1/4
56

1924

SURVEY

Accessories Found:

18" D. FIR NOW ROOT HOLE NEAR RECORD
" N23°E, 30.4 FT" 1924

14" D. FIR NOW ROOT HOLE NEAR RECORD
" S36°E, 24.9 FT" 1924

20" NOW 29" DIA. D. FIR WITH A FULLY HEALED DOUBLE
BLAZE, BEARS N10°E, 34.9 FT (AGREES WITH REC)
1961

12" NOW 25" DIA. D. FIR WITH A FULLY HEALED DOUBLE
BLAZE, BEARS S71°E, 28.7 FT (AGREES WITH REC.)
1961

RENEWAL

Monument Set (Procedure and Description)

Monument Detail

NONE

N/A

New Accessories

13" DIA ALDER SINGLE BLAZED AND SCRIBED "XCSBT"
BEARS N 73 1/2° W, 9.3 FT

15" DIA G. FIR DOUBLE BLAZED AND SCRIBED "Y4S6CSBT"
BEARS N 32 1/2° E, 8.0 FT

Sketch of Monument, Accessories, and General Area

Location & Comments

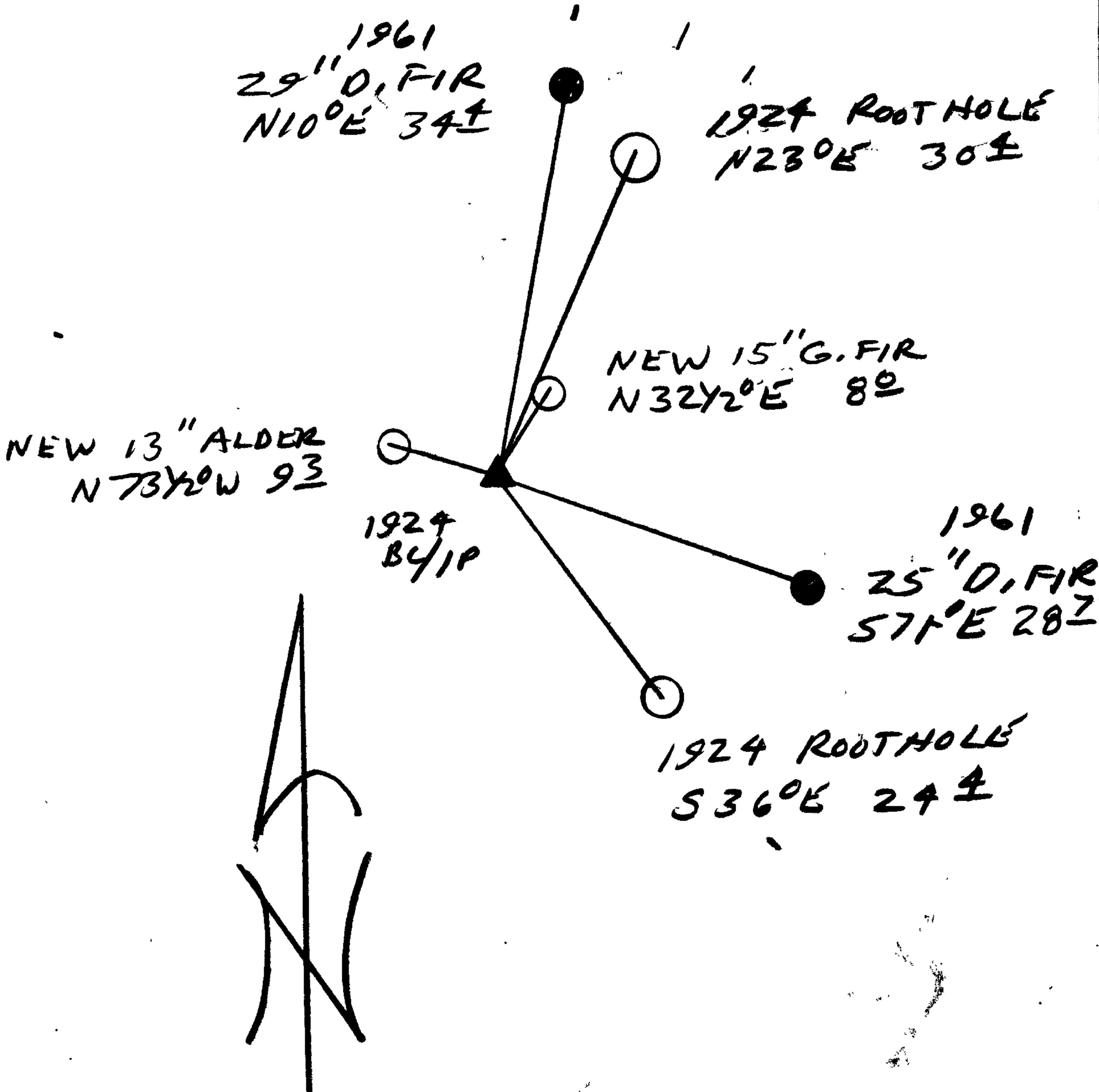

Comp. Declin. 17 3/4° E
 Agency PCSO
 Party Chief RANDALL W. SMITH
 Notekeeper [Signature]
 Witnesses STEPHEN J. FLEWEL

Address

Surveyor's Seal

REGISTERED
PROFESSIONAL
LAND SURVEYOR

[Signature]
EXPIRES 6-30-98

OREGON
JULY 25, 1988
RANDALL W. SMITH
2469