

GOVERNMENT CORNER RESTORATION FORM

Township 285 Range 7W Sec. 1
State OR Date 5-5-98

County DOUGLAS This survey consists of:
Map: _____
Narrative: _____
No. _____

Corner Designation

Corner Rpt: 66612-26

ONLY
S2 | S1

- Condition Report Only
- Not Found
- Renewed
- Unrecorded
- Surveyed In
- Referenced Out

MONUMENT DETAIL

Previous Renewals 1929 GLO, 1961 DC50

Monument(s) Found: (Condition and Source)

NONE FOUND

N/A

Accessories Found:

BENT 3/4" IRON ROD IN FENCE LINE BEARS
S 69 1/2° W, 35.0 FT (REC SOUTH 35.0 FT) 1961

1961 BT NOT FOUND

1929 GLO BRASS CAP IRON PIPE T 27 S R 7 W
BEARS S 86 1/2° W, 516.7 FT
CALL. REC. "S 86° 25' W, 516.7 FT" S 35 | S 36 WC
1924

3/4" IRON PIPE FROM M 59-7 BEARS S 28 1/2° W, 168.8 FT
CALL. REC. "S 28° 33' 55" W, 168.8 FT"

NW CORNER OF OLD HOUSE BEARS S 69 1/2° W
AGREES WITH 1929 GLO RECORD.

RENEWAL

Monument Set (Procedure and Description)

2 3/8" DIA BRASS CAP ON A 1 3/8" BY
 32" LONG IRON PIPE IS SET
 4" BELOW GROUND.

Monument Detail

DOUGLAS COUNTY SURVEYORS
 T28S
 R
 S2 T51 7
 W
 1998
 OFFICE

New Accessories

20" DIA. APPLE TREE, BARK SCRIBED "X BT"
 BEARS S4 1 3/4° W, 97.3 FT.
 13" DIA ASH DOUBLE BLAZED AND SCRIBED "T28S R7W S1 C5 BT"
 BEARS N89° E, 420.0 FT (NOTE BT IS NOT IN SECTION 1)

Sketch of Monument, Accessories, and General Area

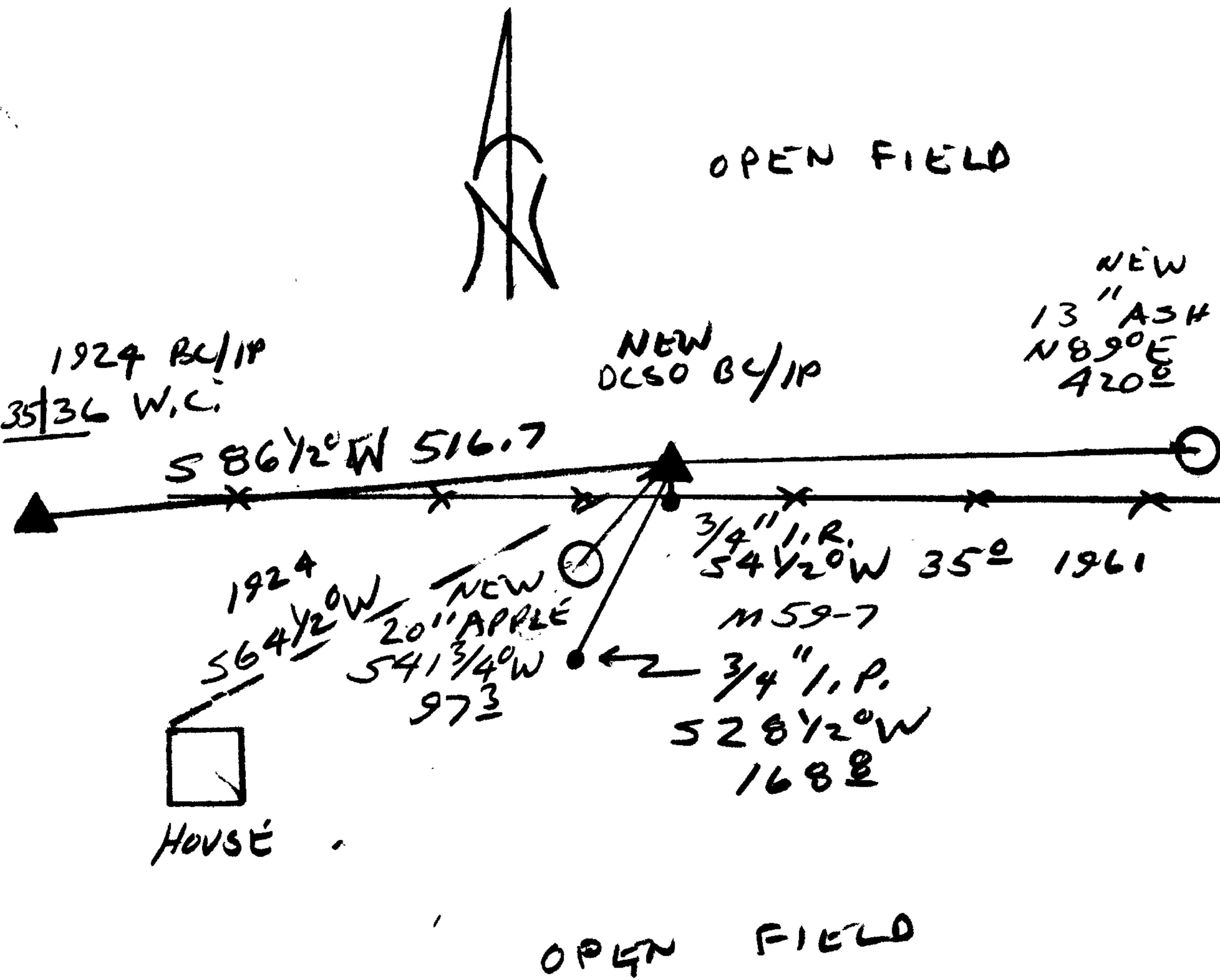

Location & Comments

Comp. Declin. 17 3/4° E
 Agency DCSO
 Party Chief RANDALL W SMITH
 Notekeeper Randall W Smith
 Witnesses STEPHEN J FLAUSK

Address

Surveyor's Seal

REGISTERED
 PROFESSIONAL
 LAND SURVEYOR

Randall W Smith
 EXPIRES 6-30-98

OREGON
 JULY 25, 1990
 RANDALL W. SMITH