



RENEWAL

Monument Set (Procedure and Description)

Monument Detail

5/8" BY 32" LONG IRON ROD  
 WITH DC50 ALUM. CAP IS  
 SET AT PREPARTIONED POSITIONING  
 PROTRUDES 13" ABOVE GROUND

N 1/16

1998

New Accessories

21" D. FIR DOUBLE BLAZED AND SCRIBED "N 1/16 S 8 CS BT"  
 BEARS N 37° E, 37.0 FT

40" D. FIR SINGLE BLAZED AND SCRIBED "N 1/16 S 8 CS BT"  
 BEARS S 7° W, 3.5 FT

6" ALDER BARK SCRIBED "N 1/16 S 8 CS BT" BEARS  
 N 29 1/2° W, 8.0 FT

Sketch of Monument, Accessories, and General Area

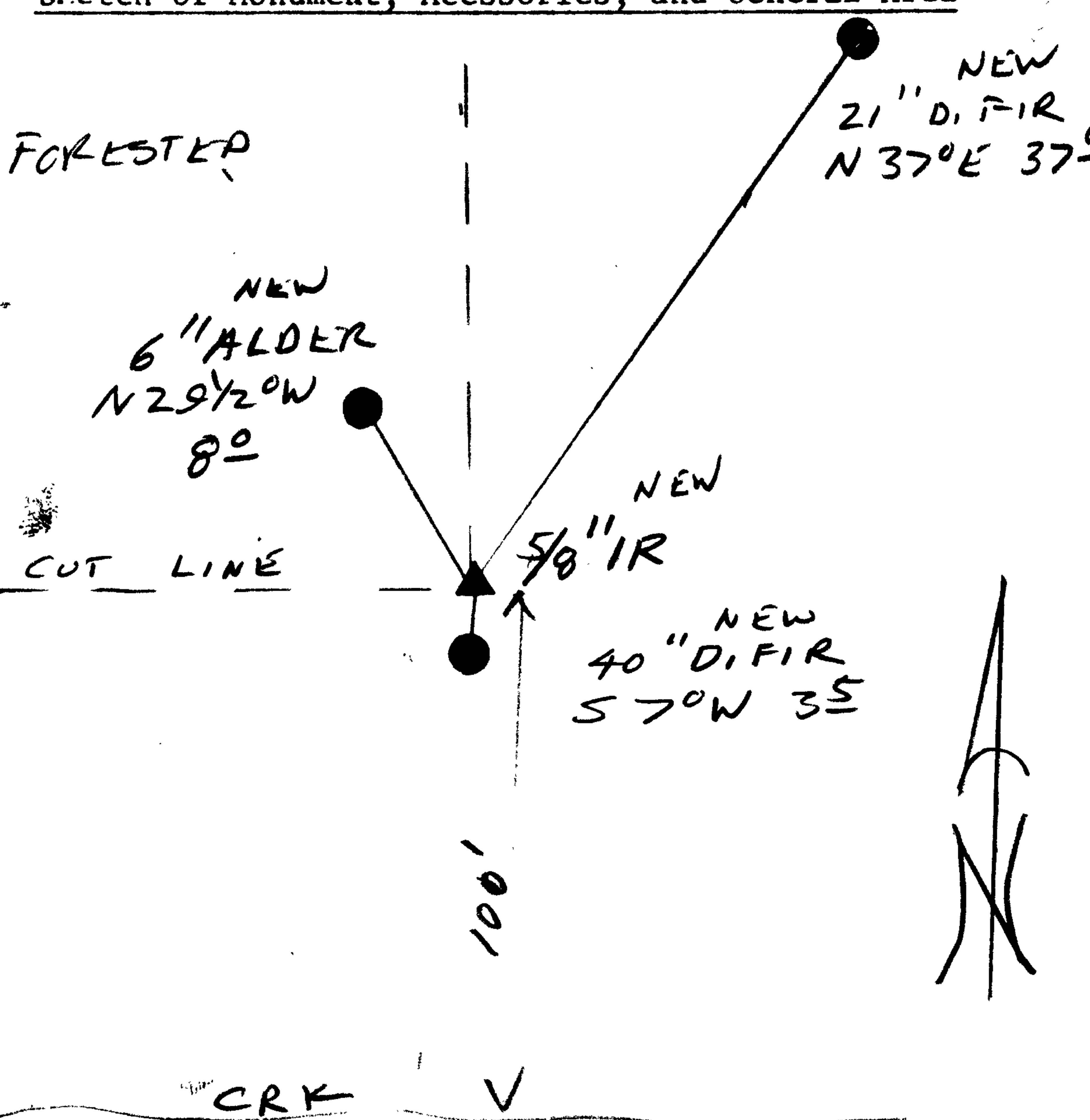

Location & Comments

IRON ROD DRIVEN  
 THROUGH ROOT OF  
 SW BT CORNER  
 LIES APPROX 80 FT  
 NORTH OF A E-N  
 RUNNING CREEK

Comp. Declin. 17 3/4° E  
 Agency DC50  
 Party Chief GARY W. HANKEW  
 Notekeeper  
 Witnesses

Address

Surveyor's Seal

REGISTERED  
 PROFESSIONAL  
 LAND SURVEYOR

OREGON  
 JULY 25, 1990  
 RANDALL W. SMITH  
 2489

EXPIRES 6-30-98