

GOVERNMENT CORNER RESTORATION FORM

Date: 4/14/1998 By: X

This survey consists of:

Township 30S Range 6W Sec. 21 County DOUGLAS Map: _____

State OR Date 3-31-98 No. _____ Narrative: _____

Corner Designation _____

Corner Rpt: 166/2-9

DOUGLAS COUNTY SURVEYOR

- ____ Condition Report Only
- ____ Not Found
- Renewed
- ____ Unrecorded
- ____ Surveyed In
- ____ Referenced Out

MONUMENT DETAIL

$\frac{1}{4}$ $\frac{S21}{S28}$

Previous Renewals 1963 + 1969 DCSO, 1989 JOHNSTON &

Monument(s) Found: (Condition and Source)

NONE

(CORNER FALLS IN OLD CAT ROAD.)

N/A

Accessories Found:

12" NOW 12" DIA DOWN AND ROTTING MADRONA SCRIBING VISIBLE ON UNHEALED DOUBLE BLAZE, "YASZICS BT" A CLUSTER OF SMALL MADRONES FOUND NEAR RECORD "N35°E 13.5 FT" 1969

13" NOW 19" DIA MADRONA WITH A PARTIALLY HEALED ROTTED DOUBLE BLAZE, NO SCRIBING VISIBLE, BEARS S83°W, 17.2 FT (AGREES WITH REC.) 1963

19" NOW 19" DIA MADRONA WITH AN UNHEALED SINGLE BLAZE SCRIBING VISIBLE "YAS BT", A NAIL WITH BRASS WASHER MARKED "RLS 498" SET IN BLAZE, ROOT CROWN BEARS S83 1/2°E, 66.0 FT (REC S80°E, 66.0 FT) 1989

C.S. File No. 166/2-9

RENEWAL

Monument Detail

Monument Set (Procedure and Description)

2 3/8" DIA BRASS CAP ON A 1 3/8" O.D
BY 32" LONG IRON PIPE IS
SET AT A POSITION DETERMINED
BY FOUND 1ST'S. PROTRUDES 5"
ABOVE GROUND.

DOUGLAS COUNTY SURVEYORS OFFICE

T 30 S

R 6 W

S 21

S 28

1998

New Accessories

6" DIA. MADRONE, DOUBLE BLAZED AND SCRIBED " 1/4 S 21 CS BT"
BEARS N 34° E, 12.1 FT

18" DIA. W. OAK DOUBLE BLAZED AND SCRIBED " 1/4 S 21 CS BT"
BEARS N 19° W, 77.1 FT

Sketch of Monument, Accessories, and General Area

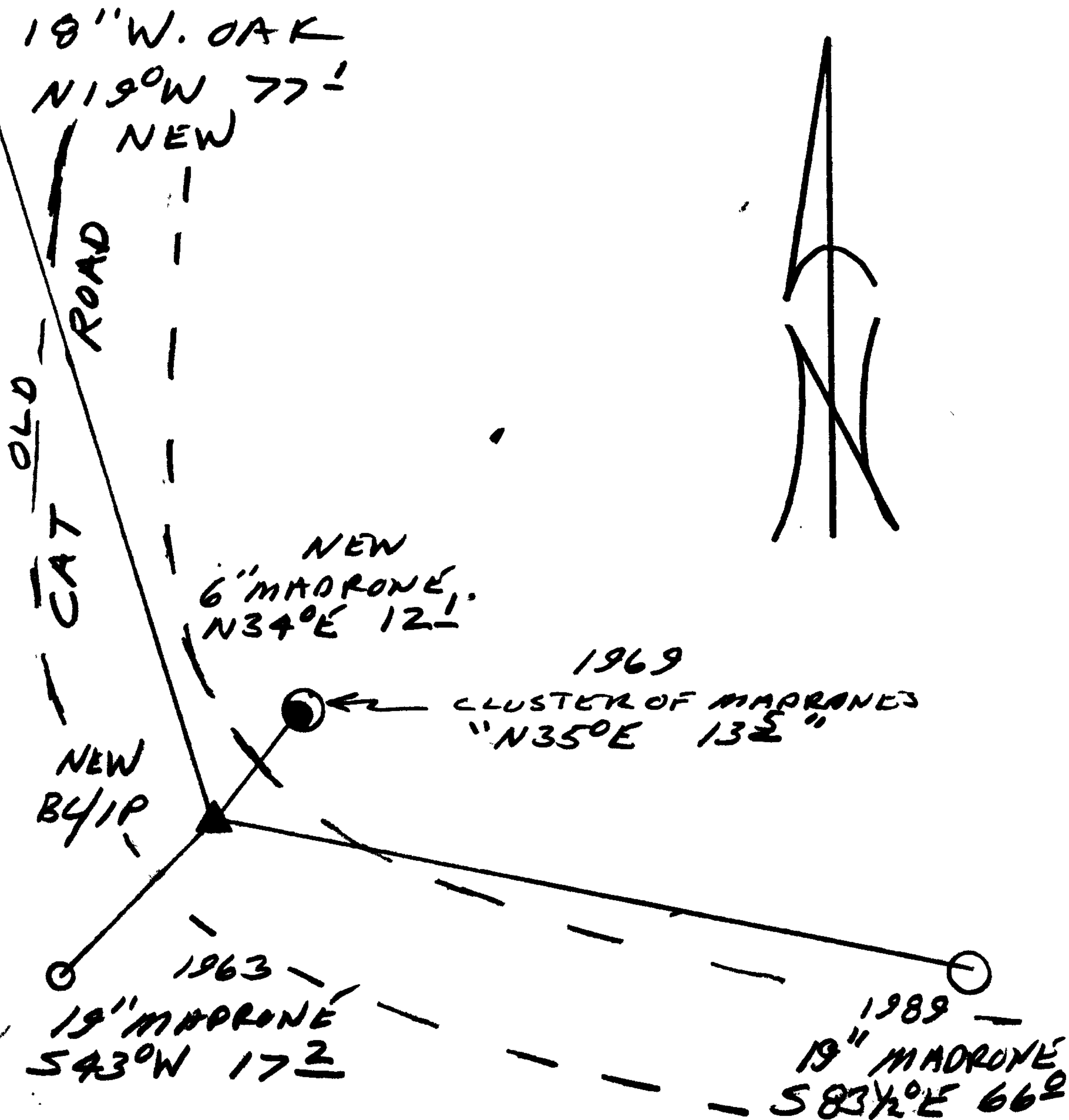

Location & Comments

CORNER LIES IN OLD
CAT ROAD

Comp. Declin. 17 3/4° E

Agency DCSO

Party Chief RANDALL W SMITH

Notekeeper [Signature]

Witnesses STEPHEN J FLAISE

Address

Surveyor's Seal

REGISTERED
PROFESSIONAL
LAND SURVEYOR

Randall W Smith
EXPIRES 6-30-99

OREGON
JULY 25, 1990
RANDALL W. SMITH
2400