

OREGON CORNER RESTORATION FORM

SECTION 8 TOWNSHIP 24 S. RANGE 7 W
 COUNTY DOUGLAS DATE 6/2020 TRACT LOVEGREN 2
 POINT IDENTIFIER 240600

CORNER DESIGNATION:

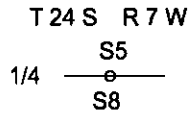

- _____ CONDITION REPORT ONLY
- _____ NOT FOUND
- _____ X RENEWED
- _____ UNRECORDED
- _____ SURVEYED IN
- _____ REFERENCED OUT

PREVIOUS RENEWALS/SURVEYS, ETC:

BLM RESURVEY BY WHITE AND BECK DOUGLAS COUNTY RECORDS VOL. 32 PAGES 13483-84, HOFFINE MAP OF SURVEY M138-42

ACCESSORIES FOUND: (CONDITION AND SOURCE)

24" DOUGLAS-FIR FOUND AT RECORD N44 1/2°E 54.8 FT. (RECORD FROM HOFFINE MAP 138-42.) HEALED FACE AND BLM TAG
 14' DOUGLAS-FIR FOUND AT RECORD S37 1/2°E 24.2 FT. (RECORD FROM HOFFINE MAP 138-42.) HEALED FACE AND LONE ROCK TAG
 RECORD 24" DOUGLAS-FIR STUMP NOW REMOVED BY ROAD CONSTRUCTION.

MONUMENT DETAIL:

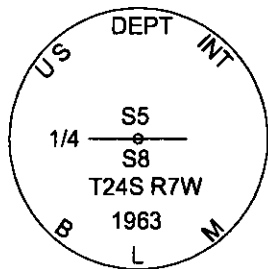

SKETCH:
(NOT TO SCALE)

- LEGEND:**
- / — LINES RE-BLAZED, PAINTED AND FLAGGED
 - ⊙ FND 1963 BLM BRASS CAP

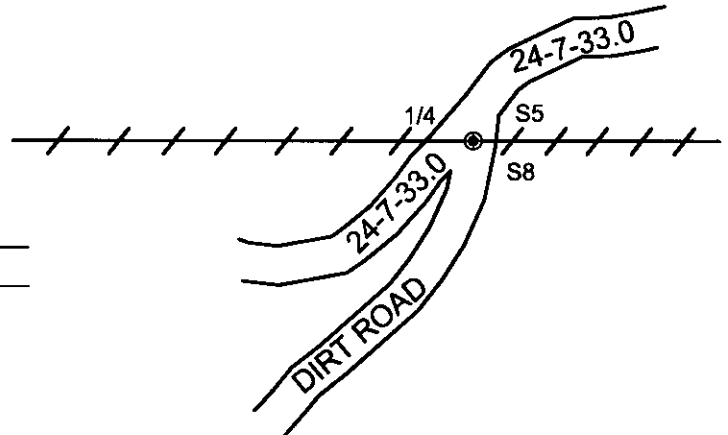

MONUMENT:

FOUND 1963 BUREAU OF LAND MANAGEMENT BRASS CAP 0.6 FEET BELOW GROUND LEVEL.

NEW ACCESSORIES:

14" DOUGLAS-FIR BEARS N36°W 43.1 FT. WE SCRIBE 1/4 S5 BT AND TAG TREE
 12" DOUGLAS-FIR BEARS S31°W 25.4 FT. WE SCRIBE 1/4 S8 BT AND TAG TREE

LOCATION & COMMENTS:

WE REMARKED THE NORTH LINE OF SECTION 8 USING EXISTING BLAZES AND TAGS FROM A POINT (NEAR AN EXISTING ROCK LOGGING ROAD) APPROXIMATELY 1800 FEET WEST OF THE 1/4 CORNER BETWEEN SECTIONS 5 AND 8 TO A POINT (IN A CREEK) APPROXIMATELY 200 FEET OF THE 1/4 CORNER. WE FIND THE 1963 BLM BRASS CAP BURIED NEAR THE JUNCTION OF THE ROCK 24-7-33.0 ROAD IN AN EXISTING DIRT LOGGING ROAD 0.6 FEET BELOW GROUND LEVEL

BEARING BASIS: ASSUMED FROM HAND COMPASS
 DECLINATION 17° EAST
FIRM/AGENCY: LONE ROCK TIMBER MANAGEMENT CO.
ADDRESS: P.O. BOX 1127
 ROSEBURG, OR 97470
PARTY CHIEF: KEN W. HOFFINE
NOTES: DANIEL SAILY
WITNESS: IGNACIO ROMAN

FILED
 Date: 7-6-2020 By: JK
 This survey consists of:
 Map: _____
 Narrative: _____
 Corner Rpt: CS 65/106-39

REGISTERED
 PROFESSIONAL
 LAND SURVEYOR

Ken W Hoffine

OREGON
 JULY 16, 1987
 KEN W. HOFFINE
 PLS 2291

DOUGLAS COUNTY
 SURVEYOR

C.S. FILE 65/106-39

EXPIRES 6-30-21