

FILED

Date: 6/30/2020 By: SC
This survey consists of:

Map: _____

Narrative: _____
Corner Rpt: CS65/106-33

CORNER REPORT FORM

Section 36 Township 30S Range 3W
Douglas County Date 6-2020
PLSS Number 700100

DOUGLAS COUNTY
SURVEYOR

CORNER DESIGNATION

S.E. COR. SEC. 36/31

- Condition Report only
- Not Found
- Renewed
- Unrecorded
- Surveyed In
- Referenced out

Previous Renewals/Surveys, etc:

DCSO Sept. 1976 C.S. 59/24-12

Monument(s) & Accessories Found: (Condition and Source)

DCSO BRASS CAP
38" X 4' CAPPED FIR STUMP N159 1/2 E 64 1/2 FT GOOD SCAR
37" X 6' CEDAR STUMP N16 1/4 W 48 1/2 FT
ROTTEN LOG REMNANT & ROOTHOLE TIN CAP ON GROUND
N80 E 34 1/2 FT

Monument Detail

Sketch

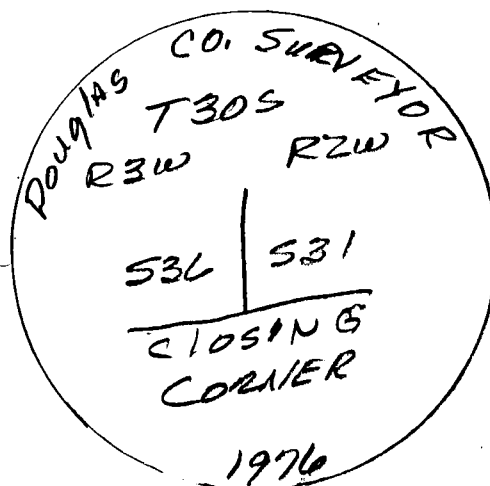

Monument Set (Procedures and Description)

New Accessories

<u>9" FIR N56 E 16 1/2 FT</u>	<u>Scribed T30S R2W 531 CC BT</u>
<u>7" FIR N35 E 12 1/2 FT</u>	<u>Scribed T30S R2W 531 CC BT</u>
<u>10" FIR N9W 43 1/2 FT</u>	<u>Scribed T30S R3W 536 CC BT</u>
<u>11" FIR N4W 11 1/2 FT</u>	<u>Scribed T30S R3W 536 CC BT</u>

Surveyor's Seal

Location & Comments

Compass Declination 1 1/2 E
Firm/Agency: i.e. Engineering, Inc.
Address: 809 SE Pine St., Roseburg, OR 97470

Party Chief: N. Fromdahl

Notes:

Witness: L. Hedden

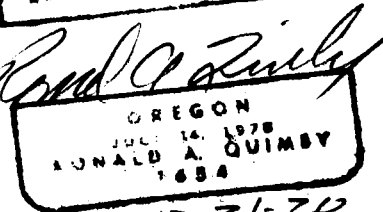
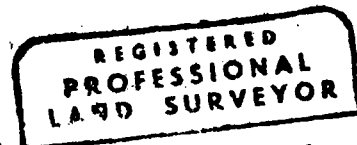

EXP 12-31-20

C.S. File 05/106-33