

FILED
Date: 6/30/2020 By: SC
This survey consists of:

Map: _____
Narrative: _____
Corner Rpt: CS 69/106-31

DOUGLAS COUNTY
SURVEYOR

- Condition Report only
- Not Found
- Renewed
- Unrecorded
- Surveyed In
- Referenced out

CORNER REPORT FORM

Section 36 Township 30S Range 3W
Douglas County Date 6-2020
PLSS Number
633100

CORNER DESIGNATION

CLOSING CORNER $\frac{536}{52/51}$

Previous Renewals/Surveys, etc:

MARKHAM 1959 CS 42/392 DCSO 1965 CS 52/63
KLEIN 2015 M 166-40A-1 QUIMBY 2015 CS 65/89-27

Monument(s) & Accessories Found: (Condition and Source)

DCSO BRASS CAP
10" FIR S21°E 22.3 FT GOOD SCAR
9" FIR S19°W 7.7 FT GOOD SCAR

Monument Detail

Sketch

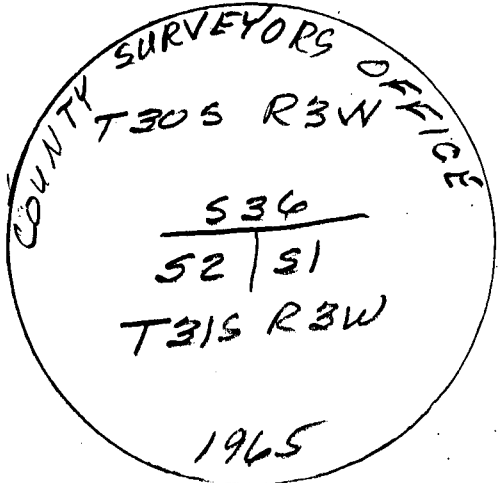

Monument Set (Procedures and Description)

New Accessories

5/8" x 30" I. Rods with yellow plastic cap
STAMPED 16 ENGINEERING ALUM POST
N 41° E 5' Along side caps
5 35° E 4' S 40° W 5'
N 26° W 5'

Surveyor's Seal

Location & Comments

COR IS ALONG EAST
EDGE OF NEW CLEAR
CUT UNIT

Compass Declination 15 1/2° E
Firm/Agency: i.e. Engineering, Inc.
Address: 809 SE Pine St., Roseburg, OR 97470

Party Chief: N. Fromdah
Notes:
Witness: L. Hedden



BRP 12-31-20

C.S. File 65/106-31