

FILED

Date: 6/30/2020 By: SC

This survey consists of:

Map: _____

Narrative: _____
Corner Rpt: CS 65/106-27

DOUGLAS COUNTY
SURVEYOR

CORNER REPORT FORM

Section 36 Township 30S Range 3W
Douglas County Date 6-2020
PLSS Number 700200

CORNER DESIGNATION

East Cor. 25
36

- Condition Report only
- Not Found
- Renewed
- Unrecorded
- Surveyed In
- Referenced out

Previous Renewals/Surveys, etc:

mench contract #782 1968 10/16 pgs 6867-68
DCSO 1939 CS 16/11 DCSO 1958 CS 49/BC

Monument(s) & Accessories Found: (Condition and Source)

DCSO BRASS CAP
28" Rotted FIR STUMP N55°W 23° FT
23" Rotted Cedar STUMP N68°E 17° FT
72" X 4" FIR STUMP N33°E 145 FT (FACE BURNT OUT/HOLLOW)
3/4" I. PIPE S1°E 46 1/2 FT

Monument Detail

Sketch

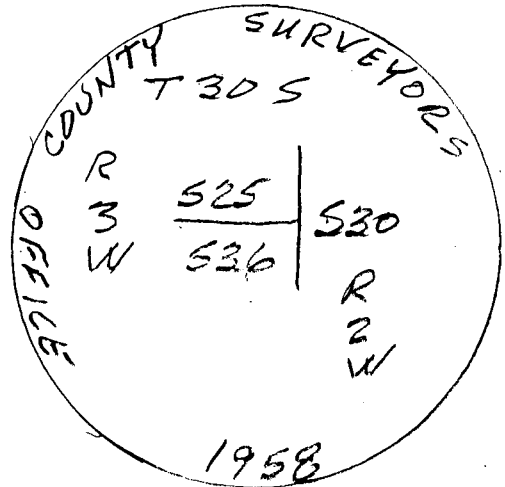

Monument Set (Procedures and Description)

New Accessories

13" Hemlock S 30°E 15 1/2 FT Scribed T30S R3W 536 BT
11" Hemlock S 53°W 22° FT Scribed T30S R3W 536 BT
Alum Post S° South & S° West.

Surveyor's Seal

Location & Comments

Compass Declination 15 1/2° E
Firm/Agency: i.e. Engineering, Inc.
Address: 809 SE Pine St., Roseburg, OR 97470

Party Chief: N. Fromdahl

Notes:

Witness: L. Hedden

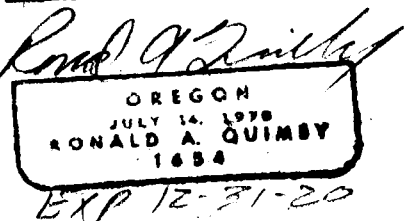
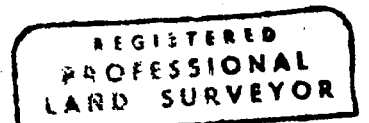

C.S. File 65/106-27

