

FILED

Date: 5/14/2020 By: JC

This survey consists of:

Map: _____

Narrative: _____

Corner Rpt: CS 65/106-19

**DOUGLAS COUNTY
SURVEYOR**

CORNER INVESTIGATION REPORT

FS INDEX ID: C-9

<u>CORNER:</u> 1/4	<u>GCDB ID:</u> 300640	<u>DATE:</u> 2/10/2020
<u>TOWNSHIP:</u> 32 S	<u>STATE:</u> OREGON	
<u>RANGE:</u> 1 W	<u>COUNTY:</u> DOUGLAS	
<u>SECTION:</u> 4 & 5	<u>FOREST:</u> UMPQUA	
<u>MERIDIAN:</u> WILLAMETTE	<u>DISTRICT:</u> TILLER	

NFSL PROPERTY BOUNDARY CORNER?: YES NO

LINE(S) POSTED: NORTH - 1980 EAST - 1980

MAINTAINED: NORTH -*2018* EAST -*2018*

GUARD POST(S): EAST-4 FT NORTH-2 FT

CORNER HISTORY:

- (1) ESTABLISHED CORNER, SET STONE WITH 2 BT'S.
- (2) FOUND STONE & 2 BT'S, SET IRON PIPE/BRASS CAP.
- (3) FOUND IRON PIPE/BRASS CAP & 2 BT'S.
- (4) FOUND IRON PIPE/BRASS CAP & 2 BT'S.

MONUMENT FOUND/SET:

A 1-1/2" IRON PIPE WITH A 2-1/2" BRASS CAP, PROJECTING 12 INCHES ABOVE THE GROUND.

RECORD CORNER ACCESSORIES:

- A 24" FIR WITH A HEALED DOUBLE BLAZE.
- A 23" FIR WITH A HEALED DOUBLE BLAZE.

NEW CORNER ACCESSORIES:

NO NEW ACCESSORIES ADDED.

CORNER MAINTENANCE/OTHER INFO:

CLEAR BRUSH FROM AROUND MONUMENT & TO BT'S, BT FACES & A 6" BAND AT HEAD HEIGHT PAINTED RED. ADD NEW NAILS TO BT TAGS & ADD NEW TAGS WHERE NEEDED. MONUMENT SIZES ARE OUTSIDE DIAMETER & BT DIAMETERS ARE AT BREST HEIGHT.

*NOTE: LINE MAINTAINED ~500 FT NORTH & ~500 FT WEST

NFSL LINES BEAR: (3)S81°34'27.4"E - 1301.37 FT & (3)N1°03'17"E - 2534.08 FT

GEODETIC COORDINATES:

LATITUDE: N 42° 49' 03.617"

LONGITUDE: W 122° 50' 04.115"

ELLIPSOID HEIGHT:

DATUM: WGS84

SOURCE: CONSUMER GRADE GPS, FOR NAVIGATION TO THE CORNER.

DATE OF INVESTIGATION: 05/10/2018

REPORT BY: JONATHAN B. DREW II, PLS# 89396

FIELD CREW: JACOB HUNT, USFS SURVEY TECH
ANDREW HILLMAN, USFS SURVEY TECH

DOCUMENTS ON FILE AT:

WILLAMETTE NATIONAL FOREST
3106 PIERCE PARKWAY, STE D
SPRINGFIELD, OREGON 97477

HISTORY OF VISITATIONS:

- (1) 1883 - R.S. MOORE, GLO SURVEY
- (2) 1968 - J. POWELL, CS 54/71
- (3) 1980 - B. SHANER, RM 3-36
- (4) 1989 - G.V. NYGREN, USFS CORNER CARD

REGISTERED
PROFESSIONAL
LAND SURVEYOR

Jonathan B. Drew II

OREGON
DECEMBER 3, 2014
JONATHAN B. DREW II
89396

EXPIRES: 6/30/2021

RECORD MEASUREMENTS:

(1,2,3,4)N68°W - 17.82 FT

(1,2,3,4)S56°E - 15.84 FT

METHOD OF MEASUREMENT:

NO NEW MEASUREMENTS TAKEN,
FILED AS CONDITION REPORT.

CAP DIAGRAM:

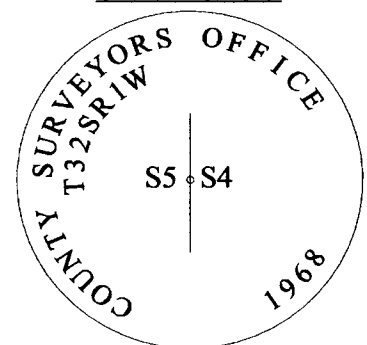

THIS DOCUMENT FILED IN CS OFFICE: YES
OTHER DOCUMENT FILED WITH CS: NONE

C.S. FILE 65/106-19