

FILED

Date: 5/14/2020 By: JC

This survey consists of:

Map: _____

Narrative: _____

Corner Rpt: CS 65/106-11

CORNER INVESTIGATION REPORT

**DOUGLAS COUNTY
SURVEYOR**

FS INDEX ID: 0-19

CORNER: CENTER-NORTH 1/16 GCDB ID: 540360 DATE: 2/10/2020

TOWNSHIP: 31 S STATE: OREGON

RANGE: 2 W COUNTY: DOUGLAS

SECTION: 23 FOREST: UMPQUA

MERIDIAN: WILLAMETTE DISTRICT: TILLER

NFSL PROPERTY BOUNDARY CORNER?: YES NO

LINE(S) POSTED: NORTH - 1975 WEST - 1975

MAINTAINED: NORTH - NONE WEST - 2018

GUARD POST(S): NORTH - 3.0 FT WEST - 2.5 FT

CORNER HISTORY:

(1) ESTABLISHED CORNER BY SURVEY, SET IRON PIPE/BRASS CAP WITH 2 BT'S.

HISTORY OF VISITATIONS:

(1) 1975 - G.S. BAUGHMAN, M-56-5 & CS 58/30

REGISTERED
PROFESSIONAL
LAND SURVEYOR

Jonathan B. Drew II

OREGON
DECEMBER 3, 2014
JONATHAN B. DREW II
89396

EXPIRES: 6/30/2021

RECORD MEASUREMENTS:

(1) S21°E - 41.4 FT

(1) S74°W - 73.7 FT

MONUMENT FOUND/SET:

A 2-1/2" IRON PIPE WITH A 3" BRASS CAP, PROJECTING 2 INCHES ABOVE A COLLAR OF STONE.

RECORD CORNER ACCESSORIES:

A 26" CEDAR WITH A HEALED DOUBLE BLAZE.

A 21" MADRONE WITH A HEALED DOUBLE BLAZE.

NEW CORNER ACCESSORIES:

NO NEW ACCESSORIES ADDED.

METHOD OF MEASUREMENT:

NO NEW MEASUREMENTS TAKEN,
FILED AS CONDITION REPORT.

CORNER MAINTENANCE/OTHER INFO:

CLEAR BRUSH FROM AROUND MONUMENT & TO BT'S, BT FACES & A 6" BAND AT HEAD HEIGHT PAINTED RED. ADD NEW NAILS TO BT TAGS & ADD NEW TAGS WHERE NEEDED. MONUMENT SIZES ARE OUTSIDE DIAMETER & BT DIAMETERS ARE AT BREST HEIGHT.

NFSL LINES BEAR: (1)N0°26'23"E - 1341.21 FT & (1)N89°24'59"W - 2669.75 FT

GEODETIC COORDINATES:

LATITUDE: N 42° 52' 08.279"

LONGITUDE: W 122° 54' 46.944"

ELLIPSOID HEIGHT:

DATUM: WGS 84

SOURCE: USFS OWNERSHIP GIS LAYER, FOR NAVIGATION TO THE CORNER.

DATE OF INVESTIGATION: 05/14/2018

REPORT BY: JONATHAN B. DREW II, PLS# 89396

FIELD CREW: JACOB HUNT, USFS SURVEY TECH
ANDREW HILLMAN, USFS SURVEY TECH

DOCUMENTS ON FILE AT:

WILLAMETTE NATIONAL FOREST
3106 PIERCE PARKWAY, STE D
SPRINGFIELD, OREGON 97477

THIS DOCUMENT FILED IN CS OFFICE: YES
OTHER DOCUMENT FILED WITH CS: NONE

CAP DIAGRAM:

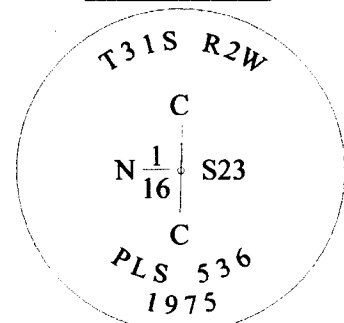

C.S. FILE 65/106-11