

BOUNDARY SURVEY IN
SOUTHEAST 1/4 OF SECTION 8, T21S, R5W, W.M.
DOUGLAS COUNTY, OREGON
 JULY 25, 2019

FILED
 Date: 10-15-19 By: DJ
 This survey consists of:
 Map: C.S. 65/103-010
 Narrative: _____
 Corner Rpt: _____
DOUGLAS COUNTY
SURVEYOR

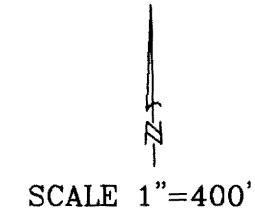

① **C-E 1/16 CORNER SECTION 8, T21S, R6W, WM**
 FOUND: 1" X 1" "T" IRON PER M7-66
 49" FIR SNAG, S21°E, 30.5' TO CENTER-
 M7-66 BEARING TREE (RECORD=S20°E, 30.5')
 49" CEDAR, S27°W, 27.5' TO CENTER-
 M7-66 BEARING TREE (RECORD=S28°W, 27.5')
 MARKED: 16" FIR, EAST, 15.8' TO SPIKE SIDE/CENTER-
 SCRIBED "CE1/16S8 BT"
 5 FOOT METAL POST ALONGSIDE CORNER

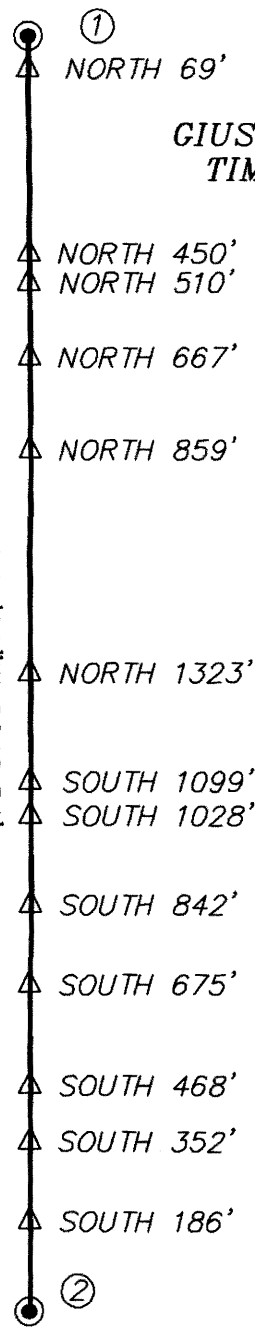

**GIUSTINA LAND &
 TIMBER COMPANY**

-NARRATIVE-

THIS SURVEY WAS MADE IN APRIL AND JULY, 2019 FOR SENECA JONES TIMBER COMPANY IN THE SOUTHEAST 1/4 OF SECTION 8, TOWNSHIP 21 SOUTH, RANGE 5 WEST, WILLAMETTE MERIDIAN. THE PURPOSE OF THIS SURVEY WAS TO LOCATE AND MARK IN THE FIELD, THE NORTH-SOUTH CENTERLINE OF THE SOUTHEAST 1/4 OF SECTION 8 BETWEEN FOUND MONUMENTS ESTABLISHED IN M7-66. THE BASIS OF BEARING FOR THIS SURVEY WAS THE NORTH-SOUTH CENTERLINE OF THE SOUTHEAST 1/4 OF SECTION 8, TOWNSHIP 21 SOUTH, RANGE 5 WEST, WILLAMETTE MERIDIAN BETWEEN THE FOUND CENTER-EAST 1/16 CORNER OF SECTION 8 AND THE EAST 1/16 CORNER COMMON TO SECTIONS 8 AND 17 PER M7-66. A RANDOM TRAVERSE WAS RUN BETWEEN THE FOUND CENTER-EAST 1/16 CORNER OF SECTION 8 AND THE EAST 1/16 CORNER COMMON TO SECTIONS 8 AND 17, WITH AN ERROR OF CLOSURE OF 1' IN 36,000' PRIOR TO ANGULAR ADJUSTMENT. BOTH THE FOUND CENTER-EAST 1/16 CORNER OF SECTION 8 AND THE EAST 1/16 CORNER COMMON TO SECTIONS 8 AND 17 WERE MONUMENTED WITH "T" IRONS SET IN M7-66. THE TRUE PROPERTY LINE WAS MARKED BY BLAZING TREES ON EITHER SIDE OF THE TRUE PROPERTY LINE (BLAZES PAINTED RED) AND BY SETTING 5 FOOT METAL POSTS AT RANDOM INTERVALS ALONG THE TRUE PROPERTY LINES AS SHOWN. NO NEW CORNERS WERE ESTABLISHED IN THIS SURVEY AND A NEW BEARING TREE WAS ADDED AT THE CENTER-EAST 1/16 CORNER.

REGISTERED
 PROFESSIONAL
 LAND SURVEYOR

**SENECA JONES
 TIMBER COMPANY**

Daniel W. Baker
 OREGON
 JULY 16, 1982
 DANIEL W. BAKER
 1978

I CERTIFY THAT THIS MAP WAS PREPARED USING A HP51645A INK CARTRIDGE ON JPC-4M2 DOUBLE MATTE FILM

EXPIRES 12/31/19

BASIS OF BEARING: NORTH-SOUTH CENTERLINE OF THE SE1/4 OF SECTION 8 PER M7-66

LEGEND

- - FOUND - 1"x 1" "T" IRON PER M7-66
- - BLAZED AND PAINTED PROPERTY LINE
- () - RECORD DATA - M7-66
- △ - 5 FOOT STEEL POSTS SET ON PROPERTY LINE (DISTANCES AND CARDINAL DIRECTION ARE FROM THE NEAREST CORNER I.E. = SOUTH 123')

② **EAST 1/16 CORNER SECTIONS 8 & 17, T21S, R6W, WM**

FOUND: 1"X 1" "T" IRON PER M7/66
 14" FIR, S64°E, 13.6' TO CENTER-CS65/63-19 BEARING TREE (RECORD=S64°E, 13.6')
 12" FIR, N11°W, 7.1' TO CENTER-CS65/63-19 BEARING TREE (RECORD=N6°W, 6.9')

ASSESSOR'S MAP 21-05-00 TAX LOT 1200

BOUNDARY SURVEY IN SOUTHEAST 1/4 OF SECTION 8, T21S, R5W, W.M. DOUGLAS COUNTY, OREGON	
CLIENT: SENECA JONES TIMBER COMPANY	
DRAWN BY: DWB	BAKER AND ASSOCIATES, SURVEYORS 1347 MARKET STREET SPRINGFIELD, OREGON (541) 343-7243
DATE: 7/25/19	
FILE: SENECA-210508	