

**PROPERTY SURVEY  
SECTION 21, T28S, R08W, W.M.  
DOUGLAS COUNTY, OREGON  
JANUARY 2019**

**SURVEY BY:**  
HOSTETTER LAND SURVEYING  
63538 PINTAIL DR.  
COOS BAY, OREGON 97420

**SURVEY FOR:**  
WEYERHAEUSER COMPANY  
63459 OLIVE BARBER ROAD  
COOS BAY, OREGON 97420

**NARRATIVE:**  
THE PURPOSE OF THIS SURVEY WAS TO MARK WEYERHAEUSER COMPANY PROPERTY LINE IN SECTION 21, T28S, R8W, W.M. AS SHOWN. BEARING TREE TAGS PLACED ON NEW BTS LIST THE MEASUREMENT FROM A 6" SPIKE, PLACED BELOW THE "X", TO THE CORNER MONUMENT. BEARINGS ARE BASED ON A 1980 BLM SURVEY AS SHOWN.

**EQUIPMENT:** NIKON NIVO C3 TOTAL STATION.

**FOUND:** 1973 BLM BRASS CAP AS DESCRIBED ( DSCO VOL.36, PG. 15077) FROM WHICH:  
27" FIR, FACE EVIDENT, BLM TAG, BEARS; N 66°E, 25.1 FEET TO CENTER.  
18" FIR, FACE EVIDENT, BLM TAG, BEARS; N 49°W, 46.2 FEET TO CENTER.  
**NEW BTS:**  
9" FIR, MARKED "X", BT TAG, S4°E, 5.5 FEET TO SPIKE.  
13" FIR, MARKED "X", BT TAG, S51°E, 10.9 FEET TO SPIKE.  
6" CEDAR, MARKED "X", BT TAG, N48°E, 5.9 FEET TO SPIKE.

**FILED**  
Date: 4-15-2019 By: [Signature]  
This survey consists of:  
Map: CS. 65/103-4  
Narrative: \_\_\_\_\_  
Corner Rpt: \_\_\_\_\_

**DOUGLAS COUNTY  
SURVEYOR**

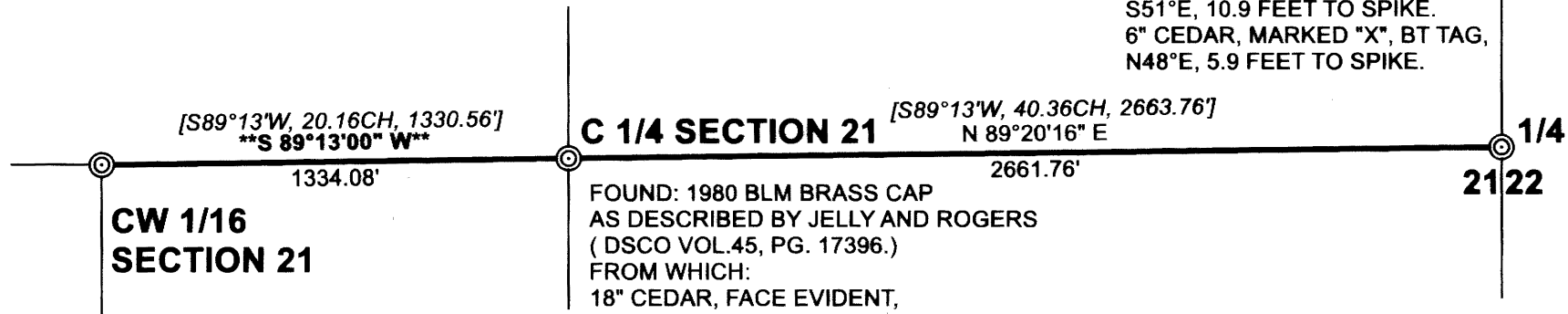

**FOUND:** 1980 BLM BRASS CAP AS DESCRIBED BY JELLY AND ROGERS ( DSCO VOL.45, PG. 17396.) FROM WHICH:  
12" FIR, MARKED "X", BLM TAG, UNRECORDED BT, BEARS; S 81°W, 9.0 FEET TO CENTER.  
20" FIR, FACE EVIDENT, BT TAG, 1980 BT, S9 1/2°E, 38.3 FEET TO CENTER..

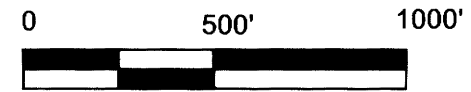

**FOUND:** 1980 BLM BRASS CAP AS DESCRIBED BY JELLY AND ROGERS ( DSCO VOL.45, PG. 17396.) FROM WHICH:  
18" CEDAR, FACE EVIDENT, BEARS; N 22°E, 8.6 FEET TO CENTER.  
**NEW BTS:**  
12" FIR, MARKED "X", BT TAG, S54°E, 16.3 FEET TO SPIKE.  
12" FIR, MARKED "X", BT TAG, S32°E, 16.0 FEET TO SPIKE.  
6" CEDAR, MARKED "X", BT TAG, N48°E, 5.9 FEET TO SPIKE.

\*\*BASIS OF BEARING: ASSUMED FROM 1980 BLM SURVEY\*\*



19 WEYCO BENNETT ROCK.TRV

**LEGEND**

-  CORNER FOUND
-  LINE MARKED

[S89°13'W, 20.16CH, 1330.56'] SURVEY RECORD: 1980 BLM

**REGISTERED  
PROFESSIONAL  
LAND SURVEYOR**

*[Signature]*

**OREGON  
TONY HOSTETTER**  
January 19, 1982  
LICENSE #1975

EXPIRES: 6/30/19

C.S. FILE 65/103-4