

FILED

Date: 8-7-2019 By: JC

This survey consists of:

Map: _____

Narrative: _____

Corner Rpt: CS 65/102-67

CORNER REPORT FORM

Section 4 Township 3/S Range 3W
Douglas County Date:
PLSS Number 400640

DOUGLAS COUNTY
SURVEYOR

CORNER DESIGNATION

1/4 COR S4/S3



Condition Report only
Not Found
Renewed
Unrecorded
Surveyed In
Referenced out

Previous Renewals/Surveys, etc:

MARKHAM 1960 CS 42/392 DCSD 1966 CS 52/63
BLM Dependent Resurvey 2006 V 55 PG 21618 Hostetter
Monument(s) & Accessories Found: (Condition and Source) 2015 M 170-20

DCSD BRASS CAP

36" FIR SNAG S2E 140 FT NO MARKS

12" FIR STUMP N23°E 152 FT ROTTED KACE

20" FIR STUMP N40°E 112 FT NO MARKS

2" ALUM CAP S42°E 75 FT

2" ALUM CAP S46°W 74 FT

DOWN 8" D FIR S32°W 175 FT VIS SCRIBES

Monument Detail

Sketch

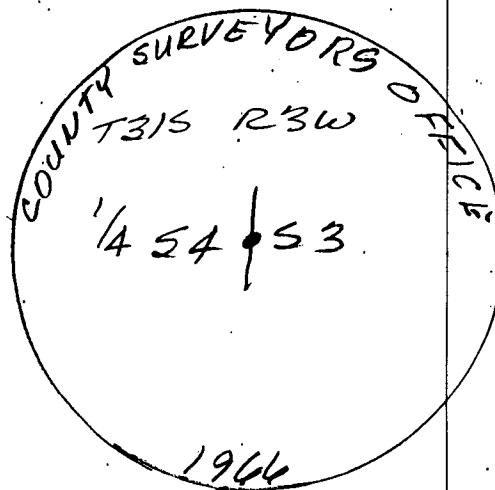

Monument Set (Procedures and Description)

New Accessories

5' ALUM POST N 5° FT

5' ALUM POST W 5° FT

Surveyor's Seal

Location & Comments

Compass Declination 15 1/2° E
Firm/Agency: I.e. Engineering, Inc.
Address: 809 SE Pine St., Roseburg, OR 97470

Party Chief: N. Fromdahl

Notes:

Witness: J. Ogden

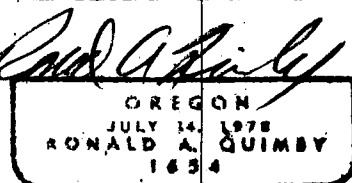
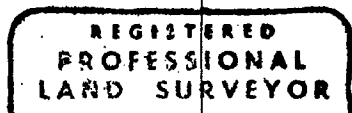

EXP 12-31-20

C.S. File 65/102-67