

FILED

Date: 5/15/2019 By: JC

This survey consists of:

Map: _____

Narrative: _____

Corner Rpt: CS 65/102-51

DOUGLAS COUNTY SURVEYOR

CORNER REPORT FORM

Section 2 Township 24S Range 8W

Douglas County

Date: 5-2019

PLSS Number
600760

CORNER DESIGNATION

See Cor 2/1



Condition Report only
Not Found
Renewed
Unrecorded
Surveyed In
Referenced out

Previous Renewals/Surveys, etc:

DCSO 1964 CS 49/49

BLM RESURVEY 2005 10/57 PG. 22404

Monument(s) & Accessories Found: (Condition and Source)

DCSO BRASS CAP

33" FIR STUMP S38 1/4° W 34' Vis Scribe

14" FIR S45 1/2° E 25' FT Vis Scribe

9" FIR S73° W 9' FT Vis Scribe

14" DOWN FIR S79 1/4° E 21' Vis. Scribe

Monument Detail

Sketch

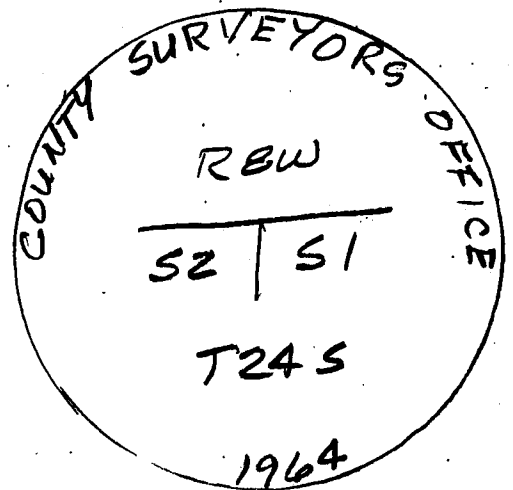

Monument Set (Procedures and Description)

New Accessories

13" D. FIR S11° W 27' FT Scribed T24S RBW S2 BT
Steel Post 2' west & 2' south

Surveyor's Seal

Location & Comments

Compass Declination 15 1/2° E

Firm/Agency: I.e. Engineering, Inc.

Address: 809 SE Pine St., Roseburg, OR 97470

Party Chief: N. From Dahl

Notes:

Witness: J. OGDEN

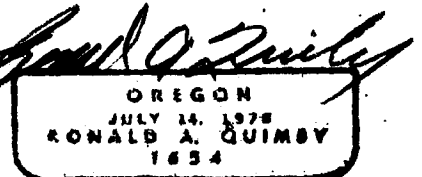
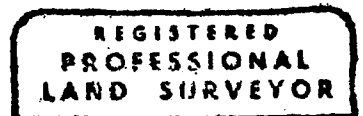

EXP 12-31-20
C.S. File 05/102-51