

CORNER REPORT FORM

Section 23 Township 23S Range 8W
Douglas County Date
PLSS Number 600340 4-2019

FILED
Date: 5/14/2019 By: X
This survey consists of:
Map: _____
Narrative: _____
Corner Rpt: C5102-43

DOUGLAS COUNTY
SURVEYOR

CORNER DESIGNATION

1/4 000 S23/S24



Condition Report only
Not Found
Renewed
Unrecorded
Surveyed In
Referenced out

Previous Renewals/Surveys, etc:

BYRON 1960 CS 52/57 DCSO 1967 CS 54/12-24A
BLM RESURVEY 2015 Vol 58 PG. 23402 Roberts 1981 M86-64
Monument(s) & Accessories Found: (Condition and Source)

DCSO BRASS CAP
14" FIR N22°E 29' FT PARTIALLY HEALED BLAZE
14" FIR N9 1/2° W 22' FT " " "

Monument Detail

Sketch

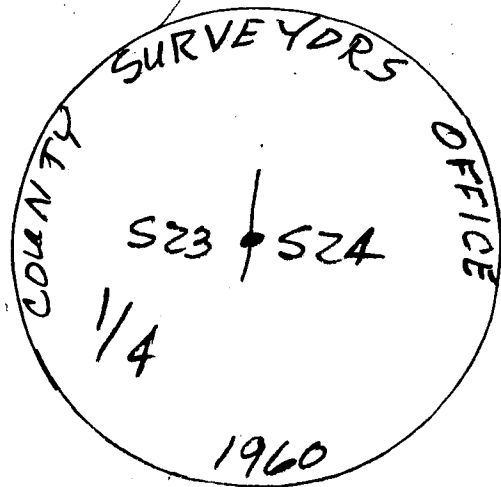

Monument Set (Procedures and Description)

New Accessories

6' ALUM POST 5' FT WEST
6' ALUM POST 5' FT EAST

Surveyor's Seal

Location & Comments

Compass Declination 15 1/2° E
Firm/Agency: I.e. Engineering, Inc.
Address: 809 SE Pine St., Roseburg, OR 97470

Party Chief: N. Fromm

Notes:

Witness: R. Heichel

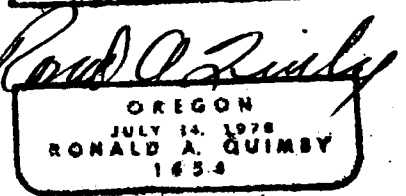
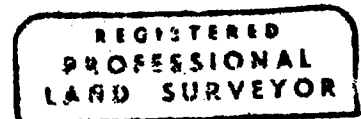

EXP 12-31-20

C.S. File 65/102-43