

FILED

Date: 4/16/2019 By: JC

This survey consists of:

Map: _____

Narrative: _____

Corner Rpt: C565 | 102-35

DOUGLAS COUNTY SURVEYOR

CORNER REPORT FORM

Section 25 Township 23S Range 8W
Douglas County Date 4-2019
PLSS Number 600300

CORNER DESIGNATION

SEC COR 23/24
26/25

- Condition Report only
- Not Found
- Renewed
- Unrecorded
- Surveyed In
- Referenced out

Previous Renewals/Surveys, etc:

DCSO 1960 C552157 BLM Resurvey 1964 Vol 32 p713538-39
BLM Resurvey 1985 Vol 48 Pg. 18239-40 BLM Resurvey 2015 Vol
Monument(s) & Accessories Found: (Condition and Source) SB P9 23400

DCSO BRASS CAP

- 48" Rotted FIR STUMP N5E 50³ FT NO VIS. MARKS
- 30" D. FIR S25⁰E 24² FT GOOD SCAR
- 19" D. FIR N61⁰E 27³ FT GOOD SCAR
- 16" D. FIR S63⁰W 19⁸ FT GOOD SCAR
- DOWN 10" D. FIR N15⁰W 37⁸ FT GOOD SCAR

Monument Detail

Sketch

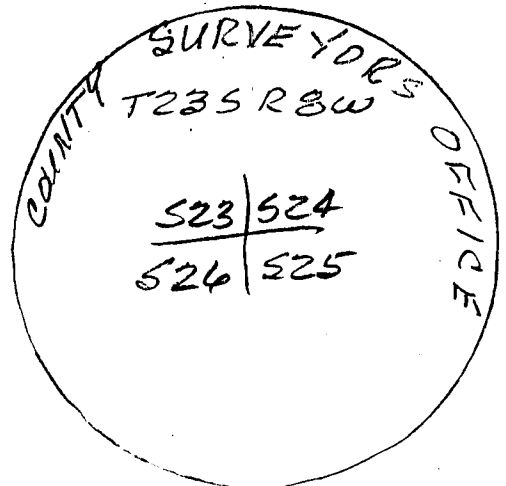

Monument Set (Procedures and Description)

New Accessories

1) 1" D. FIR N65⁰W 19⁰ FT SCRIBED SCT23 RB 523 BT

Surveyor's Seal

Location & Comments

Compass Declination 15 1/2⁰E
Firm/Agency: i.e. Engineering, Inc.
Address: 809 SE Pine St., Roseburg, OR 97470
Party Chief: R. VINCENT
Notes:
Witness: J. OBDEN

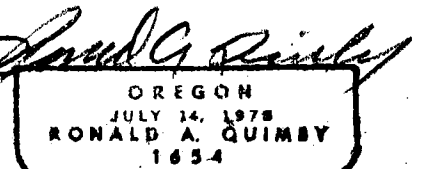
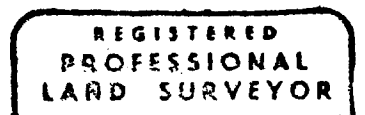

EXP 12-31-20

C.S. File 65/102-35