

OREGON CORNER RESTORATION FORM

SECTION 19 TOWNSHIP 20 S. RANGE 11W
COUNTY DOUGLAS DATE 2/1/2019 TRACT PERKINS CREEK
POINT IDENTIFIER 120360

CORNER DESIGNATION:

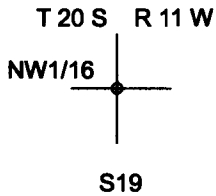

- CONDITION REPORT ONLY
- NOT FOUND
- RENEWED
- UNRECORDED
- SURVEYED IN
- REFERENCED OUT

FILED
Date: 4/16/2019 By: Jc
This survey consists of:
Map: _____
Narrative: _____
Corner Rpt: CS 65/102-25

PREVIOUS RENEWALS/SURVEYS, ETC:

NW1/16 CORNER FOR SECTION 19 WAS SET BY MINOR IN MAP M125-26.

DOUGLAS COUNTY SURVEYOR

ACCESSORIES FOUND: (CONDITION AND SOURCE)

26" 4 FT. TALL D. FIR STUMP BEARS N62°W 50.7 FT. AS PER RECORD BT TAG ON STUMP

20" 10 FT. TALL SPRUCE STUMP BEARS S5°E 43.1 FT. AS PER RECORD BT TAG ON STUMP

MONUMENT DETAIL:

SKETCH:
(NOT TO SCALE)

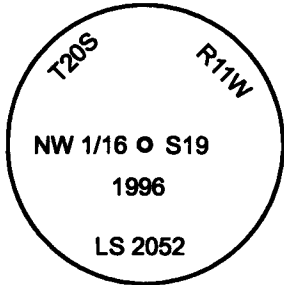

CONFEDERATED TRIBES OF THE SILETZ PROPERTY

JUNIPER PROPERTIES LIMITED PARTNERSHIP

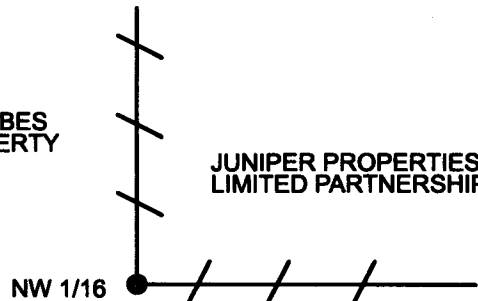

LEGEND:

● FND MINOR 1996 BRASS CAP PER MAP M125-26

/// LINES FLAGGED AND BLAZED FROM EXISTING BLAZES

FIA TIMBER GROWTH & VALUE PROPERTY

MONUMENT:

FOUND BRASS CAP SET BY MINOR IN MAP M125-26

NEW ACCESSORIES:

9" HEMLOCK BEARS WEST 6.7 FT. WE SCRIBE NW1/16 S19 BT AND TAG TREE

50" SPRUCE BEARS N18°E 19.2 FT. APPROX. 40 FT. TO FACE OF TREE

LOCATION & COMMENTS:

FOUND MINOR BCIP PER MAP M125-26 AT GROUND LEVEL

ON TOP OF FLAT RIDGE. CORNER LIES 6 TO 10 FT.

SOUTHEAST OF TWO LARGE DECAYED SPRUCE

STUMPS AND APPROX 20 FT. SOUTHEAST OF LARGE

SPRUCE TREE.

BEARING BASIS: MAGNETIC BEARING FROM

HAND COMPASS 16° E DECLINATION

FIRM/AGENCY: LONE ROCK TIMBER MANAGEMENT CO.

ADDRESS: P.O. BOX 1127

ROSEBURG, OR 97470

PARTY CHIEF: KEN W. HOFFINE

NOTES: GARY ANGIOLET

WITNESS: _____

REGISTERED
PROFESSIONAL
LAND SURVEYOR

Ken W Hoffine

OREGON
JULY 16, 1987
KEN W. HOFFINE
PLS 2291

C.S. FILE 65/102-25

EXPIRES 6-30-19