

FILED

Date: 4-9-2019 By: X

This survey consists of:

Map: _____

Narrative: _____

Corner Rpt: CS 65/102-16

DOUGLAS COUNTY
SURVEYOR

CORNER REPORT FORM

Section 2 Township 255 Range BW
Douglas County Date 4-2019
PLSS Number 500700

CORNER DESIGNATION

See COR 34/35
3/2

- Condition Report only
- Not Found
- Renewed
- Unrecorded
- Surveyed In
- Referenced out

Previous Renewals/Surveys, etc:

GLO SURVEY 1881 Vol 8 Pg 3302 GLO SURVEY 1893 Vol 8 Pg 3326

GLO SURVEY 1905 Vol 8 Pg 3343-54 A.R. EVANS 1956 CS 42/206

Monument(s) & Accessories Found: (Condition and Source)

DC60 1958 CS 49/84 BLM Resurvey 1959 Vol 30 Pg 12606-07

BLM Resurvey 1986 Vol 47 Pg 18120 D. EDWARDS 2005 M147-35

FD DC60 BRASS CAP
22" FIR N69 1/2° E 36 3/4 FT GOOD SCAR
Root hole N37 1/2° E 19 1/2 FT
36" FIR STUMP N35° W GOOD SCAR
46" CEDAR S28° W 16 5/8 FT GOOD SCAR

Monument Detail 6' steel Post West 2° FT

Sketch

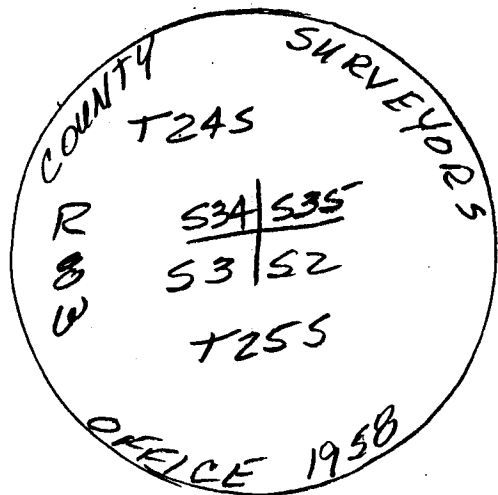

Monument Set (Procedures and Description)

New Accessories

6" D. FIR N12° W 50 3/4 FT scribed X

Surveyor's Seal

Location & Comments

Compass Declination 15 1/2° E
Firm/Agency: i.e. Engineering, Inc.
Address: 809 SE Pine St., Roseburg, OR 97470

Party Chief: N. From Dahl

Notes:

Witness: R. VINCENT

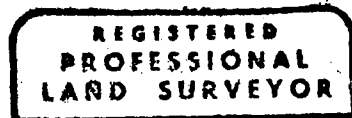

Ronald A. Quinby
 OREGON
 JULY 10 1978
 RONALD A. QUINBY
 1634

EXD 12/31/20
C.S. File CS 65/102-16