

FILED

Date: 10-11-2018 By: JC

This survey consists of:

Map: _____

Narrative: _____
Corner Rpt: CS 65/102-2

DOUGLAS COUNTY
SURVEYOR

CORNER REPORT FORM

Section 4 Township 30S Range 2W
Douglas County Date: 9-2018
PLSS Number
300640

CORNER DESIGNATION

1/4 COR 55/54

- Condition Report only
- Not Found
- Renewed
- Unrecorded
- Surveyed In
- Referenced out

Previous Renewals/Surveys, etc:

SHANER July 1960 CS File 51/105-1
DCSO 1976 CS 59/2-15

Monument(s) & Accessories Found: (Condition and Source)

- DCSO BRASS CAP
- 40" FIR stump (Rotted) with open face N69°E 8⁸ FT No Leg. Scribes
- 20" GRAND FIR S35°E 75³ FT GOOD SCAR
- 22" Hemlock S78°W 60² FT GOOD SCAR

Monument Detail

Sketch

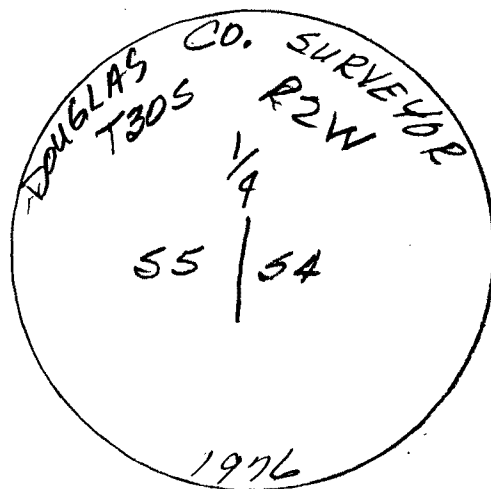

Monument Set (Procedures and Description)

New Accessories

- 10" W. FIR N18°E 18² FT Scribed 1/4 54 BY
- 5" FIR N30°W 22⁰ FT Scribed X

Surveyor's Seal

Location & Comments

Compass Declination 15 1/2° E
 Firm/Agency: i.e. Engineering, Inc.
 Address: 809 SE Pine St., Roseburg, OR 97470
 Party Chief: N. Fromm Dahl
 Notes:
 Witness: R. Heichel

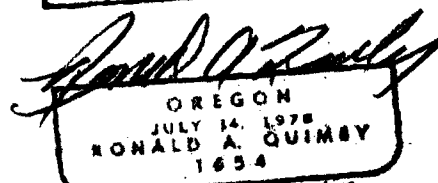
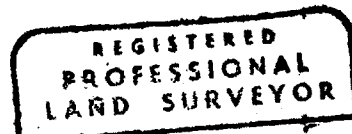

EXP 12-31-18

C.S. File 65/102-2