

OREGON CORNER RESTORATION FORM

SECTION 20 TOWNSHIP 22 S. RANGE 5W
COUNTY DOUGLAS DATE 9/12/2018 TRACT BALDY
POINT IDENTIFIER 200400

CORNER DESIGNATION:

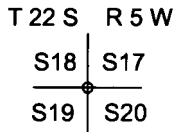

- CONDITION REPORT ONLY
- NOT FOUND
- RENEWED
- UNRECORDED
- SURVEYED IN
- REFERENCED OUT

FILED
Date: 9-24-2018 By: X
This survey consists of:
Map: _____
Narrative: _____
Corner Rpt: CS 65/101-60

PREVIOUS RENEWALS/SURVEYS, ETC.:

1988 COUNTY CORNER PER CS FILE 62/52, 1988 DEAN RENEWAL CS FILE 63/69, 1964 HAINES RENEWAL CS FILE 51/305, 1995 HOFFINE MAP M119-66, SWEEDEN . PLAT 1998-0049 EDWARDS 2005 MAP M149-22

DOUGLAS COUNTY SURVEYOR

ACCESSORIES FOUND: (CONDITION AND SOURCE)

17" OAK BEARS S6 1/4°W 235.3 FT. AS PER CS FILE 62/52 (WE DID NOT MEASURE) HEALED FACE AND COUNTY TAG

MONUMENT DETAIL:

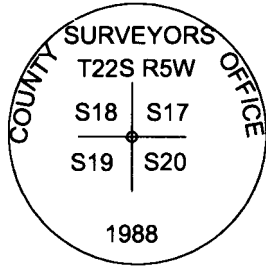

SKETCH:
(NOT TO SCALE)

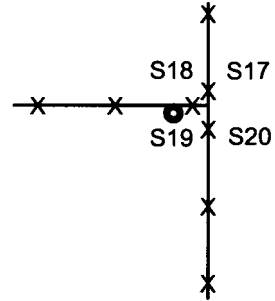

LEGEND:

- FOUND 1988 COUNTY BCIP
- EXISTING FENCE LINES

MONUMENT:

FOUND 1988 COUNTY BCIP AS PER CS FILE 62/52

NEW ACCESSORIES:

18" DOUGLAS FIR BEARS N61°E 36.4 FEET WE SCRIBE S17 BT AND TAG TREE
17" DOUGLAS FIR BEARS S88°W 20.9 FEET WE SCRIBE S19 BT AND TAG TREE

BEARING BASIS: RECORD BEARING FROM
HAND COMPASS 16° DECLINATION

LOCATION & COMMENTS:

IN THE COURSE OF VISITING THE NW CORNER OF SECTIONS 20. WE FIND 1988 COUNTY BCIP 0.2 FEET ABOVE GROUND LEVEL. A NORTH SOUTH FENCE LINE BEARS APPROX. 4 FEET EAST OF CORNER. A WESTERLY RUNNING FENCE LINE BEARS APPROX. 0.5 FEET NORTH OF CORNER. THERE IS A U-POST APPROX. 1.5 FEET SOUTH OF CORNER MONUMENT AND A 4" ROUND TREATED POST OF "H" BRACE BEARS N60°W 1.5 FEET.

FIRM/AGENCY: LONE ROCK TIMBER MANAGEMENT CO.
ADDRESS: P.O. BOX 1127
ROSEBURG, OR 97470
PARTY CHIEF: KEN W. HOFFINE
NOTES: GARY ANGIOLET
WITNESS: IGNACIO ROMAN

REGISTERED
PROFESSIONAL
LAND SURVEYOR

Ken W Hoffine

OREGON
JULY 16, 1987
KEN W. HOFFINE
PLS 2291

C.S. FILE 65/101-60

EXPIRES 6-30-19