

OREGON CORNER RESTORATION FORM

SECTION 33 TOWNSHIP 21 S. RANGE 4 W
COUNTY DOUGLAS DATE 5/4/2017 TRACT SUMMERWOOD
POINT IDENTIFIER 340140 320140

CORNER DESIGNATION:

T 21 S R 4 W
W1/16
C — o — C
S33

_____ CONDITION REPORT ONLY
_____ NOT FOUND
_____ X _____ RENEWED
_____ UNRECORDED
_____ SURVEYED IN
_____ REFERENCED OUT

PREVIOUS RENEWALS/SURVEYS, ETC.:

CW1/16 CORNER WAS SET BY WELLMAN IN MAP M132-12, WELLMAN MAP M133-46, INMAN MAP M146-54,
PARTITION PLAT 2000-0049A

ACCESSORIES FOUND: (CONDITION AND SOURCE)

35" DOUG FIR BEARS N79°E 40.5 FT. AS PER RECORD HEALED FACE AND TAG

31" DOUG FIR BEARS N29 1/2°W 28.0 FT. AS PER RECORD HEALED FACE AND TAG

MONUMENT DETAIL:

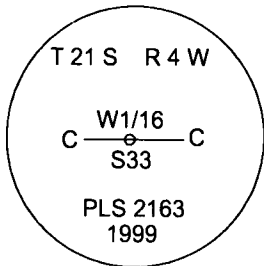

SKETCH:
(NOT TO SCALE)

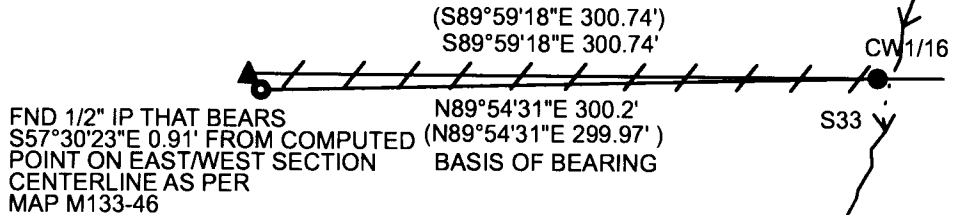

FND 1/2" IP THAT BEARS
S57°30'23"E 0.91' FROM COMPUTED
POINT ON EAST/WEST SECTION
CENTERLINE AS PER
MAP M133-46

LEGEND:

- / — LINES BLAZED, PAINTED AND TAGGED
- FND 1999 WELLMAN BRASS CAP PER M132-12
- FND IRON PIPE SET IN M12-8
- ▲ COMPUTED POINT ON EAST/WEST CENTERLINE S33 AS PER M133-46
- () RECORD FROM MAP M133-46

MONUMENT:

FOUND 1999 WELLMAN 2 1/2" IRON PIPE WITH 2 1/2" BRASS CAP, 0.7' ABOVE GROUND LEVEL, PER M132-12.
CORNER LIES ON STEEP EAST FACING SLOPE ABOVE A DRAW.

NEW ACCESSORIES:

SET IR WITH PLASTIC ORANGE CAP MARKED PLS 2291 FLUSH WITH THE GROUND BEARS N55°W 1.18'.
SET IR WITH PLASTIC ORANGE CAP MARKED PLS 2291 FLUSH WITH THE GROUND BEARS S37°W, 1.94'.
SET IR WITH PLASTIC ORANGE CAP MARKED PLS 2291 FLUSH WITH THE GROUND BEARS S34°E 1.79'.
ALL ACCESSORIES HAVE A MAGNETIC BASIS OF BEARING.

LOCATION & COMMENTS:

THE PURPOSE OF THIS RENEWAL IS TO ESTABLISH 3 IRON
REFERENCE RODS AND TIE IN EXISTING REFERENCES TO
REESTABLISH THE CW 1/16 CORNER AND PROTECT FROM
POSSIBLE DISTURANCE DURING LOGGING OPERATIONS.
WE RAN A RANDOM TRAVERSE BEGINNING AT THE
CW 1/16 TRAVERSING WESTERLY TO IRON PIPE, AS PER
M133-46, 0.91' S57°30'23"E FROM SECTION 33 CENTERLINE.
WE CALCULATE A COMPUTED POINT ON THE EAST/WEST
CENTERLINE AND MARKED THE CENTERLINE WITH BLAZE AND PAINT
EAST TO CW1/16 CORNER.

BEARING BASIS: SOLAR FROM BLM 1980
M132-12 AND M133-46
FIRM/AGENCY: LONE ROCK TIMBER MANAGEMENT CO.
ADDRESS: P.O. BOX 1127
ROSEBURG, OR 97470
PARTY CHIEF: KEN W. HOFFINE
NOTES: GARY ANGIOLET
WITNESS: IGNACIO ROMAN

FILED
Date: 7/24/2018 By: jc
This survey consists of:
Map:
Narrative:
Corner Rpt: CS/101-48

REGISTERED
PROFESSIONAL
LAND SURVEYOR
Ken W Hoffine
OREGON
JULY 16, 1987
KEN W. HOFFINE
2291

DOUGLAS COUNTY
SURVEYOR

EXPIRES 6-30-19

C.S. FILE 65/101-48