

FILED

Date: 7-18-2018 By: JC

This survey consists of:

Map: \_\_\_\_\_

Narrative: \_\_\_\_\_

Corner Rpt: CS 65/101-38

CORNER REPORT FORM

34, 35

31S 07W

Section 3, 2 Township 32S Range 07W

Douglas County Date 02/20/2018

PLSS Number 500700

DOUGLAS COUNTY  
SURVEYOR

CORNER DESIGNATION

T31S, R7W

S34 | S35

S3 | S2

T32S, R7W

- \_\_\_ Condition Report only
- \_\_\_ Not Found
- \_\_\_ Renewed
- \_\_\_ Unrecorded
- \_\_\_ Surveyed In
- \_\_\_ Referenced out

Previous Renewals/Surveys, etc:

May 1962 Howard Johnstone renewal for Roseburg Forest Products, C.S. 51/163 Oct.

1963/June 1964 BLM renewal, Pgs. 13618-9,

Sept. 1964 DCSP0 renewal C.S.49/109

Monument(s) & Accessories Found: (Condition and Source)

Found 2-1/2" iron pipe with 2-1/2" brass cap at Witness Corner from which a:

- 9" (now 25") D. fir with healed face bears S1°E 20.4'
- 10" (now 19") Cedar with healed face bears S15°W 31.2'
- 11" (now 13") Laurel with scribing visible in a partially healed face bears N51°E 15.0'

2-1/2" iron pipe 1' below surface of gravel road (Cap has been removed) bears

- N1° W 100.5' from Witness Corner. From iron pipe a:
- 12" (now 25") D. fir with healed face bears N37°E 51.7' (DCSO N36°E 53.6')
- 14" (now 22") D. fir with healed face bears S78°W 64.8'

Monument Detail



Sketch



Monument Set (Procedures and Description)

New Accessories

from Witness Corner a:

- 11" D. fir scribed "WC T31S R7W S34 BT" bears N23°W 19.8'

Location & Comments

OREGON COORDINATE  
REFERENCE SYSTEM,  
COTTAGE GROVE -  
CANYONVILLE ZONE,  
NAD 88-(2011),  
EPOCH 2010 PER GPS  
OBSERVATION HOLDING NGS  
CORS STATIONS "RSBG" & "DDSN"  
Lat. N43°09'31.9061"  
Long. W123°37'48.3865"

Compass Declination 16°  
Firm/Agency: Land Mark Surveying, Inc.  
Address: P.O. Box 13  
Roseburg, OR 97470  
Party Chief: Bartt Heichel  
Notes: \_\_\_\_\_  
Witness: Anthony Welch

Surveyor's Seal

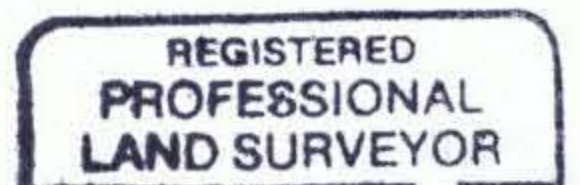

*Mark A. Heimbarger*  
OREGON  
JULY 18, 1987  
MARK A. HEIMBURGER  
2287

*Renews 6/30/19*

*CS File 65/101-38*