

FILED

Date: 7/11/2018 By: X

This survey consists of:

Map: \_\_\_\_\_

Narrative: \_\_\_\_\_

Corner Rpt: CS 65/101-22

DOUGLAS COUNTY SURVEYOR

CORNER REPORT FORM

Section 36 Township 29S Range 3W  
Douglas County Date 1-2018  
PLSS Number 600200

CORNER DESIGNATION

SEC COR 26/25  
35/36

- Condition Report only
- Not Found
- Renewed
- Unrecorded
- Surveyed In
- Referenced out

Previous Renewals/Surveys, etc:

MARKMAN 1959 CS 42/315 BLM RESURVEY 2007 Vol 57 Pg 22553-4  
DCSO 1973 CS 56/41  
BLM DEPENDANT RESURVEY 2002/2003 Vol 55 Pg 21319-20  
Monument(s) & Accessories Found: (Condition and Source) EDWARDS 3/2017 M173-15

DCSO BRASS CAP

14" FIR N 9 1/2° E 23 1/2 FT GOOD SCAR  
16" FIR S 17 1/2° E 112 FT GOOD SCAR  
18" FIR S 31 1/2° W 27 3/4 FT GOOD SCAR  
14" FIR N 63° W 9 1/4 FT (REC N 62 3/4° W) GOOD SCAR

41" X 7" TALL FIR STUMP N 75° E 122 FT GOOD SCAR  
31" X 6" TALL DECAYED STUMP S 70° E 44 1/2 FT (REC 16 3/4° E) PREV. OPENED  
26" X 3" TALL FIR STUMP S 41° W 14 1/2 VIS. SCRIBES

Monument Detail 3" IRON PIPE S 64 1/2° E 3 5/8 FT Sketch

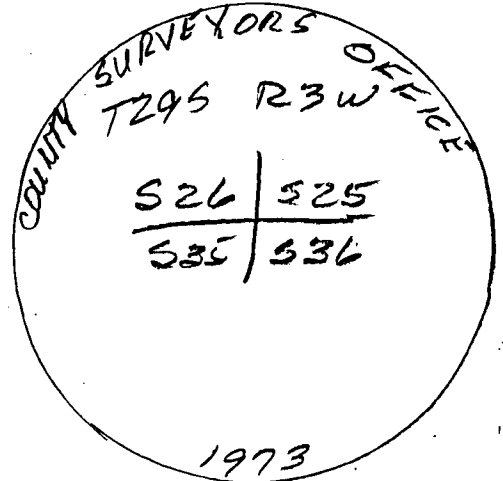

Monument Set (Procedures and Description)

New Accessories

Surveyor's Seal

Location & Comments

CORNER IS APPROX 75' SOUTH OF A GRAVEL ROAD

Compass Declination 15 1/2° E  
Firm/Agency: i.e. Engineering, Inc.  
Address: 809 SE Pine St., Roseburg, OR 97470

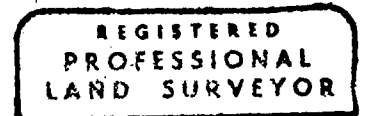

Party Chief: N From Dahl  
Notes:  
Witness: R. Heichel & R. VINCENT

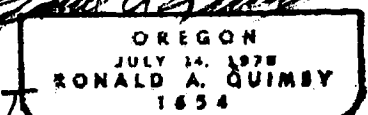

C.S. File 65/101-22