

FILED

Date: 7-11-2018 By: JC

This survey consists of:

Map: _____

Narrative: _____
Corner Rpt: CS 65/10-20

DOUGLAS COUNTY
SURVEYOR

CORNER REPORT FORM

Section 36 Township 29S Range 3W
Douglas County Date 1/2018
PLSS Number 640200

CORNER DESIGNATION

1/4 COR 25
36

- Condition Report only
- Not Found
- Renewed
- Unrecorded
- Surveyed In
- Referenced out

Previous Renewals/Surveys, etc:

DCSD 1958 CS 49/47 BLM Dependent Resurvey 2003 V55
MARKHAM 1959 CS 42/315 PG 21321-2

Monument(s) & Accessories Found: (Condition and Source)

2 1/2" DCSD BRASS CAP
12" FIR 58 1/2° E 11.5 FT GOOD SCAR
8" FIR SNA9 10' TAIL N39° E 12.6 FT GOOD SCAR
32" FIR STUMP 55° W 19.8 FT GOOD SCAR
24" FIR STUMP N60° W 22.9 FT GOOD SCAR

Monument Detail

Sketch

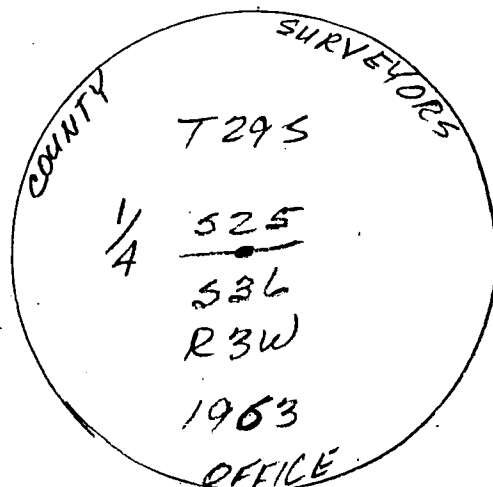

Monument Set (Procedures and Description)

New Accessories

14" FIR N73° E 32 1/2 FT Scribed 1/4 525 BT
18" FIR S56° W 33.9 FT Scribed 1/4 536 BT
22" FIR N45° W 3.9 FT Scribed 1/4 525 BT

Surveyor's Seal

Location & Comments

CORNER IS APPROX
210' EAST OF A
GRAVEL ROAD

Compass Declination 15 1/2° E
Firm/Agency: i.e. Engineering, Inc.
Address: 809 SE Pine St., Roseburg, OR 97470

Party Chief: N Fromdahl

Notes:

Witness: R. Heichel; R. VINCENT

REGISTERED
PROFESSIONAL
LAND SURVEYOR

Ronald A. Quimby
OREGON
JULY 14, 1978
RONALD A. QUIMBY
1634

EXP 12-31-18

C.S. File 65/10-20