

FILED

Date: 7-11-2018 By: JC

This survey consists of:

Map: _____

Narrative: _____

Corner Rpt: CS 65/101-15

CORNER REPORT FORM

Section 4 Township 27S Range 3W
Douglas County Date 12-2017
PLSS Number 400600

DOUGLAS COUNTY
SURVEYOR

CORNER DESIGNATION

SEC COR 4/3
9/10

- Condition Report only
- Not Found
- Renewed
- Unrecorded
- Surveyed In
- Referenced out

Previous Renewals/Surveys, etc:

DCSO 1957 CS 47/193
BLM Resurvey 1958 Vol 29 pg 12430-1
BLM Resurvey 2009 Vol 57 pg 22679-80

Monument(s) & Accessories Found: (Condition and Source)

BLM BRASS CAP DCSO BRASS CAP ALONGSIDE
14" D FIR N24°E 25' FT GOOD SCAR
26" FIR S69°E 139 FT GOOD SCAR
OTHER BT'S ARE GONE OR BLOWN DOWN

Monument Detail

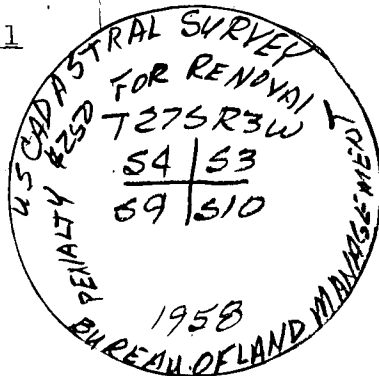

Sketch

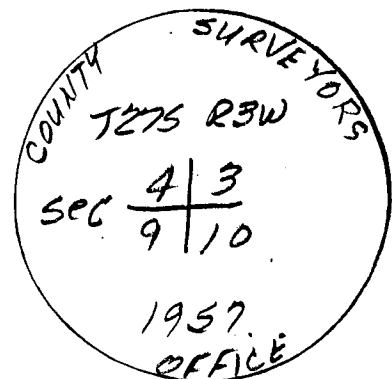

Monument Set (Procedures and Description)

New Accessories

steel Post 2° south
5" cedar N20°W 32' FT MARKED X chest HIGH

Location & Comments

Compass Declination 15 1/2° E
Firm/Agency: i.e. Engineering, Inc.
Address: 809 SE Pine St., Roseburg, OR 97470

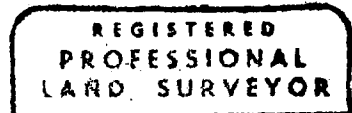

Party Chief: N FROM dahl
Notes:
Witness: R Heichel R. Vincent

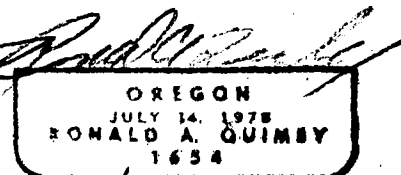

EXP 12-31-18

C.S. File 65/101-15