

FILED

Date: 1-24-2018 By: JC

This survey consists of:

Map: \_\_\_\_\_

Narrative: \_\_\_\_\_

Corner Rpt: CS 65/99-46

CORNER REPORT FORM

Section 22 Township 31S Range 7W  
Douglas County Date 10/2017  
PLSS Number 440400

DOUGLAS COUNTY  
SURVEYOR

CORNER DESIGNATION

1/4 COR 515  
522



Condition Report only  
Not Found  
Renewed  
Unrecorded  
Surveyed In  
Referenced out

Previous Renewals/Surveys, etc:

BLM Resurvey 1974 Vol 39 P9 15740

Monument(s) & Accessories Found: (Condition and Source)

BLM BRASS CAP ON 2 1/2" I. Pipe  
30" FIR S3E 62 FT (Healed FACE DEAD)  
18" FIR N22W 34 3/4 FT (Healed FACE DEAD)  
28" FIR N50E 73 FT VISIBLE Scribes (NO RECORD)

Monument Detail



Sketch

Monument Set (Procedures and Description)

New Accessories

32" MADRONA S82E 32 FT scribed 1/4 522 BT  
26" MADRONA N19E 18 FT scribed 1/4 515 BT  
5" I. Rod with yellow plastic cap S67W 17 FT Post along side  
10 5/8" I. Rod with yellow plastic cap N43W 12 FT Post along side

Surveyor's Seal

Location & Comments

AREA Badly  
Burnt 9/2017

Compass Declination 15 1/2° E  
Firm/Agency: i.e. Engineering, Inc.  
Address: 809 SE Pine St., Roseburg, OR 97470

Party Chief: J. LEONARD

Notes:

Witness: R. OLSEN

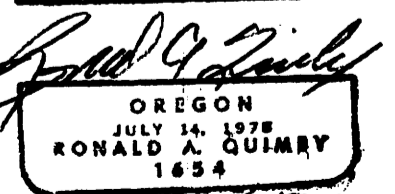
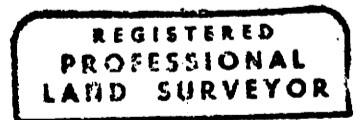

EXP 12-31-18

C.S. File 65/99-46