

FILED

Date: 1-18-2018 By: X

This survey consists of:

Map: _____

Narrative: _____
Corner Rpt: CS 65/99-45

DOUGLAS COUNTY
SURVEYOR

CORNER REPORT FORM

Section 14 Township 31S Range 7W
Douglas County Date 12-2017
PLSS Number
600440

CORNER DESIGNATION

1/4 COR S14/S13



Condition Report only
Not Found
Renewed
Unrecorded
Surveyed In
Referenced out

Previous Renewals/Surveys, etc:

DCSO 1966 CS File 54/36-B
BLM RESURVEY 1969 Vol 35 PG. 14501-02

Monument(s) & Accessories Found: (Condition and Source)

DBSO 2 1/2" BRASS CAP
50" BURNT FIR STUMP N50E 12E FT (NO MARKS)
45" BURNT FIR STUMP S45W 34E FT (NO MARKS)
14" BURNT FIR STUMP S15E 22' SCAR
29" BURNT FIR STUMP N8 1/4 W 35' SCAR

Monument Detail

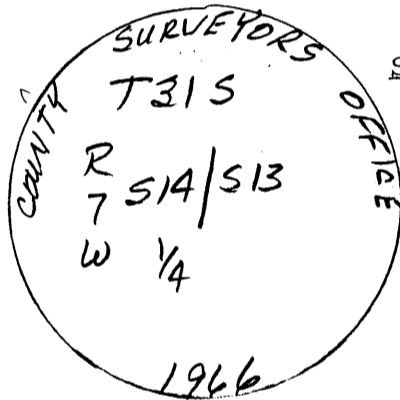

Sketch

Monument Set (Procedures and Description)

New Accessories

8" FIR N30W 8E FT Scribed 1/4 S14 BT
6" FIR N36E 90 FT Scribed 1/4 S13 BT
6" FIR S17W 18E FT Scribed 1/4 S14 BT
5" FIR S22E 16E FT Scribed 1/4 S13 BT

Surveyor's Seal

Location & Comments

CORNER IS APPROX
300' EAST OF SMALL
CREEK THAT FLOWS
NORTH
AREA BADLY BURNT
9-2017

Compass Declination 15 1/2 E
Firm/Agency: i.e. Engineering, Inc.
Address: 809 SE Pine St., Roseburg, OR 97470

Party Chief: J. LEONARD

Notes:
Witness: R. OLSEN

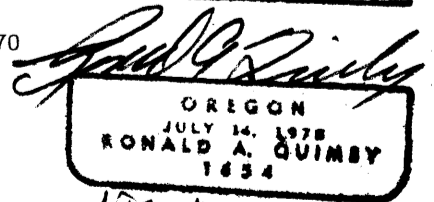
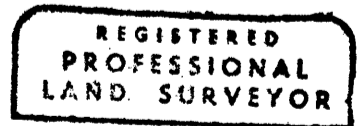

EX 12-31-18

C.S. File 65/99-45