

FILED

Date: 1-18-2018 By: X

This survey consists of:

Map: \_\_\_\_\_

Narrative: \_\_\_\_\_  
Corner Rpt: LS65/99-40

DOUGLAS COUNTY  
SURVEYOR

CORNER REPORT FORM

Section 10 Township 31S Range 7W  
Douglas County Date 12-2017  
PLSS Number 440600

CORNER DESIGNATION

1/4 COR 3/10

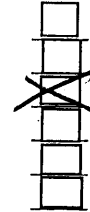

Condition Report only  
Not Found  
Renewed  
Unrecorded  
Surveyed In  
Referenced out

Previous Renewals/Surveys, etc:

DCSD 1974 CS File 86151  
BLM RESURVEY 1974 V39 PG 15744-45  
BLM RESURVEY 1979 V42 PG 12556

Monument(s) & Accessories Found: (Condition and Source)

DCSD 2 1/2" BRASS CAP  
16" FIR SNAQ N68E 6 3/4 FEET GOOD SCAR  
18" FIR SNAQ S42E 17 3/4 FT GOOD SCAR

Monument Detail

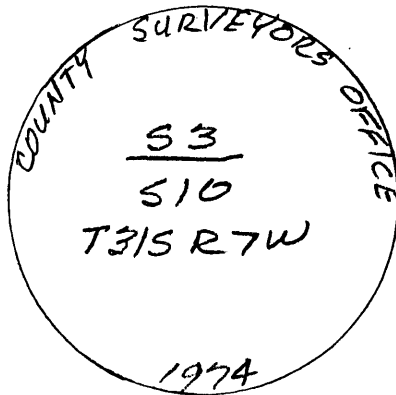

Sketch

Monument Set (Procedures and Description)

New Accessories

26" FIR NORTH 48 3/4 FT BARK Scribed 1/4 S3 BT  
38" FIR N144E 66 1/2 FT Scribed 1/4 S3 BT  
5/8" I. Rod with yellow Plastic CAP S33E 140 FT Post Alongside  
1 1/8" I. Rod with yellow Plastic CAP S320W 150 FT Post Alongside  
Surveyor's Seal

Location & Comments

CORNER IS APPROX  
150' West of Rd  
31-7-10.3  
AREA BADLY BURNED  
9-2017

Compass Declination 15 1/2 E  
Firm/Agency: i.e. Engineering, Inc.  
Address: 809 SE Pine St., Roseburg, OR 97470  
Party Chief: N. Fromdahl  
Notes:  
Witness: R. Heichel

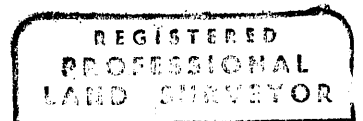

*Ronald A. Quimby*  
OREGON  
JULY 14, 1978  
RONALD A. QUIMBY  
1954

EXP 12-31-18

C.S. File 65/99-40